



60 Haverhill Grove

Wombwell, Barnsley, S73 0DH

Offers Over £80,000



Beecroft Estates are acting in the sale of the above property and have received an offer of £80,000 on the above property. Any interested parties must submit any higher offers in writing to the selling agent before exchange of contracts takes place.

Nest or Invest!!!! Situated on a well-presented and popular residential estate in Wombwell, this modern two bedroom first-floor apartment offers stylish open-plan living and excellent convenience for both homeowners and investors. The property benefits from a secure communal entrance with intercom, a bright open-plan living/kitchen/diner, two bedrooms, en-suite and bathroom, together with secure gated residents' parking. Ideally located close to Wombwell town centre, the train station, local shops and amenities, as well as excellent road links to Barnsley, the Dearne Valley and the M1 motorway network, the area also enjoys access to green spaces and strong rental demand. An early viewing is highly recommended to avoid disappointment. Awaiting management fees.



Entrance Hallway
 Lounge/Diner
 Master Bedroom
 En-Suite
 Bedroom Two
 Bathroom
 Exterior

Area Map



Floor Plans

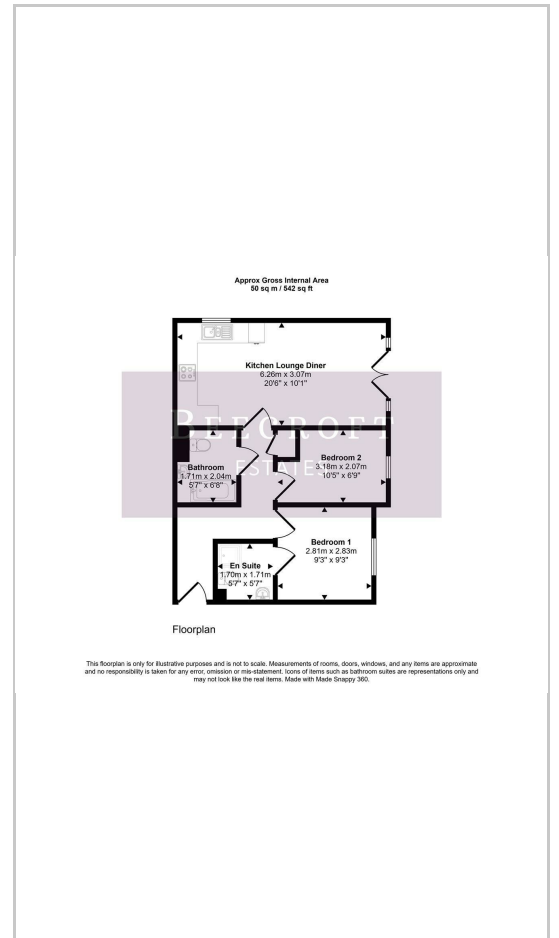

Energy Efficiency Graph

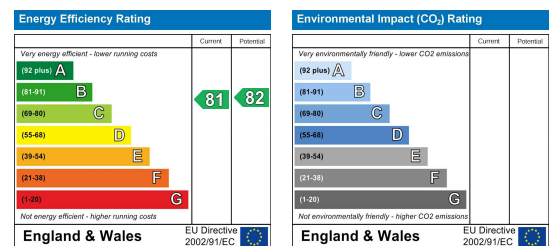

These particulars, whilst believed to be accurate are set out as a general outline only for guidance and do not constitute any part of an offer or contract. Intending purchasers should not rely on them as statements of representation of fact, but must satisfy themselves by inspection or otherwise as to their accuracy. No person in this firm's employment has the authority to make or give any representation or warranty in respect of the property.

Wombwell 6-8 Park Street, Wombwell, S73 0DJ
 Tel: 01226 340110 Email: info@beecroftstates.co.uk www.beecroftstates.co.uk