



Webbs
Helping people move since 1994

Eaton Drive | Rugeley | WS15 2FR

£186,000

 Webbs
estate agents

Summary

**** POPULAR LOCATION ** IDEAL FOR FIRST TIME BUYERS ** DECEPTIVELY SPACIOUS ** TWO BEDROOMS ** WELL PRESENTED THROUGHOUT ** OFF ROAD PARKING ** REAR GARDEN ** CLOSE TO AMENITIES ** WITHIN CHANCEL CATCHMENT ** VIEWING ESSENTIAL ****

WEBBS ESTATE AGENTS are pleased to market this well presented, two bedroom, mid terraced home, located in a popular area of Rugeley, on Eaton Drive. Viewing of the property is advised to fully appreciate not only the size and space on offer, but also the finish the current owners have achieved. The property would be ideally suited to a first time buyer looking to get their foot on the property ladder. Located close to amenities, useful transport links, within Chancel catchment and a short distance to Cannock Chase AONB. The internal accommodation briefly comprises; open plan kitchen, living dining room, two bedrooms and a family bathroom. The property also benefits from a private rear garden and off road parking.

Key Features

- POPULAR LOCATION
- DECEPTIVELY SPACIOUS
- WELL PRESENTED THROUGHOUT
- REAR GARDEN
- WITHIN CHANCEL CATCHMENT
- IDEAL FOR FIRST TIME BUYERS
- TWO BEDROOMS
- OFF ROAD PARKING
- CLOSE TO AMENITIES
- VIEWING ESSENTIAL

Rooms and Dimensions

Living Room

18'5" x 10'1" (5.62 x 3.09)

Kitchen

13'4" x 10'2" (4.08 x 3.10)

Landing

Bedroom 1

11'9" x 10'7" (3.60 x 3.24)

Bedroom 2

13'4" x 7'0" (4.07 x 2.14)

Bathroom

6'8" x 6'11" (2.04 x 2.12)

Rear Garden

Identification Checks (R)





Webbs
Helping people move since 1994



Webbs
Helping people move since 1994



Webbs
Helping people move since 1994



Webbs
Helping people move since 1994



Webbs
Helping people move since 1994



Webbs
Helping people move since 1994

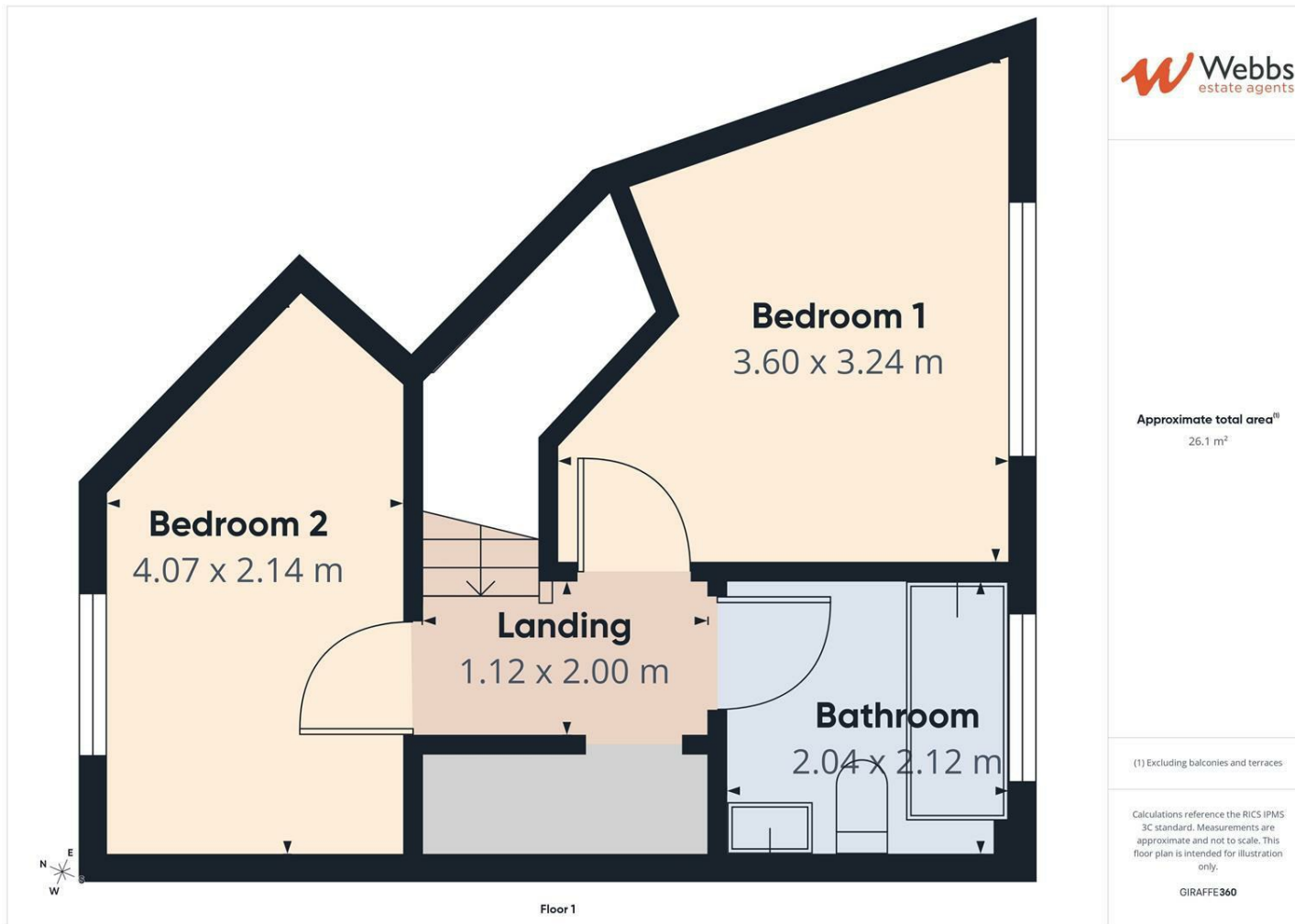

Webbs Estate Agents - endeavour to maintain accurate depictions of properties in Virtual Tours, Floor Plans and descriptions, however, these are intended only as a guide and purchasers must satisfy themselves by personal inspection.

