



Choumert Grove | London | SE15

£2,400 pcm

- Two double bedrooms
- Private garden
- Period features
- Separate kitchen and living room
- Unfurnished
- New double glazing
- Bellenden Village
- Peckham Rye
- Excellent bus routes
- Available immediately



A gorgeous double fronted, two bedroom Victorian home situated in the prestigious Bellenden Village area. Character and charm throughout with a large sunny back garden. This pretty house is well configured with separate kitchen and dining room as well as cosy living room, all neutrally decorated through out. Positioned perfectly for the excellent array of local independent amenities of Peckham Rye and Overground station. Available immediately and unfurnished



%epcGraph_c_1_300%

GROUND FLOOR
400 sq.ft. (37.1 sq.m.) approx.

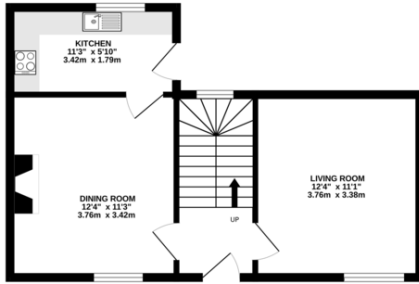

1ST FLOOR
335 sq.ft. (31.2 sq.m.) approx.

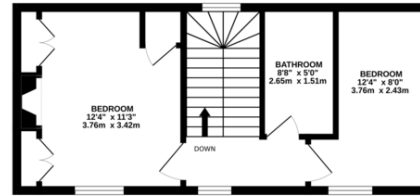

TOTAL FLOOR AREA: 735 sq.ft. (68.3 sq.m.) approx.

Whilst every attempt has been made to ensure the accuracy of the floorplan contained here, measurements of doors, windows, rooms and any other items are approximate and no responsibility is taken for any error, omission or mis-statement. This plan is for illustrative purposes only and should be used as such by any prospective purchaser. The services, systems and appliances shown have not been tested and no guarantee as to their operability or efficiency can be given.
Made with Metropix ©2025

Viewing Arrangements

Strictly by appointment

Contact Details

121 Denmark Hill

London

SE5 8EN

www.urbanvillagehomes.co.uk

lettings@urbanvillagehomes.com

020 3519 9121

Agents Note: Whilst every care has been taken to prepare these sales particulars, they are for guidance purposes only. All measurements are approximate and for general guidance purposes only and whilst every care has been taken to ensure their accuracy, they should not be relied upon and potential buyers are advised to recheck the measurements