

Cross Keys Estates

Opening doors to your future



79 Victory Street
Plymouth, PL2 2DA
Guide Price £170,000 Freehold



79 Victory Street, Plymouth, PL2 2DA

Guide Price £170,000 Freehold

** Guide Price £170,000 to £190,000 **

Cross Keys Estates is delighted to present this charming Victorian mid-terrace property located on Victory Street in the sought-after area of Keyham, Plymouth. This well-presented home boasts a delightful blend of modern comforts and classic features, making it an ideal choice for first-time buyers.

You will find a welcoming sitting room adorned with a lovely bay window that allows natural light to flood the space, creating a warm and inviting atmosphere. The property features a spacious dining room, complete with ample storage, perfect for family gatherings or entertaining friends. The stylish new modern fitted kitchen is a highlight, offering a contemporary space for culinary creativity.

- Victorian Mid Terrace Property
- Three Bright & Airy Bedrooms
- Sitting Room, Bay Window
- Spacious Dining Room
- Highly Popular Residential Area
- Well Presented Throughout
- New Modern Fitted Kitchen
- Private Rear Courtyard
- Ideal For First Time Buyers
- Early Viewing Advised, EPC - C69



Cross Keys Estates

As one of Plymouth's leading QUALIFIED estate agents for over two decades, we are proud to have been offering our multi award winning customer service since day one. If you are currently on the market or you are thinking of putting your property on the market, why not give us a call, you will not be disappointed. 98% of our clients recommend us to their friends and family and our results, when it comes to sales, are unrivalled.

Plymouth

Plymouth, Britain's Ocean City, is one of Europe's most vibrant waterfront cities. Located in one of the most beautiful locations imaginable, Plymouth is sandwiched between the incredible South West coastline and the wild beauty of Dartmoor National Park. Plymouth is 37 miles south-west of Exeter and 190 miles west-south-west of London, between the mouths of the rivers Plym to the east and Tamar to the west where they join Plymouth Sound to form the boundary with Cornwall, it is also home to one of the most natural harbours in the world. To the North of Plymouth is Dartmoor National Park, extending to over 300 square miles, which provides excellent recreational facilities.

The city is home to more than 260,000 people, making it the 30th most populated city in the United Kingdom and the second-largest city in the South West, after Bristol and has a full range of shopping, educational and sporting facilities. There is mainline train service to London (Paddington) and to Penzance in West Cornwall.

There's everything that you would expect to find in a cool, cultural city, with great shopping, arts and entertainment. But there's also hundreds of years of history to uncover, from Sir Francis Drake and the Spanish Armada to the Mayflower sailing in 1620, to a city rebuilt following the Blitz during World War II. With easy access to Exeter and its International Airport and a mainline train station giving direct access to London and a ferry port offering sea crossings to both France and Spain.

Plymouth is governed locally by Plymouth City Council and is represented nationally by three MPs. Plymouth's economy remains strongly influenced by shipbuilding and seafaring including ferry links to Brittany and Spain, but has tended toward a university economy since the early 2000's. It has the largest operational naval base in Western Europe - HMNB Devonport.

Keyham

Keyham is close to the Dockyard making this property ideal for Dockyard workers and is a Victorian/Edwardian built area. It was built to provide dense affordable housing just outside the wall of HM Dockyard Devonport for the thousands of civilian workmen. In the early-19th century, Devonport Dockyard was smaller than now; it was enlarged mid-century by Keyham Steam Yard - Keyham at that period was a suburb of Devonport itself. Keyham Steam Yard was one of the locations for the first trials of the Fairbairn patent crane. The Roman Catholic Church of Our Most Holy Redeemer was built in 1901 but was destroyed by fire following a bombing raid in 1941 and it was rebuilt in 1954. Parts of the southern end are now subject to massive redevelopment using a regeneration package. It has a railway station. Drake Primary School and Keyham Barton Primary Schools, educate 4 - 11-year-olds, with most secondary school children, attending Stoke Community College, Devonport High School for Boys or Marine Academy Plymouth (in King's Tamerton). College students, may attend Goschen Centre, or the Kings Road Centre.

More Property Information

The property comprises three bright bedrooms, providing plenty of room for relaxation and personalisation. The light and airy bathroom adds to the overall appeal, ensuring comfort and convenience for all residents.

Outside, the private rear courtyard offers a tranquil retreat, ideal for enjoying a morning coffee or hosting summer barbecues. The location is particularly advantageous, as it is close to local amenities, shops, and the dockyard, ensuring that everything you need is within easy reach. This delightful terraced house is a fantastic opportunity for those looking to establish themselves in a vibrant community. With its attractive features and prime location, this property is not to be missed.

Entrance Vestibule

Hallway

Sitting Room

10'10" x 10'5" (3.31m x 3.18m)

Dining Room

12'4" x 13'8" (3.76m x 4.16m)

Kitchen

9'5" x 6'3" (2.86m x 1.90m)

Utility

2'11" x 6'3" (0.90m x 1.90m)

Bathroom

Landing

Primary Bedroom

10'10" x 13'5" (3.30m x 4.10m)

Window to front, door to:

Bedroom 2

7'10" x 8'2" (2.40m x 2.50m)

Bedroom 3

9'7" x 5'3" (2.92m x 1.61m)

Courtyard

Cross Keys Estates Lettings Department

Cross Keys Estates also offer a professional, ARLA accredited Lettings and Management Service. If you are considering renting your property in order to purchase, are looking at buy to let or would like a free review of your current portfolio then please call our director Jack who is a fully qualified and award-winning letting agent on 01752 500018

Financial Services

Cross Keys Estates are proud to work in partnership with The Mortgage Lab, our whole of market mortgage specialists. With over 18 years industry experience, they are able to source the very best deal to meet their customers circumstances. Offering professional and friendly advice on residential and investment mortgages. Please get in touch to arrange a free, no obligation appointment to see how they can help you. Tel. 01752 255905, Email.sarah@themortgagelab.co.uk



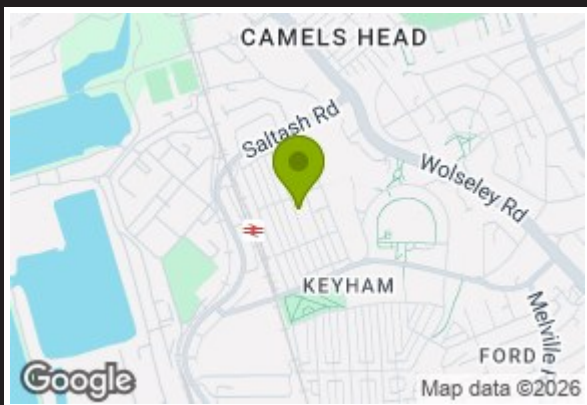
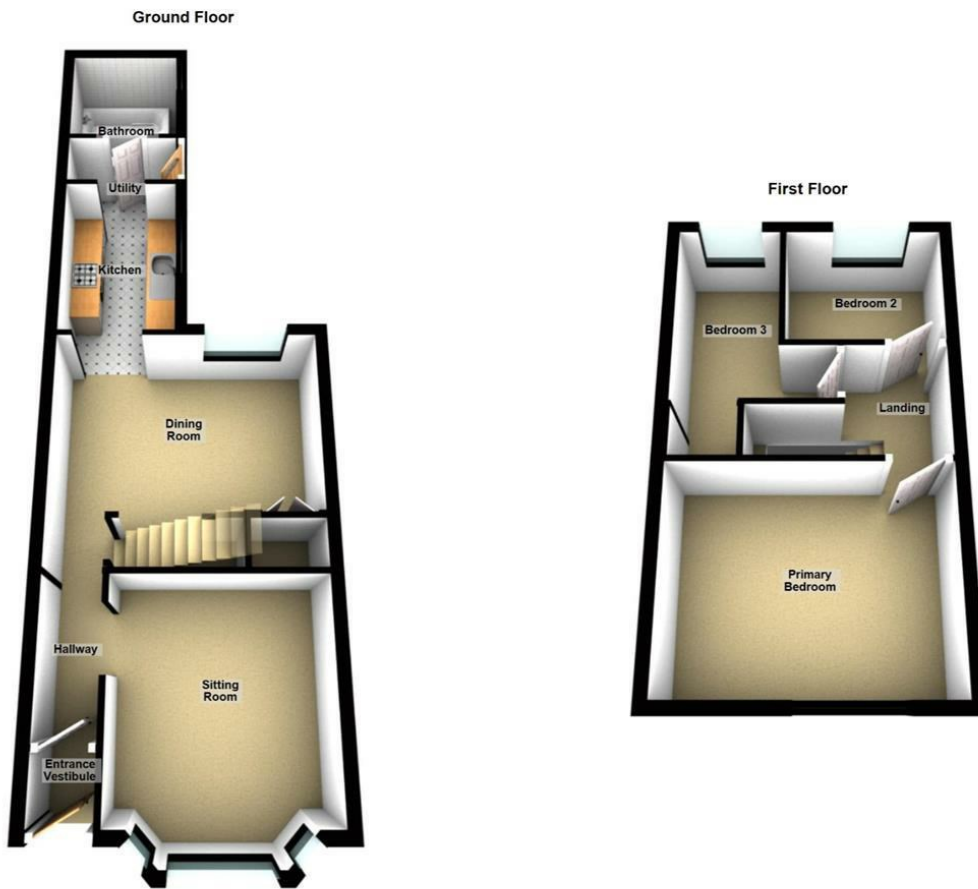

Energy Efficiency Rating		Current	Potential
Very energy efficient - lower running costs			
(92 plus) A			
(81-91) B			
(69-80) C			
(55-68) D			
(39-54) E			
(21-38) F			
(1-20) G			
Not energy efficient - higher running costs			
		69	81
England & Wales		EU Directive 2002/91/EC	

Environmental Impact (CO ₂) Rating		Current	Potential
Very environmentally friendly - lower CO ₂ emissions			
(92 plus) A			
(81-91) B			
(69-80) C			
(55-68) D			
(39-54) E			
(21-38) F			
(1-20) G			
Not environmentally friendly - higher CO ₂ emissions			
England & Wales		EU Directive 2002/91/EC	

VIEWINGS AND NEGOTIATIONS Strictly through the vendors agents, Cross Keys Estates MONEY LAUNDERING REGULATION 2003 AND PROCEEDS OF CRIME ACT 2002 Cross Keys Estates are fully committed to complying with The Money Laundering Regulations that have been introduced by the government. These regulations apply to everyone buying or selling a property, including companies, businesses and individuals within the United Kingdom or abroad. Should you either purchase or sell a property through this estate agents we will ask for information from you regarding your identity and proof of residence. We would ask for you to co-operate fully to ensure there is no delay in the sales/purchase process. IMPORTANT: we would like to inform prospective purchasers that these sales particulars have been prepared as a general guide only. A detailed survey has not been carried out, nor the services, appliances and fittings tested. Room sizes should not be relied upon for furnishing purposes and are approximate. If floor plans are included, they are for guidance only and illustration purposes only and may not be to scale. If there are any important matters likely to affect your decision to buy, please contact us before viewing the property.



Council Tax Band A



Cross Keys Estates
Opening doors to your future

Sales, Cross Keys House 51-53 Devonport Road,,
Stoke, Plymouth, Devon, PL3 4DL
Tel: 01752 500018 | sales@crosskeysestates.net
www.crosskeysestates.net