



Manor Gardens
London, W3

CHESTERTONS





This spacious terraced family house offers the purchasers the opportunity to update and create a fantastic family property, as well as the potential to extend the accommodation (STPP).

At present the property comprises of a wide front reception room, second reception room, and kitchen. Over the first floor there are three bedrooms and a large bathroom. There is also the use of a converted loft room.

Outside the property boasts a lawned rear garden extending to approx. 53ft, with the benefit of a garage at the rear.

Manor Gardens is located just off Gunnersbury Avenue, being close to The International School of London and the open spaces of Gunnersbury Park. It has excellent transport links via the A4 for routes into Central London and Heathrow. Chiswick High Road and Gunnersbury tube station are approximately 0.7 miles away (15 minutes' walk).

- Mid terrace house
- Three Bedrooms
- Two Reception Room
- Kitchen and Bathroom
- Large Rear Garden and Garage
- In need of modernisation

Asking Price £700,000

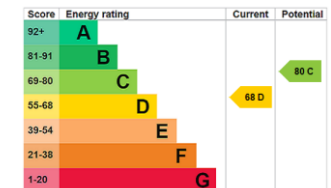

Tenure: Freehold
Service Charge: n/a
Ground Rent: n/a
Local Authority: London Borough of Hounslow
Council Tax Band: E

Chestertons Chiswick Sales

155 Chiswick High Road
 Chiswick
 London
 W4 2DT
 chiswick@chestertons.co.uk
 020 8995 3443

Manor Gardens, W3
 Approximate gross internal area
132.92 sq m / 1431 sq ft
 (Including Eaves Storage, Garage & Loft Room)
 Eaves Storage : 11.93 sq m / 128 sq ft
 Garage : 15.57 sq m / 168 sq ft
 Loft Room : 14.37 sq m / 155 sq ft

Key :
 CH - Ceiling Height

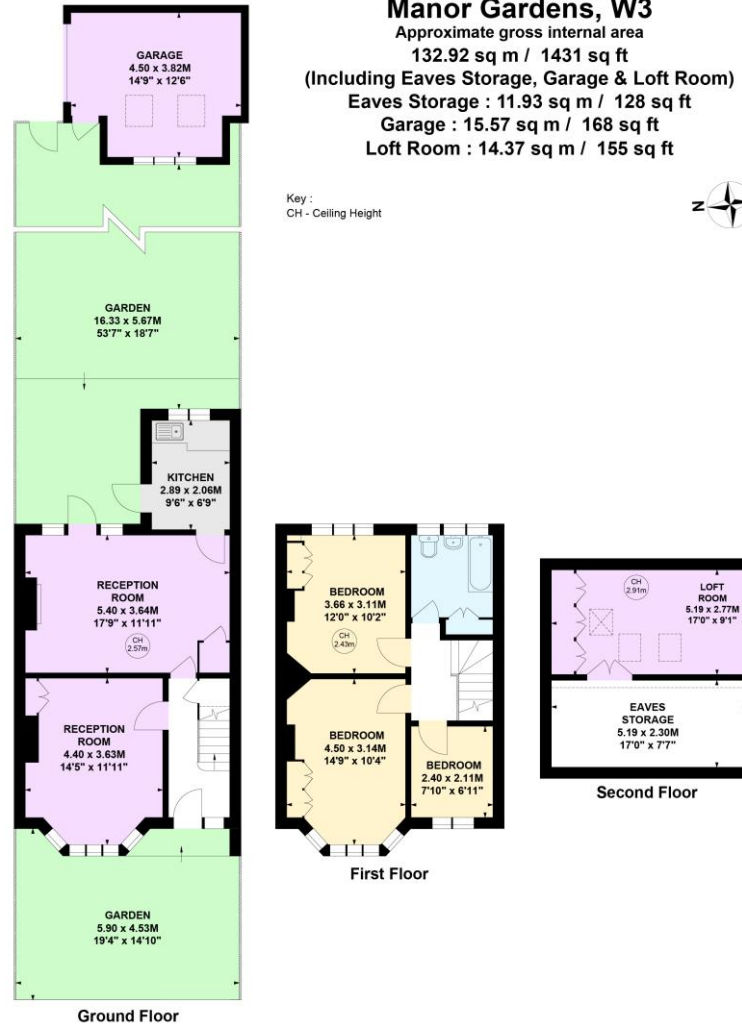

Not to scale, for guidance only and must not be relied upon as a statement of fact.
 All measurements and areas are approximate only

Chesterton UK Services Limited trading as Chestertons for themselves and for the vendor of this property whose agents they are, give notice that (i) these particulars do not constitute any part of an offer or contract, (ii) all statements contained within these particulars are made without responsibility on the part of Chestertons or the vendor, (iii) whilst made in good faith, none of the statements contained within these particulars are to be relied upon as a statement or representation of fact, (iv) any intending purchasers must satisfy themselves by inspection or otherwise as to the correctness of each of the statements contained within these particulars, (v) the vendor does not make or give either Chestertons or any person in their employment any authority to make or give representation or warranty whatsoever in relation to this property. Wide angle lenses may be used. ©Copyright Chestertons | Chesterton UK Services Limited | Registered Office 40 Connaught Street, Hyde Park, London W2 2AB Registered Company Number 05334580.



This paper is
 100% recyclable