



54 Hough Lane

Wombwell, Barnsley, S73 0EF

£130,000



This two-bedroom mid-terrace home boasts rear parking, an outbuilding, and a versatile loft room ideal for a home office or teenager's space.

Presented ready to move straight into, the property would make an ideal purchase for a first-time buyer or downsizer alike.

Situated on the ever-popular Hough Lane, the home is within walking distance of the train station and a range of local amenities, including schools and supermarkets.

The accommodation briefly comprises a lounge, dining kitchen, bathroom, two bedrooms, and a loft room, offering spacious and flexible living throughout.



GROUND FLOOR

LOUNGE

A well-presented front-facing lounge featuring a double glazed window, entrance door, feature fireplace, and radiator.

DINING KITCHEN

A spacious dining kitchen comprising a range of wall and base units with work surfaces over, incorporating a sink unit with mixer tap. There is a freestanding oven and space for additional appliances, along with an open fire. A door provides access to the cellar.

FIRST FLOOR

BEDROOM ONE

Featuring a front-facing double glazed window, walk-in style wardrobe/storage area, and radiator.

BEDROOM TWO

Featuring a rear-facing double glazed window, radiator, and combination boiler.

BATHROOM

A well-appointed three-piece suite comprising a bath with shower over, WC, and wash hand basin, partially tiled, and complemented by a window with obscure glazing and radiator.

SECOND FLOOR

LOFT ROOM

A spacious loft room offering versatility, ideal as a teenager's room or home office space.

OUTSIDE

To the front are steps leading to the front door, while to the rear is off-road parking and outbuildings providing storage.

Area Map



Floor Plans

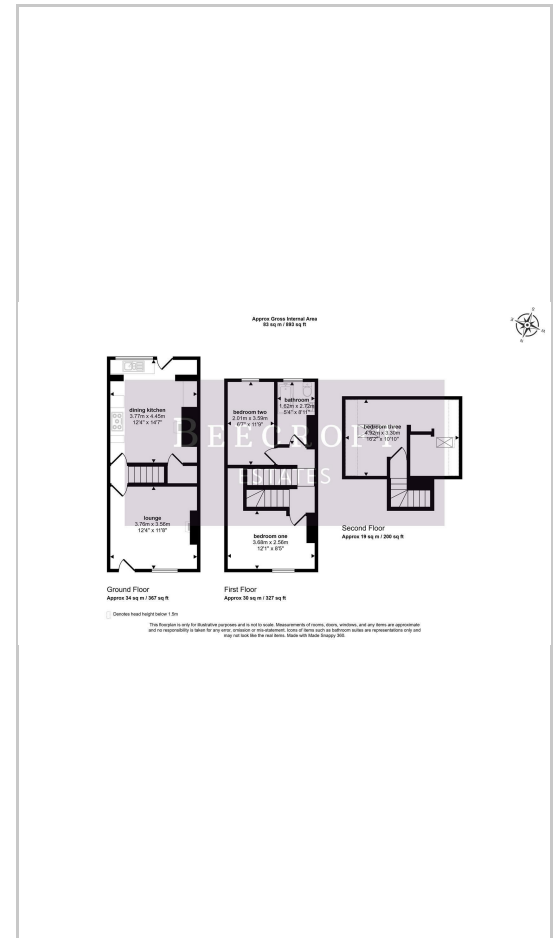

Energy Efficiency Graph

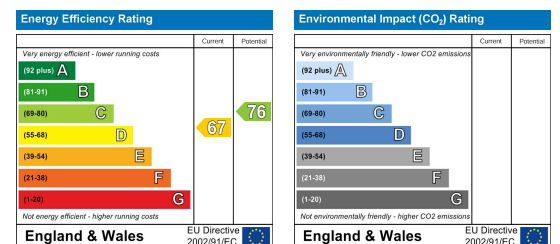

These particulars, whilst believed to be accurate are set out as a general outline only for guidance and do not constitute any part of an offer or contract. Intending purchasers should not rely on them as statements of representation of fact, but must satisfy themselves by inspection or otherwise as to their accuracy. No person in this firm's employment has the authority to make or give any representation or warranty in respect of the property.

Wombwell 6-8 Park Street, Wombwell, S73 0DJ

Tel: 01226 340110 Email: info@beecroftstates.co.uk www.beecroftstates.co.uk