

Kempton Court, TW16

£325,000

Located within a sought after development, this beautifully presented ground floor apartment offers two generous double bedrooms and enjoys access to well maintained communal gardens

Kempton Court is conveniently accessed via Kempton Avenue and enjoys close proximity to both Sunbury and Kempton Park stations, as well as excellent transport links including the A316, M3, and M25.

Features

- Ground Floor Flat
- Two Double Bedrooms
- Modern Apartment
- Shaker Style Kitchen
- Family Bathroom
- Communal Gardens

Kempton Court, Sunbury-On-Thames, TW16

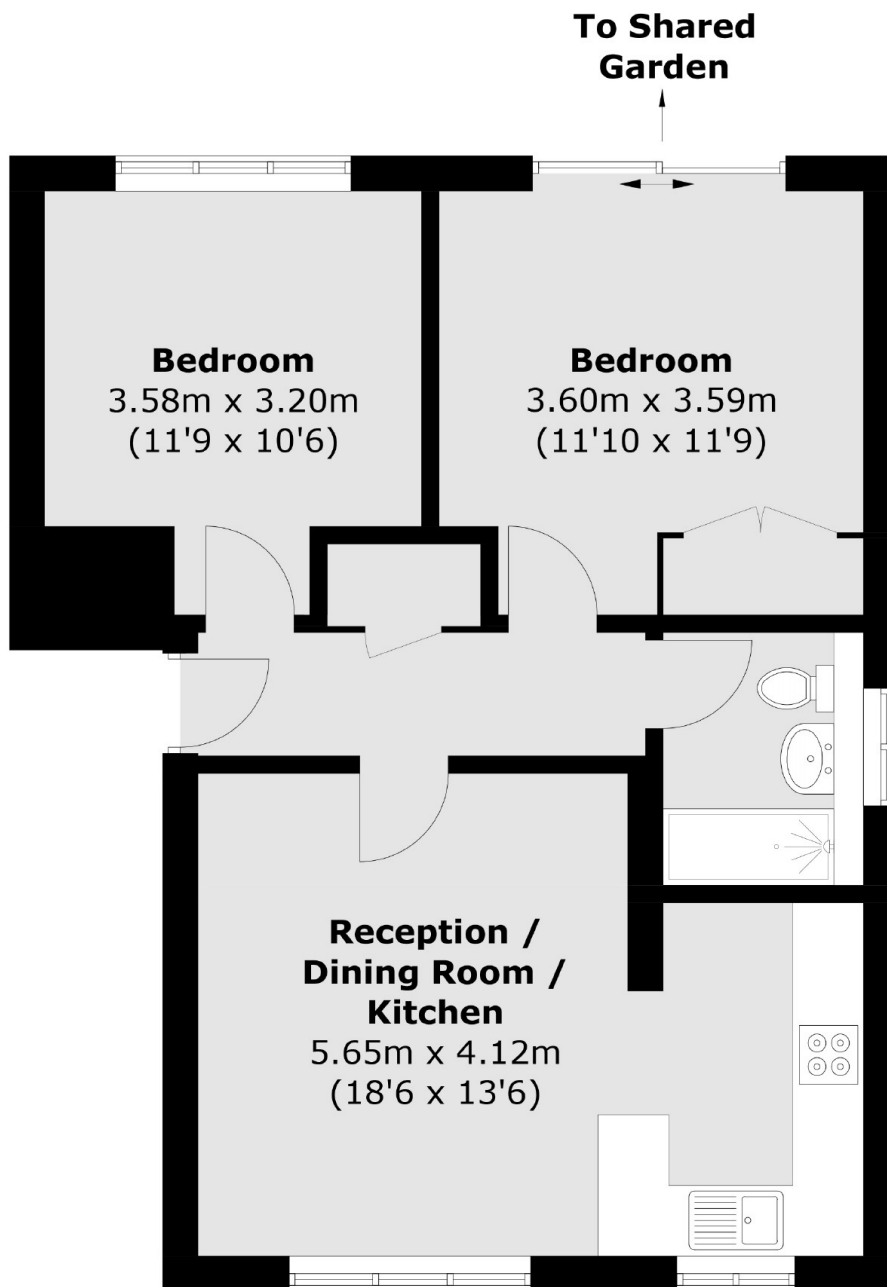

Total area (approx.): 56.3 sq. m (606.0 sq. ft)