



Kaytons
estate agents
Sales | Lettings | Management

365

al-maryam

365

ERECTED
COUNTY BOROUGH
SALFORD
MEMORIAL TO MANY
TOWNSMEN WHO FIGHTED
FOR FREEDOM AND LIBERTY
IN THE GREAT
WAR 1914-1918
PARTICULARLY IN HONOUR
VOLUNTEERS
ACTIVE SERVICE COMMANDERS
LANCEMINE DRAGGERS
DURING ET ALL THINGS



Apt 30 Zenith, 365 Chapel Street, Salford, M3 5JT

Modern Method of Auction

We are pleased to have for sale this modern and attractive one bedroom apartment found on the 4th floor of the Zenith development, Salford. The property comprises of an entrance hallway, family sized bathroom, spacious double bedroom, welcoming lounge with a Juliet balcony, contemporary kitchen with integrated appliances. CASH BUYERS ONLY.

Auction Guide £50,000

Viewing arrangements

Viewing strictly by appointment through the agent

245 Deansgate, Manchester, M3 4EN 0161 833 9499 opt 3

AUCTIONEERS COMMENTS

This property is for sale by the Modern Method of Auction, meaning the buyer and seller are to Complete within 56 days (the "Reservation Period"). Interested parties personal data will be shared with the Auctioneer (iamsold).

If considering buying with a mortgage, inspect and consider the property carefully with your lender before bidding.

A Buyer Information Pack is provided. The winning bidder will pay £349.00 including VAT for this pack which you must view before bidding. The buyer signs a Reservation Agreement and makes payment of a non-refundable Reservation Fee of 4.5% of the purchase price including VAT, subject to a minimum of £6,600.00 including VAT. This is paid to reserve the property to the buyer during the Reservation Period and is paid in addition to the purchase price. This is considered within calculations for Stamp Duty Land Tax.

Services may be recommended by the Agent or Auctioneer in which they will receive payment from the service provider if the service is taken.

Payment varies but will be no more than £450.00. These services are optional.

Kitchen

7'10" x 7'5"

Range of wall and base units, complimentary kitchen worktop, integrated appliances, spot lighting and under cabinet lighting.

Lounge

9'9" x 11'8"

Access to Juliet balcony, two floor to ceiling double glazed UPVC windows, spot lighting, electrical power sockets.

Bathroom

8'7" x 5'5"

Low level W.C, hand wash basin, heated towel rail, spot lighting, fitted mirror, bath with glass shower screen and mixer attachment.

Bedroom

10'5" x 8'3"

Laminate flooring, spot lighting, electrical power sockets, double glazed floor to ceiling double glazed window.

Additional Information

Service Charge- £2,260.16 (Including building insurance and external / internal service charge)

Ground Rent - £500.00 PA

EPC- C

Council Tax Band - A

Leasehold - 250 years left from 2006

Agents Notes

To be able to purchase a property in the United Kingdom all agents have a legal requirement to conduct Identity checks on all customers involved in the transaction to fulfil their obligations under Anti Money Laundering regulations. We outsource this check to a third party and a charge will apply. Ask the branch for further details.

Disclaimer

IMPORTANT NOTE TO PURCHASERS: The lease, ground rent and service charges should all be checked via the solicitors for clarification. We endeavour to make our sales particulars accurate and reliable, however, they do not constitute or form part of an offer or any contract and none is to be relied upon as statements of representation or fact. The services, systems and appliances listed in this specification have not been tested by us and no guarantee as to their operating ability or efficiency is given. All measurements have been taken as guide to prospective buyers only, and are not precise. If floor plans were included, these may not be to scale and accuracy is not guaranteed. If you require clarification or further information on any points, please contact us.

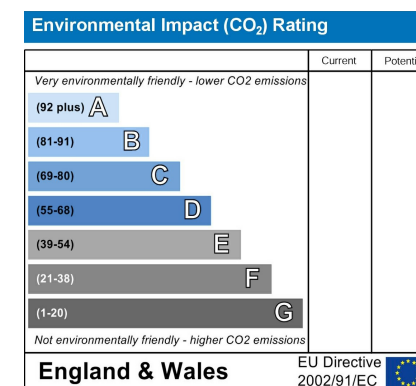
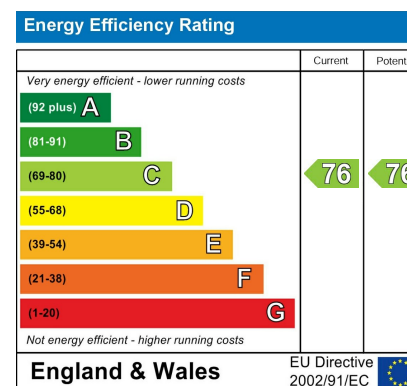



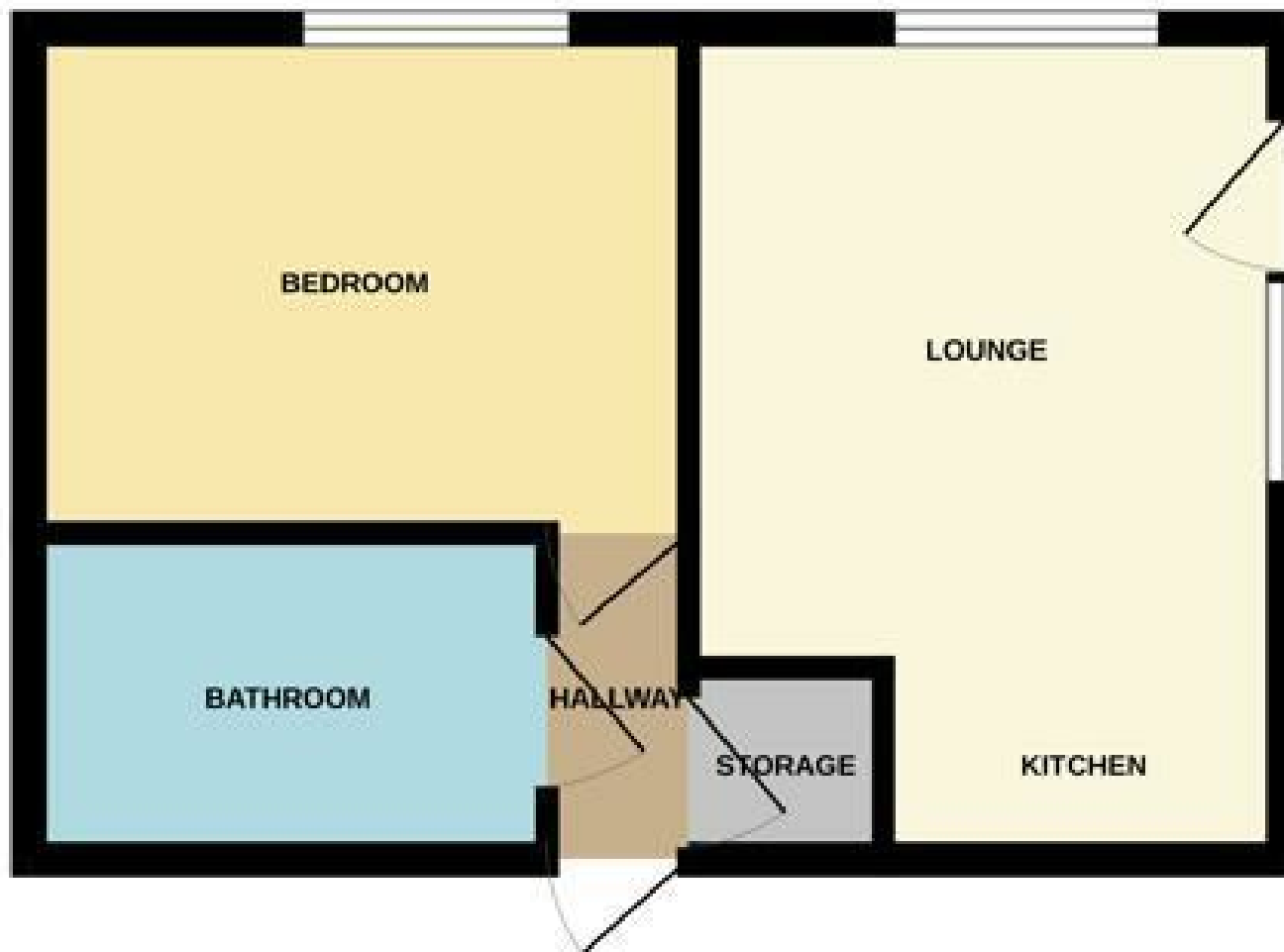

These particulars are believed to be accurate but they are not guaranteed and do not form a contract. Neither Jordan Fishwick nor the vendor or lessor accept any responsibility in respect of these particulars, which are not intended to be statements or representations of fact and any intending purchaser or lessee must satisfy himself by inspection or otherwise as to the correctness of each of the statements contained in these particulars. Any floorplans on this brochure are for illustrative purposes only and are not necessarily to scale.

Offices at: Chorlton, Didsbury, Disley, Hale, Glossop, Macclesfield, Manchester Deansgate, Manchester Whitworth Street, New Mills, Sale, Wilmslow and Withington

245 Deansgate, Manchester, M3 4EN

0161 833 9499 opt 3

manchester@jordanfishwick.co.uk
www.jordanfishwick.co.uk

