





Vere Road, Hillsborough, Sheffield, S6 1SA

Offers Over £195,000

3  1  2 



Why You'll Love It

From the moment you step inside, this home impresses with its thoughtful renovation and attention to detail. The front-facing living room is a warm and inviting space, centred around a charming log burner which is perfect for cosy evenings in. Neutral décor and quality finishes create a calm, contemporary feel while still retaining a sense of character.

To the rear, the property opens up into a open-plan kitchen and dining area making it the heart of the home. Designed with both style and practicality in mind, the kitchen features sleek units, integrated appliances, and ample worktop space. Whether you're cooking for family or entertaining guests, this space works effortlessly. There is also direct access to the cellar, providing useful additional storage.

Upstairs, the first floor offers two well-proportioned rooms. The front bedroom is a generous double, filled with natural light and finished to a high standard. The second room is a versatile space; ideal as a child's bedroom, nursery, or home office depending on your needs. The bathroom is also located on this floor, beautifully finished with modern fittings and a clean, contemporary design.

The top floor is dedicated to an impressive master suite. This spacious bedroom benefits from Velux windows, allowing natural light to pour in while creating a peaceful, private retreat. It's a fantastic space to unwind, offering both comfort and a sense of luxury.

Externally, the property continues to deliver. To the rear is a private garden, perfect for relaxing, entertaining, or enjoying warmer months. To the front, there is on-street parking readily available.

Why We Love It

Vere Road sits within the ever-popular Hillsborough area, one of Sheffield's most vibrant and well-connected neighbourhoods. It perfectly balances urban convenience with access to green space, making it a highly desirable place to live.

Just a short distance away, you'll find Hillsborough's bustling centre,



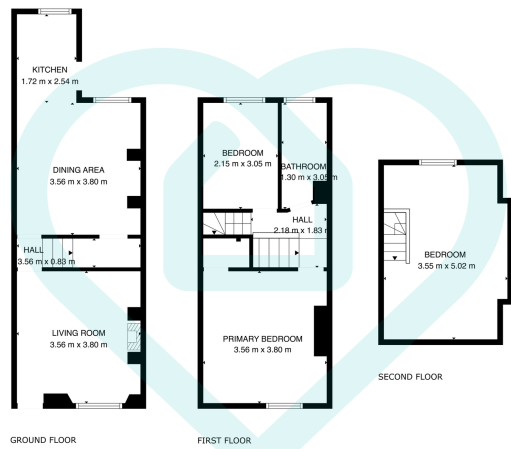

TOTAL: 83 m²
 GROUND FLOOR: 35 m², FIRST FLOOR: 31 m², SECOND FLOOR: 17 m²
 EXCLUDED AREAS: WALLS: 7 m²

This floor plan is for illustrative purposes only. All measurements and layouts are approximations and do not necessarily capture the precise specifications of the property. No responsibility is taken for any error, omission, or misstatement. We always recommend viewing in person to confirm the exact floor plan of a property. Made with Metropix.



- No Chain
- Recently Renovated To A High Specification
- Open Plan Kitchen/Dining Area
- Private Rear Garden
- Good Transport Links To Sheffield and Surrounding Areas
- Popular Hillsborough Location
- Three Good Sized Bedrooms
- Great First Time Buyer Home
- Close To Shops, Pubs and Cafe's
- Great For Commuting

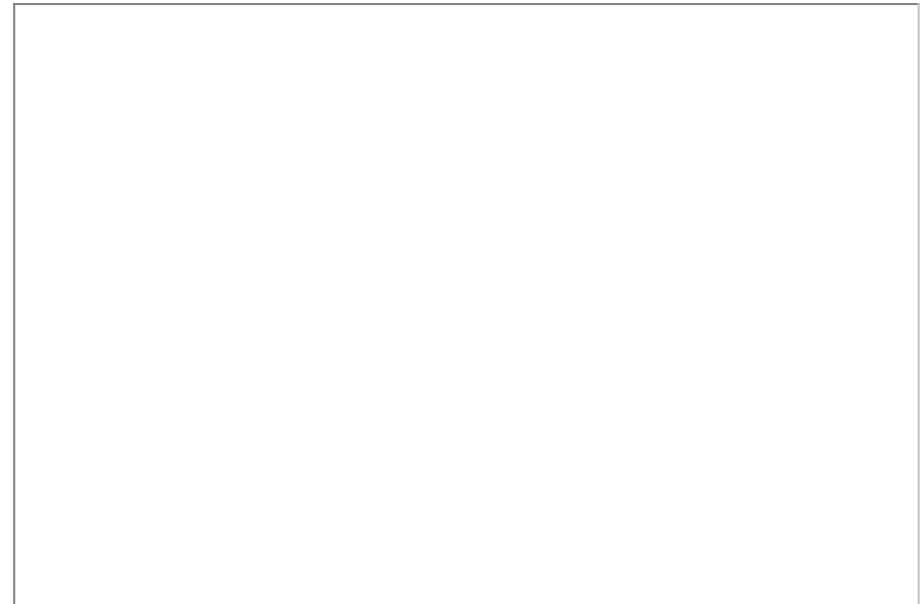

Sales | Lettings | New Homes

VAT Reg Number: 191 3588 84
 Company Reg Number: 08610489
 Company Reg Address: 67 Middlewood Road, Hillsborough, Sheffield, S6 4GX.

The MorfittSmith Building
 67 Middlewood Road
 Hillsborough
 Sheffield
 S6 4GX

Get in touch - arrange an appointment



0114 232 1764
 sales@morfittsmith.co.uk
 lettings@morfittsmith.co.uk
 newhomes@morfittsmith.co.uk
 www.morfittsmith.co.uk



@MorfittSmith
 @MorfittSmith
 MorfittSmith
 Estate & Letting Agent