

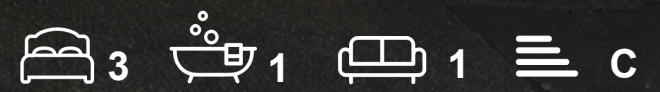

21 Exeter Close  
, Stevenage, SG1 4PN  
Guide price £310,000



## 21 Exeter Close, Stevenage, SG1 4PN

Greenhill Estates are delighted to be marketing this deceptively spacious three bedroom terraced house, perfectly positioned within a residential square surrounding a pleasant central green. Offering approximately 946 square feet of living space, this home represents a fantastic opportunity for first time buyers looking to step onto the property ladder, or investors seeking a solid addition to their portfolio. While the property requires some cosmetic updating throughout, it acts as a superb blank canvas, allowing the new owners to add immediate value and stamp their own personal style on the home. With a highly functional layout and well proportioned rooms, it promises to be a wonderful family home once modernised.



Step Inside:

Step Outside:

Location:

Buyers Note:



## Area Map

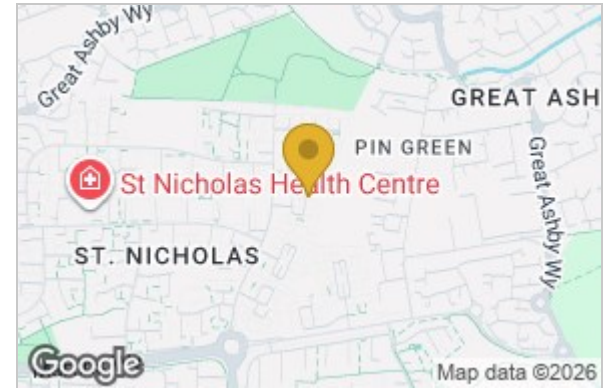

## Floor Plan

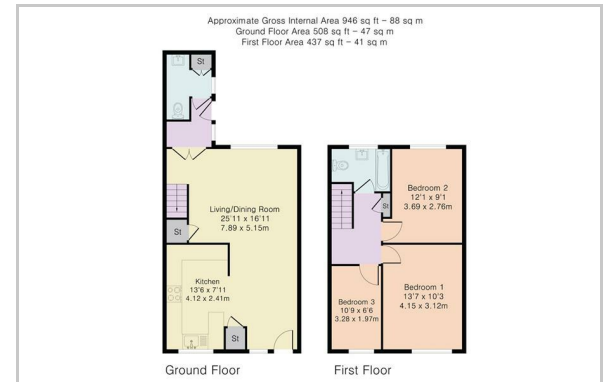

## Energy Efficiency Graph

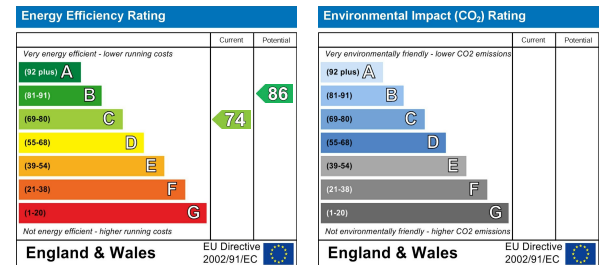

These particulars, whilst believed to be accurate are set out as a general outline only for guidance and do not constitute any part of an offer or contract. Intending purchasers should not rely on them as statements of representation of fact, but must satisfy themselves by inspection or otherwise as to their accuracy. No person in this firm's employment has the authority to make or give any representation or warranty in respect of the property.

Sopers House Sopers Road, Cuffley, EN6 4RY

Tel: 01707 802001 Email: sales@greenhillestates.co.uk <https://www.greenhillestates.co.uk>