



## Wharncliffe Mews, SW4

### £400,000

Offers In Excess Of. This wonderfully refurbished ground-floor apartment is set within a quiet and private mews, offering a high standard of modern living throughout and the rare benefit of a large private garden. The property features a well-proportioned reception room with direct access to the garden, creating an ideal space for both relaxing and entertaining. A fully integrated kitchen is finished to a sleek and contemporary standard. The generous double bedroom includes fitted wardrobes, while the stylish, newly installed bathroom completes the accommodation. Further benefits include a long lease, no onward chain, and the option of underground parking available at a separate charge.

Wharncliffe Mews is ideally situated for the many local boutique shops, restaurants and bars of Abbeville Village, and the green open spaces of Clapham Common. Clapham Common & Clapham South stations are just a short walk away.

### Features

- Modern Apartment
- South West Facing Garden
- Large Reception Room
- Modern Kitchen
- Double Bedroom
- Long Lease

# Wharncliffe Mews, London, SW4

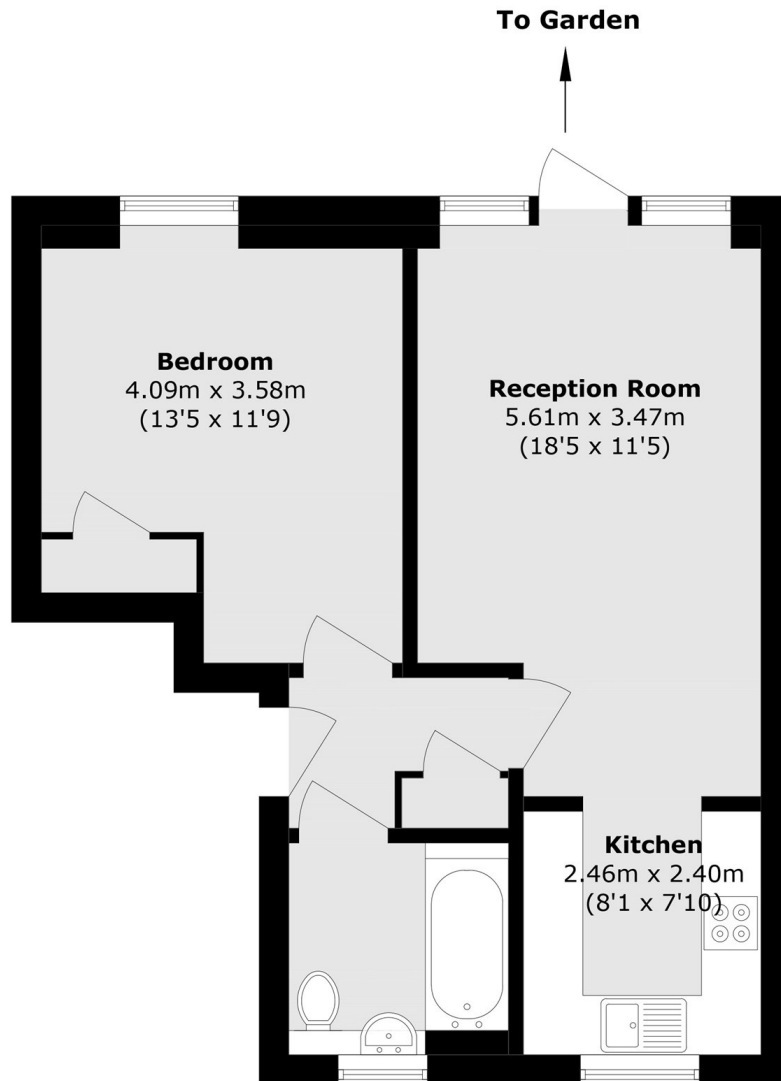

Total area (approx.): 49.8 sq. m (536.0 sq. ft)