



# Cunningham Drive, Bromborough

£400,000



**LESLEY HOOKS**  
ESTATE AGENTS





A fantastic opportunity to purchase this three-bedroom detached family home, ideally positioned on a generous corner plot with additional garden space offering excellent potential to extend and create a truly stunning forever home.

The property comprises an entrance hall, spacious lounge with dining area, kitchen with breakfast area, three well-proportioned bedrooms, and a family bathroom. To the front, there is a driveway leading to the garage, providing ample off-road parking.

One of the standout features of this home is the fantastic potential it offers. Subject to the necessary permissions, the current kitchen could be opened up and extended to create an impressive open-plan family room — perfect for modern family living, entertaining, and everyday life.

The generous rear and side gardens provide plenty of outdoor space for children, pets, or future development. Backing onto the train line, the property benefits from added privacy with no overlooking properties to the rear.



Conveniently located close to local shops, schools, and bus routes, with the train station just a 10-minute walk away, this home is ideally suited for families and commuters alike.

A wonderful family home full of potential, ready for its next owners to make it their own.

**Entrance Hall**  
6'2" (1.88m) x 5'6" (1.68m)

**Lounge**  
20'7" (6.27m) x 10'11" (3.33m)

**Kitchen**  
13'6" (4.11m) x 11'9" (3.58m)

**Bedroom One**  
12'11" (3.94m) x 10'3" (3.12m)

**Bedroom Two**  
12'5" (3.78m) x 10'0" (3.05m)

**Bedroom Three**  
10'5" (3.18m) x 6'8" (2.03m)

**Bathroom**  
7'7" (2.31m) x 6'2" (1.88m)

**Garage**  
18'3" (5.56m) x 8'7" (2.62m)







GROUND FLOOR  
615 sq.ft. (57.1 sq.m.) approx.



1ST FLOOR  
431 sq.ft. (40.0 sq.m.) approx.

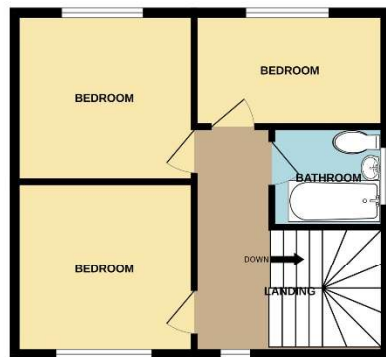

TOTAL FLOOR AREA : 1046 sq.ft. (97.1 sq.m.) approx.

Whilst every attempt has been made to ensure the accuracy of the floorplan contained here, measurements of doors, windows, rooms and any other items are approximate and no responsibility is taken for any error, omission or mis-statement. This plan is for illustrative purposes only and should be used as such by any prospective purchaser. The services, systems and appliances shown have not been tested and no guarantee as to their operability or efficiency can be given.  
Made with Metropix ©2025.

Disclaimer: Whilst these details are thought to be correct, their accuracy cannot be guaranteed and do not form part of any contract. It should be noted that we have not tested any fixtures, fittings, equipment, apparatus or services, therefore we cannot verify that they are in working order of fit for purpose. Solicitors should be used to confirm that any moveable items described within these details are in fact part of the sale agreement. While we try to ensure measurements are correct they are not guaranteed and purchasers are advised to take their own measurements before ordering any fixtures and fittings. Please note: if you are buying a leasehold property, please ensure that all details and conditions of the lease are checked with your solicitor prior to you incurring any costs as additional fees could be incurred for items such as leasehold packs.