



## Gleneagle Road, SW16

£1,100 PCM

A bright and spacious one bedroom first floor flat, presented in excellent condition throughout.

- First Floor Flat
- Large Reception Room
- Modern Fitted Kitchen
- One Bedroom
- Storage Space
- Close To Numerous Transport Links

For further information on the costs associated with renting a property, please pop into our office or visit our website.



Gleneagle Road provides easy access to both Streatham Common and Streatham train stations as well as a range of supermarkets, cafés and bars. The property is ideal for a professional couple or single occupant.



## Ground Floor

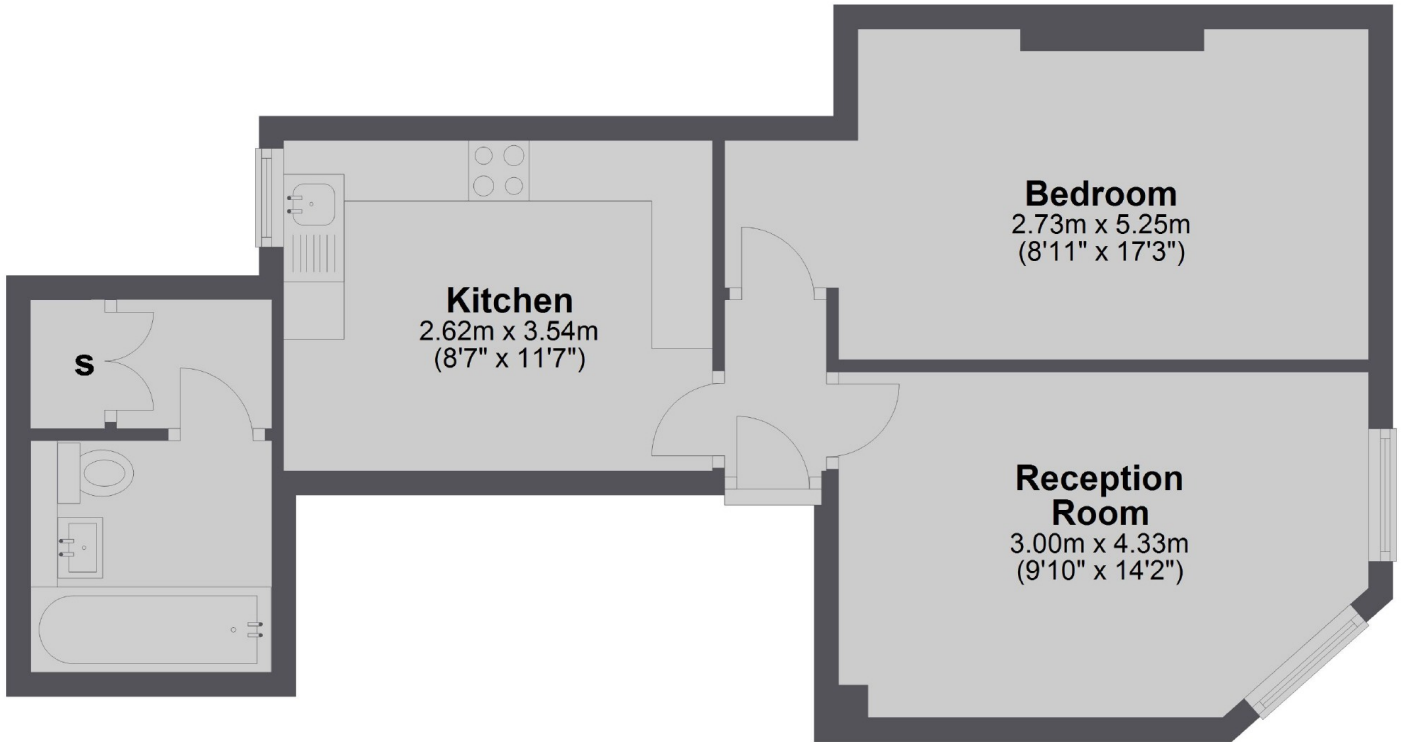

Total area: approx. 42.4 sq. metres (456.1 sq. feet)

Jacksons Streatham  
1-3 De Montfort Parade  
Streatham High Road  
Streatham  
London  
SW16 1BU

Energy Rating: D We aim to make our particulars both accurate and reliable. However they are not guaranteed; nor do they form part of an offer or contract. If you require clarification on any points then please contact us, especially if you're traveling some distance to view. Please note that appliances and heating systems have not been tested and therefore no warranties can be given as to their good working order.