



## Frogs Hall Road, Sudbury, Suffolk

### £1,600 Per month



Grace Estate Agents are delighted to present this charming and deceptively spacious three-bedroom character property, peacefully tucked away in the highly sought-after village of Lavenham, including an extensive garden in excess of 300ft!

Brimming with period charm and warmth, this attractive terraced home offers well-proportioned and versatile accommodation throughout, making it ideal for families, first-time buyers or those seeking a quintessential village lifestyle.

Upon entering the property, you are welcomed into a cosy and inviting Lounge, complete with character features that enhance the home's charm. A second, separate Dining Room provides an excellent space for entertaining guests or offering flexibility to suit a variety of living arrangements.

The spacious Kitchen is thoughtfully laid out, providing ample worktop and storage space, and comes fitted with an integrated oven and hob. Its practical design makes it both functional and sociable, with potential for further personalisation if desired.

Upstairs, the property boasts three well-sized bedrooms, each offering comfortable accommodation with plenty of natural light. These rooms can easily be adapted to suit individual needs, whether as bedrooms, a home office, or hobby space. The ground floor Bathroom is conveniently positioned and well-appointed.

Externally, the property benefits from a rear garden with shared access, along with shared use of the driveway to the rear — offering added practicality while maintaining the peaceful setting. The home further benefits from double glazing throughout and oil-fired central heating.

Situated within walking distance of the picturesque heart of Lavenham, renowned for its historic architecture, independent shops, and village amenities, this delightful property offers the perfect blend of character, space, and village charm.

- Quiet Location
- Rear Garden in Excess of 300 ft
- Lavenham Village
- Ample Off Road Parking
- Working Open Fire
- Double Glazed windows
- Local Walking paths nearby
- Character Property
- 3 Bedrooms

### £1,600 Per month

#### Viewing

Please contact our Grace Estate Agents Office on 01473 747728 if you wish to arrange a viewing appointment for this property or require further information.



GROUND FLOOR  
548 sq.ft. (50.9 sq.m.) approx.

1ST FLOOR  
371 sq.ft. (34.4 sq.m.) approx.

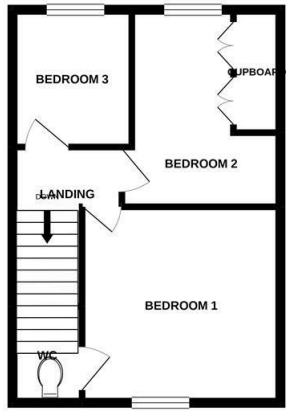
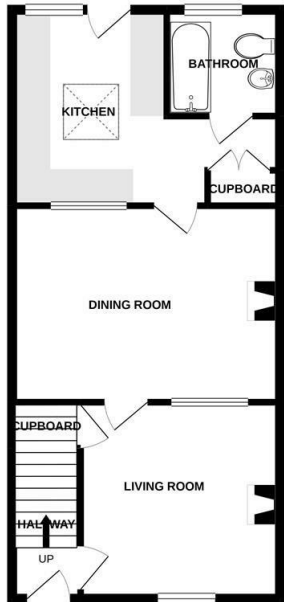

TOTAL FLOOR AREA: 1022sq ft. (94.9 sq.m.) approx.  
Whilst every attempt has been made to ensure the accuracy of the floorplan contained here, measurements of doors, windows, rooms and any other items are approximate and no responsibility is taken for any error, omission or mis-statement. This plan is for illustrative purposes only and should be used as such by any prospective purchaser. The architect, surveyor and appliances shown have not been tested and no guarantee as to their operability or efficiency can be given.  
Made with floorplan 02023



Energy Efficiency Rating	
Current	Potential
Very energy efficient - lower running costs	
(92 plus) <b>A</b>	
(81-91) <b>B</b>	
(69-80) <b>C</b>	
(55-68) <b>D</b>	
(39-54) <b>E</b>	
(21-38) <b>F</b>	
(1-20) <b>G</b>	
Not energy efficient - higher running costs	
<b>England &amp; Wales</b>	EU Directive 2002/91/EC

Environmental Impact (CO <sub>2</sub> ) Rating	
Current	Potential
Very environmentally friendly - lower CO <sub>2</sub> emissions	
(92 plus) <b>A</b>	
(81-91) <b>B</b>	
(69-80) <b>C</b>	
(55-68) <b>D</b>	
(39-54) <b>E</b>	
(21-38) <b>F</b>	
(1-20) <b>G</b>	
Not environmentally friendly - higher CO <sub>2</sub> emissions	
<b>England &amp; Wales</b>	EU Directive 2002/91/EC



These particulars, whilst believed to be accurate are set out as a general outline only for guidance and do not constitute any part of an offer or contract. Intending purchasers should not rely on them as statements of representation of fact, but must satisfy themselves by inspection or otherwise as to their accuracy. No person in this firm's employment has the authority to make or give any representation or warranty in respect of the property.