



Sussex Gardens, W2

£650,000

A well-presented apartment on the second floor of a Victorian period conversion. The property is presented in good order and has two bedrooms and an open plan kitchen and reception, perfect for entertaining.

Sussex Gardens is on the doorstep of Hyde Park, with easy access to Lancaster Gate and Paddington Station for the Heathrow Express. Locally there's plenty of local shops and restaurants to choose from.

Features

Victorian Conversion
Two Bedrooms
Open Plan
Share of Freehold
Hyde Park
Paddington

Sussex Gardens, London, W2

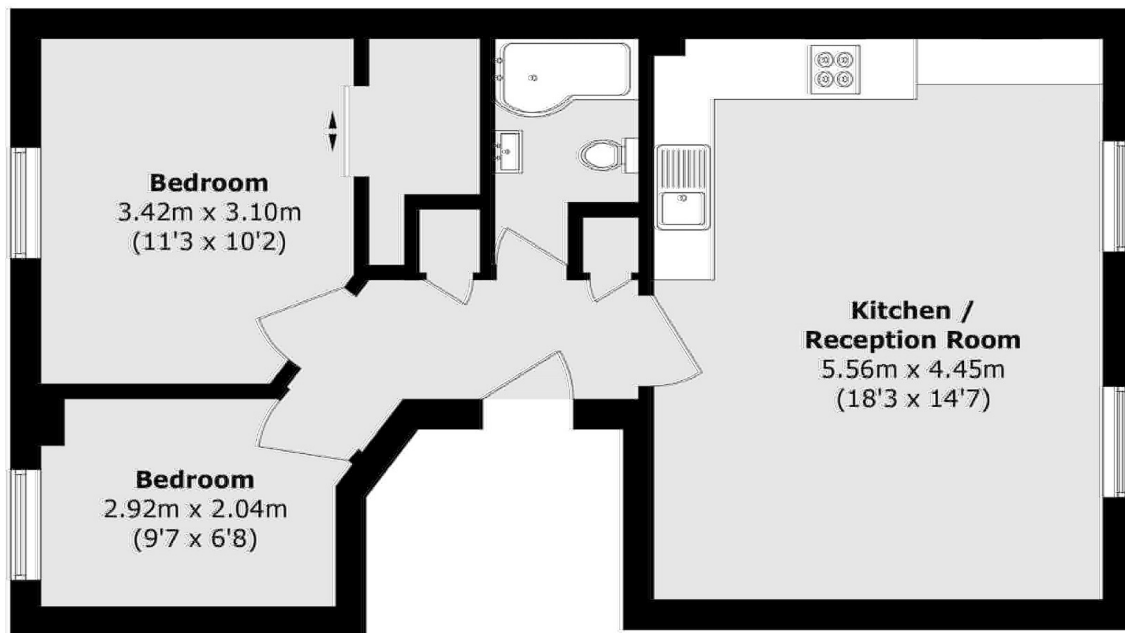

Total area (approx.): 52.7 sq. m (567.2 sq. ft)