



THE WEDGE, 39 BALLARD ESTATE, SWANAGE
£895,000 FREEHOLD

This superb luxury architecturally designed bungalow is located on the exclusive 'Ballard Estate' near the northern outskirts of Swanage, approximately 300m from open country and the beach via 'Ballard Chine'.

It is stylishly presented with impeccable detail to the highest specification throughout. The accommodation has been carefully arranged to take advantage of the abundance of natural light with striking vaulted ceilings, enhanced with high level windows throughout, veluxes and light tubes and a neutral decor. The flow from open spaces to more enclosed areas works perfectly.

Built by the current owners in 2005, it is constructed of SIP panels with brick and concrete render. The pitched section of the roof is covered with Redland cambrian slates and the flat roof is thought to be covered with zinc.

The seaside resort of Swanage lies at the eastern tip of the Isle of Purbeck, delightfully situated between the Purbeck Hills. It has a fine, safe, sandy beach, and is an attractive mixture of old stone cottage and more modern properties. To the South is the Durlston Country Park renowned for being the gateway to the Jurassic Coast and World Heritage Coastline. The market town of Wareham which has main line rail link to London Waterloo (approx. 2.5 hours) is some 9 miles distant with the conurbation of Poole and Bournemouth being in easy reach via the Sandbanks ferry.



The generously sized hallway is uniquely designed at an angle with high ceilings and incorporates expansive two tier windows and quality wood flooring, which flows through to all principal rooms, welcomes you to this stylish home. This area could easily be used as an informal living space/study. The impressive open plan living room continues the flow of design at an angle and has views of the Purbeck Hills. Dual aspects allow natural light to flood the room, further enhanced with light by way of the high ceilings and velux windows. Double glazed sliding doors lead to the garden, harmoniously blending the indoor/outdoor living space. The dual aspect kitchen is fitted with an extensive range of stylish units, including quality integrated appliances and ample storage.

The generously sized principal bedroom suite is at the rear of the property and enjoys dual aspects with double glazed sliding doors to the garden. It has a range of fitted wardrobes and a luxury en-suite shower room with quality fixtures creating a streamlined space. There are 2 further good sized South facing double bedrooms. The family bathroom is fitted with a stylish suite in white with panelled bath and shower over, wash basin with vanity cupboard, and WC.

Outside the property is approached by a gravelled driveway leading to the detached garage with electronically operated door. At the rear of the garage, with a separate entrance, is an office and a workshop fitted with worktops and cupboards. The landscaped mediterranean style garden offers an easily maintained space mostly bound by mature shrubs and includes a paved terrace, lawned area & raised borders.



Property Ref BAL1973
 Council Tax Band E
 2026/2027 - £3444.30

Ground Floor

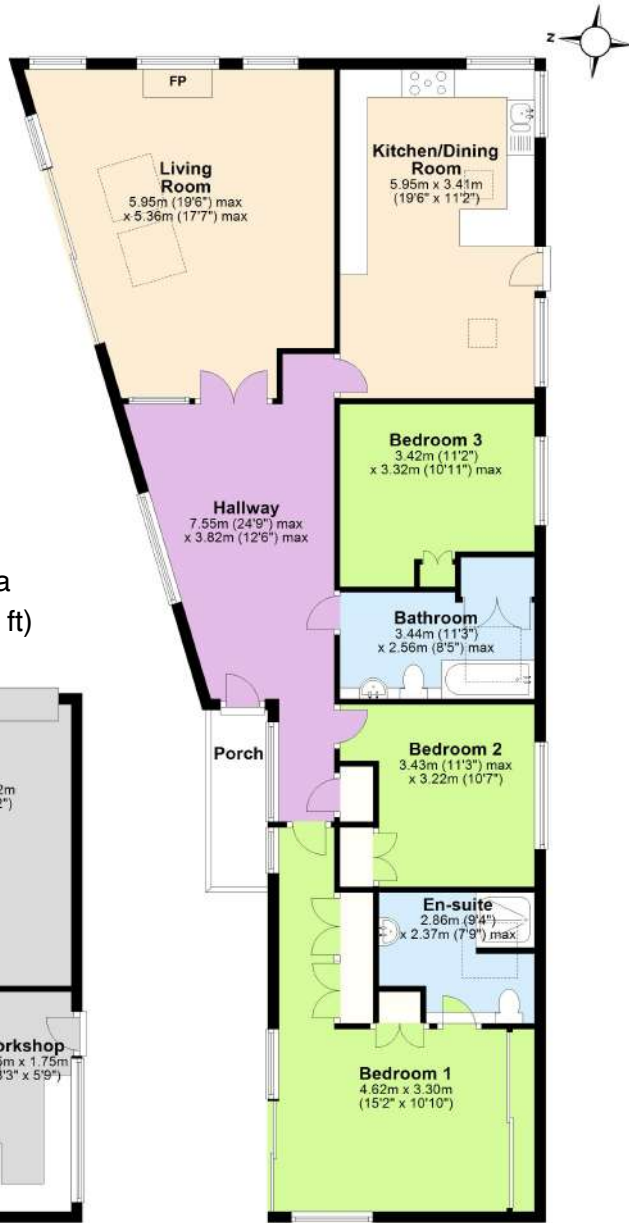

Total Floor Area
 146m² (1,571 sq ft)

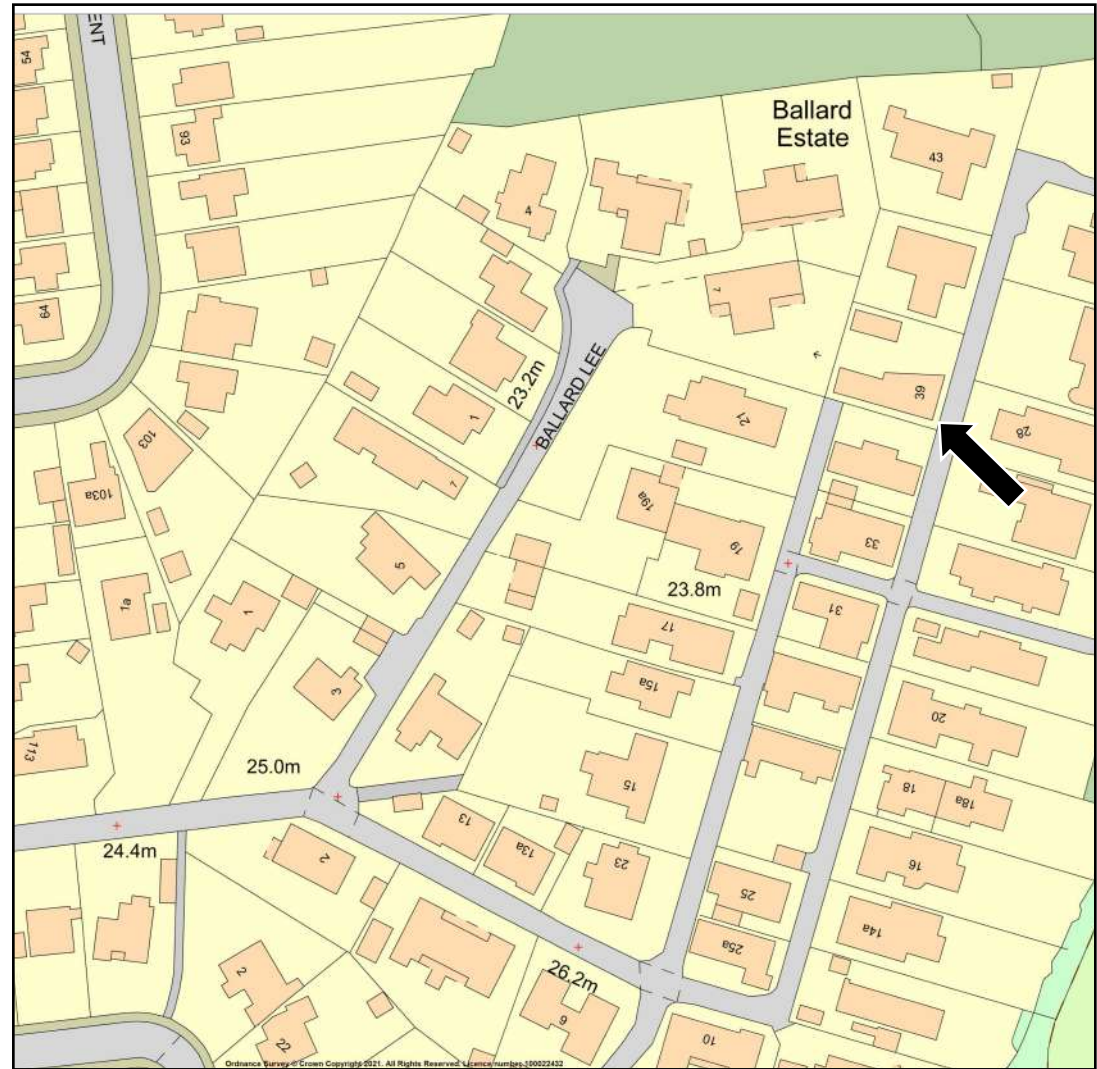
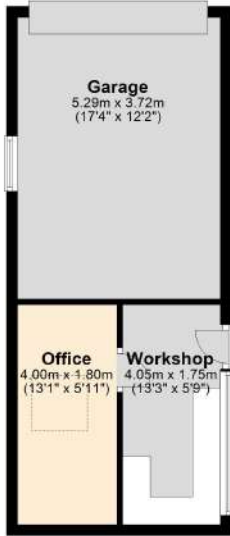

Viewing is highly recommended and is strictly by appointment through the Sole Agents, Corbens, **01929 42284**. The postcode for this property is **BH19 1QZ**.

Energy Efficiency Rating		Current	Potential
Very energy efficient - lower running costs			
(92 plus)	A		
(81-91)	B		
(69-80)	C		77
(55-68)	D	68	
(39-54)	E		
(21-38)	F		
(1-20)	G		
Not energy efficient - higher running costs			



Scan to View Video Tour

THE PROPERTY MISDESCRIPTION ACT 1991 You are advised to check the availability of this property before travelling any distance to view. The Agent has not tested any apparatus, equipment, fixtures and fittings or services and so cannot verify that they are in working order or fit for the purpose. References to the Tenure of a Property are based on information supplied by the Seller. The area of the building is given for guidance purposes only and must be verified by the purchasers surveyor. A Buyer is advised to obtain verification of this information from their Solicitor and/or Surveyor. FLOOR PLANS The floor plans supplied are for guidance purposes only and should not be used for measuring. Small recesses, cupboards & sloping ceilings may not appear on the plans. LOCATION PLAN The location plans supplied are for identification purposes only and are reproduced from the Ordnance Survey Map with permission of the Controller of H.M. Stationery Office. Crown Copyright reserved.







