

The Dumont

27 Albert Embankment, SE1 7AQ

Offers In Excess Of £1,900,000

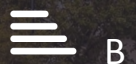
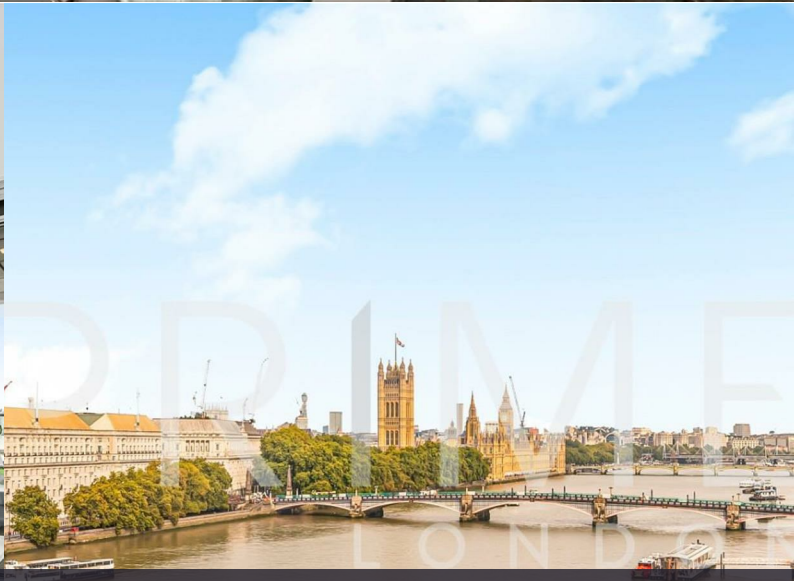

Floor Plan

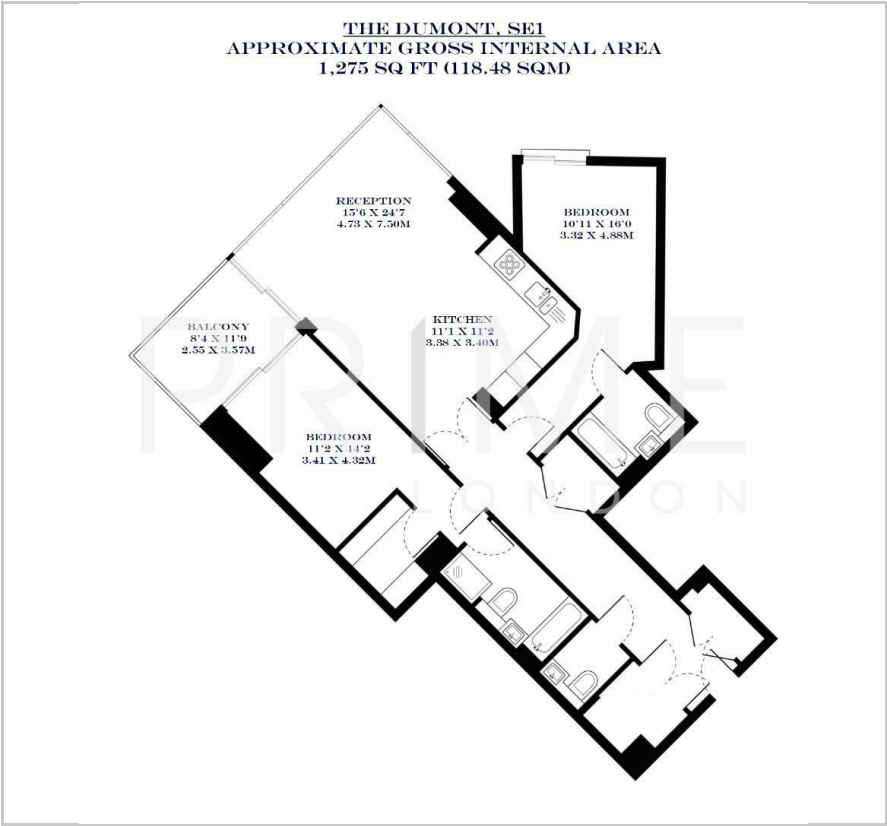

Area Map

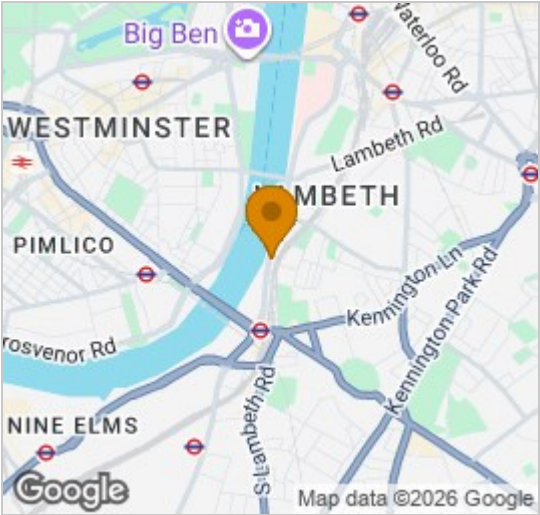

Energy Efficiency Graph

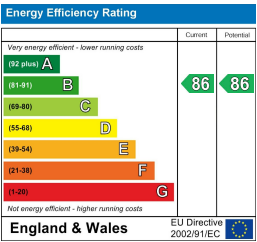

Viewing

By appointment. Contact us on 0207 928 6663 if you wish to arrange a viewing appointment for this property, or require further information.

- Extraordinary elite apartment
- Secure parking
- 24 hour concierge
- Swimming pool and spa
- 1,275 sq ft (118.48 sqm)
- Large storage locker
- Residents' bar and lounge
- Bowling alley and games room

An extraordinary elite apartment of some 1,275 sq ft (118.48sqm), facing directly onto the river and towards the Houses of Parliament, with secure parking and a large additional storage locker, available for chain free sale within The Dumont through Prime London.

Facilities at The Dumont include a cinema, screening room, ten pin bowling, games room, twelfth floor residents' lounge, dining room and roof terrace, 24 hour concierge and also an infinity pool, gym, spa and residents' bar located in The Corniche.

The Dumont completes the St James' trio of buildings on the Albert Embankment, situated between the cultural South Bank and the new Embassy District of Nine Elms.



These particulars, whilst believed to be accurate are set out as a general outline only for guidance and do not constitute any part of an offer or contract. Intending purchasers should not rely on them as statements of representation of fact, but must satisfy themselves by inspection or otherwise as to their accuracy. No person in this firm's employment has the authority to make or give any representation or warranty in respect of the property.