



FREEHOLD

Flat - Purpose Built (EPC Rating: D)

15 NELSON STREET, BAILLIESTON, GLASGOW, G69 7JG

Offers over

£90,000

FEATURES

- 2 Bedrooms
- Spacious reception room
- Flat on Nelson Street
- Close to local amenities
- 1 Bathroom
- Located in Baillieston
- Ideal for small families
- Easy access to transport



SWEET HOME



2 Bedroom Flat - Purpose Built located in Glasgow

This two-bedroom ground floor flat in Baillieston offers an excellent opportunity for first-time buyers and investors alike. Finished to a contemporary standard, the property provides comfortable and stylish living in a well-connected location.

The accommodation comprises a bright and spacious living area, a well-appointed kitchen, two generously sized bedrooms, and a sleek family bathroom. The ground floor position ensures easy access, making it a practical choice for a wide range of buyers.

Ideally situated in the popular area of Baillieston, the property benefits from a wealth of local amenities including shops, supermarkets, as well as a selection of bars and restaurants, all within close proximity. Excellent motorway links provide easy access to Glasgow City Centre and beyond, while convenient public transport options make commuting straightforward.

This attractive flat presents a fantastic opportunity as a first home or a buy-to-let investment, combining modern living with a highly accessible location.

Early viewing is highly recommended!

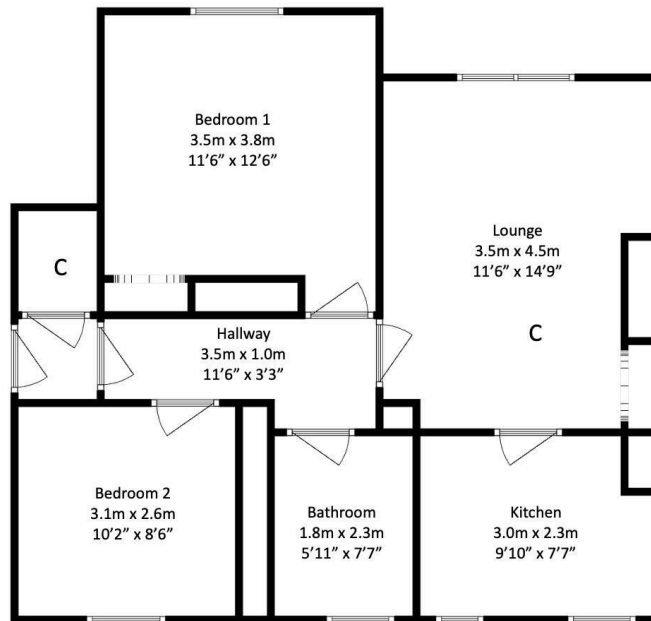

Call us on

01236 677500

sales@sweet-home.co.uk

<https://sweet-home.co.uk/>

Council Tax Band

B

Energy Efficiency Rating		Current	Potential
<i>Very energy efficient - lower running costs</i>			
(92 plus)	A		
(81-91)	B		
(69-80)	C		
(55-68)	D	66	72
(39-54)	E		
(21-38)	F		
(1-20)	G		
<i>Not energy efficient - higher running costs</i>			
Scotland		EU Directive	
		2002/91/EC	

Agents Note: Whilst every care has been taken to prepare these particulars, they are for guidance purposes only. All measurements are approximate and are for general guidance purposes only and whilst every care has been taken to ensure their accuracy, they should not be relied upon and potential buyers are advised to recheck the measurements.

SWEET HOME

