

# Towers Wills

Town & Country

📞 01935 577 032 | 01460 298 530 | ✉ info@towerswills.co.uk



## 84, Lime Tree Avenue, Yeovil, Somerset BA20 2PT **£250,000**

Towers Wills welcome to the market a three-bedroom end terrace home situated in the popular Lime Tree Avenue area of Yeovil, offered with no onward chain and ideally located close to Holy Trinity Primary School, local amenities and Leonardo. The property features a spacious living room, kitchen/diner, three bedrooms and a family bathroom. Outside offers front and rear gardens, a garage in a block and allocated parking.

**Accommodation:**

Situated on the popular Lime Tree Avenue area of Yeovil, this three-bedroom end terrace home offers an ideal first-time buy or investment, available with no onward chain. Conveniently positioned within walking distance of Holy Trinity Primary School, local supermarkets, Lysander Park and Leonardo, the property combines practicality with lifestyle appeal.

The accommodation includes a porch, spacious living room and a kitchen/diner fitted with a range of units and integrated appliances, with access to the rear garden. Upstairs are three bedrooms—two with useful storage—and a family bathroom.

**Outside:**

Outside, the property benefits from a large front lawn, an enclosed rear garden mainly laid to patio with gated access, plus a garage in a nearby block and allocated parking.

## Key Features

- Popular Location
- NO ONWARD CHAIN
- Three Bedrooms
- Garage in a Block
- Allocated Parking
- Gardens

## Contact Us

**Towers Wills Estate  
Agents - Yeovil**

114, Hendford Hill

Yeovil

Somerset

BA202RF

T: 01935 577032

E: [info@towerswills.co.uk](mailto:info@towerswills.co.uk)



# Floor Plan

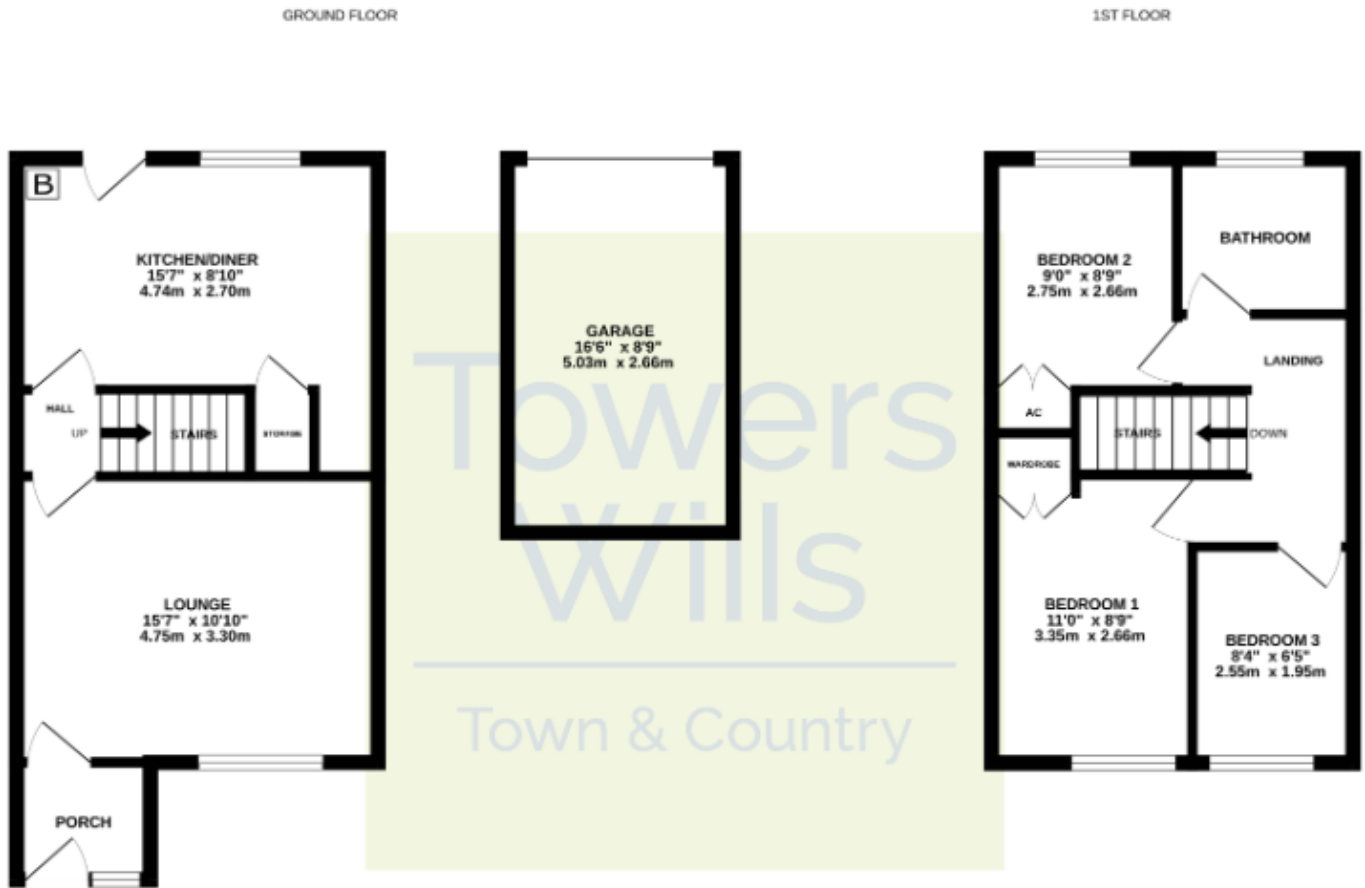

Please Note No tests have been undertaken of any of the services and any intending purchasers should satisfy themselves in this regard. Towers Wills Ltd for themselves and for the vendor of this property whose agents they are, give notice that, (i) these particulars do not constitute any part of an offer or contract, (ii) all statements contained within these particulars are made without responsibility on the part of Towers Wills or the vendor, (iii) whilst made in good faith, none of the statements contained within these particulars are to be relied upon as a statement of representation or fact, (iv) any intending purchaser must satisfy him/herself by inspection or otherwise as to the correctness of each of the statements contained within these particulars, (v) the vendor does not make or give either Towers Wills or any person in their employment any authority to make or give representation or warranty whatsoever in relation to this property.

Photographs / Floor Plans Photographs are reproduced for general information and it must not be inferred that any item is included for sale with this property. Please note floor plans are not to scale and are for identification purposes only. The photographs used in these particulars may have been taken with the use of a wide angle lens. If you have any queries as to the size of the accommodation or plot, please address these with the agent prior to making an appointment to view

**Towers Wills**

The White House, 114 Hendford Hill, Yeovil BA20 2RF

Yeovil 01935 577032 / South Petherton 01460 298530

[info@towerswills.co.uk](mailto:info@towerswills.co.uk) | [www.towerswills.co.uk](http://www.towerswills.co.uk)