



YOUR MOVE
Bennetts

WWW.YOUR-MOVE.CO.UK

Gordon Avenue, Thorpe St Andrew,
Norwich

Guide £300,000

Gordon Avenue, Thorpe St Andrew, Norwich

Guide £300,000

DESCRIPTION

**** LOCATED IN THE POPULAR SUBURB OF THORPE ST ANDREW **** GUIDE PRICE £300,000- £310,000. Your Move Bennetts are pleased to offer this four bedroom semi detached bungalow in good decorative order, double glazing and gas central heating. The accommodation comprises entrance hall, bedroom with en suite W.C., three bedrooms, bathroom, lounge, kitchen/diner and conservatory. To the front of the property is parking for several vehicles. To the rear of the property is a private garden laid to lawn and double garage. Viewing is essential to appreciate the location and accommodation offered by this property.

DIRECTIONS

Leave the Your Move Bennetts office via Harvey Lane, turn left onto Gordon Avenue where the property can be found on the left clearly marked by a Your Move Bennetts For Sale board.

AGENTS NOTE

All photographs have been taken with a wide angled lens. Planning permission has been historically past for bedrooms in the loft but this is now out of date.

EPC RATING

EPC Rating E

FLOORPLAN

DIMENSIONS



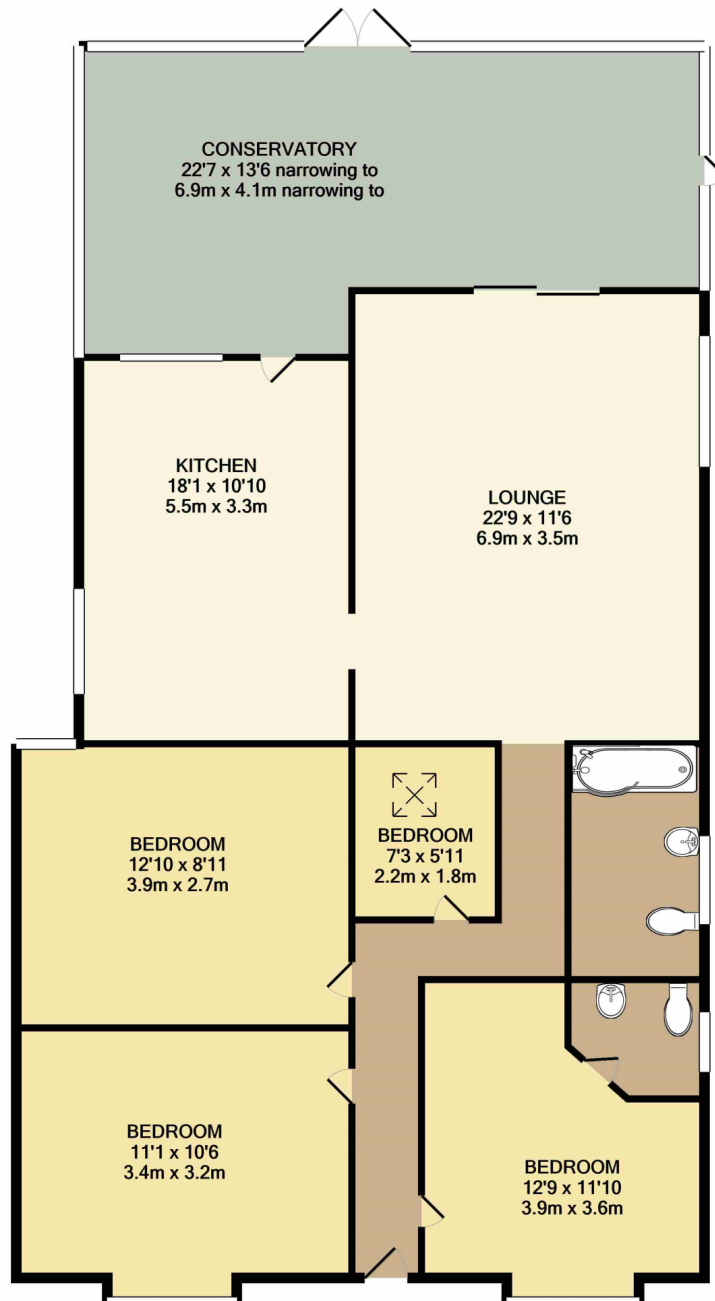

Whilst every attempt has been made to ensure the accuracy of the floor plan contained here, measurements of doors, windows, rooms and any other items are approximate and no responsibility is taken for any error, omission, or mis-statement. This plan is for illustrative purposes only and should be used as such by any prospective purchaser. The services, systems and appliances shown have not been tested and no guarantee as to their operability or efficiency can be given
 Made with Metropix ©2019

YOUR MOVE Bennetts Ltd is the trading name of Bennetts Ltd, registered company number 4928563, registered office 4 Harold Close, Norwich. YOUR MOVE Bennetts is an independently owned and operated business, operated under licence from your-move.co.uk Limited.

IMPORTANT NOTE TO PURCHASERS: We endeavour to make our sales particulars accurate and reliable, however, they do not constitute or form part of an offer or any contract and none is to be relied upon as statements of representation or fact. The services, systems and appliances listed in this specification have not been tested by us and no guarantee as to their operating ability or efficiency is given. All measurements have been taken as guide to prospective buyers only, and are not precise. Floor plans where included are not to scale and accuracy is not guaranteed. If you require clarification or further information on any points, please contact us, especially if you are travelling some distance to view. Fixtures and fittings other than those mentioned are to be agreed with the seller.

Fixtures & Fittings

Fixtures and fittings other than those mentioned above to be agreed with the Seller.

Services Connected

Please note that any services, heating systems or appliances have not been tested, and no warranty can be given or implied as to their working order.

All Measurements

All Measurements are Approximate

Laser Tape Clause

All measurements have been taken using a laser tape measure and therefore, may be subject to a small margin of error.

Escrow Clause



. Plumstead Road, Norwich, NR1 4AB
 tel: 01603 708978 **
 email: norwich@your-move.co.uk
 www.your-move.co.uk - The UK's most visited estate agency website*



WWW.YOUR-MOVE.CO.UK