



Beech Lea, Blunsdon, Swindon SN26 7DE

£699,950
(Subject to Contract)

Hanley's

Beech Lea, Blunsdon, SN26 7DE

Situated in a sought after location within the popular village of Blunsdon, a spacious four bedroom detached house situated on a large mature plot. The well presented accommodation has been updated and improved by the current owners with the accommodation comprising: Entrance hall, cloakroom, dual aspect living room with fireplace and fitted gas fire, arch through to the study/ family room with door to the garden, separate dining room, fitted kitchen with integrated double oven and gas hob with extractor fan over, separate utility room with door to the rear. To the first floor: landing with loft access, stylishly re-fitted family bathroom with twin sinks, bath and a separate shower cubicle, four good sized bedrooms; bedroom one has an en-suite shower room and large walk-in wardrobe. Outside to the front the garden is laid to lawn with paved path and driveway providing off road parking leading to a detached double garage with power, light and personal door to the rear, with a greenhouse to the side. The large private rear garden is enclosed by panel fencing with gated access to the front and has been landscaped with established shrubs and trees (two covered with tree preservation orders), large paved patio, lawn and an area laid to stone chippings. The property further benefits from gas radiator central heating, double glazing and the vendors have updated the property which includes a combination boiler fitted in 2020, electric rewire in 2019, plus other improvements made, details available from our office.



2 Bathrooms



4 Bedrooms



3 Receptions

EPC: D 65

Council Tax Band: F

Tenure: Freehold



DISCLAIMER. These particulars, whilst believed to be accurate are set out as a general outline for guidance and do not constitute any part of an offer or contract. Intending purchasers should not rely on them as statements or representation of fact, but must satisfy themselves by inspection or otherwise as to their accuracy. No person in this firm's employment has the authority to make or give any representation or warranty in respect of the property. Floor plan measurements and distances are approximate only. We have not carried out a detailed survey nor tested the services, appliances or specific fittings. Your home is at risk if you do not keep up repayments on a mortgage or other loan secured on it.



GROUND FLOOR
847 sq.ft. (78.7 sq.m.) approx.

1ST FLOOR
711 sq.ft. (66.0 sq.m.) approx.

GARAGE
299 sq.ft. (27.8 sq.m.) approx.

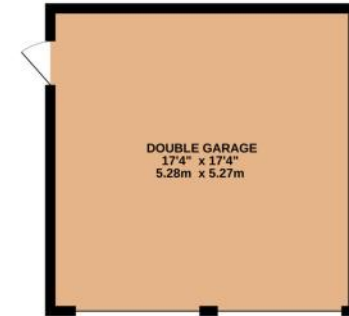
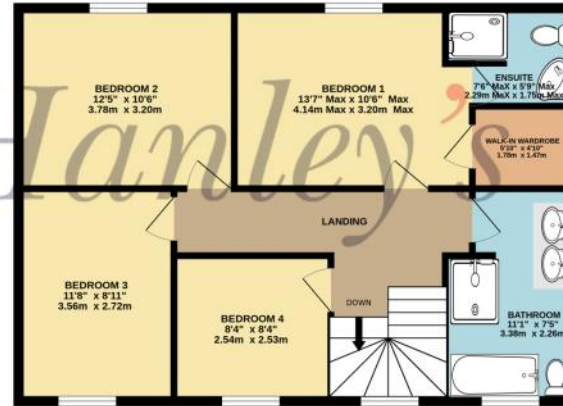

Hanley's Estate Agents
25 High Street, Highworth, SN6 7AG
Tel: 01793 762005 mail@hanleys.co.uk



