



Wood Vale, SE23

£795,000

This end-of-terrace home features three well-proportioned bedrooms and two reception rooms, offering flexible space for both living and entertaining. Requiring modernisation, it provides a clear opportunity to update and add value, making it well suited to buyers looking to personalise a home or invest. The property is chain free and conveniently located close to local stations, making it a practical choice for commuters.

Wood Vale is ideally positioned between Forest Hill and East Dulwich, with convenient access to Forest Hill and Honor Oak Park stations for direct links into London Bridge, Canada Water and beyond. The area is well known for its green surroundings, including Sydenham Woods and the popular Horniman Gardens. Residents also benefit from nearby independent shops, cafés and restaurants along Lordship Lane, as well as the much-loved Horniman Museum and Gardens.

Features

- End Of Terrace House
- Three Bedrooms
- Two Reception Rooms
- In Need Of Modernisation
- Close To Stations
- Chain Free

Wood Vale,
London, SE23

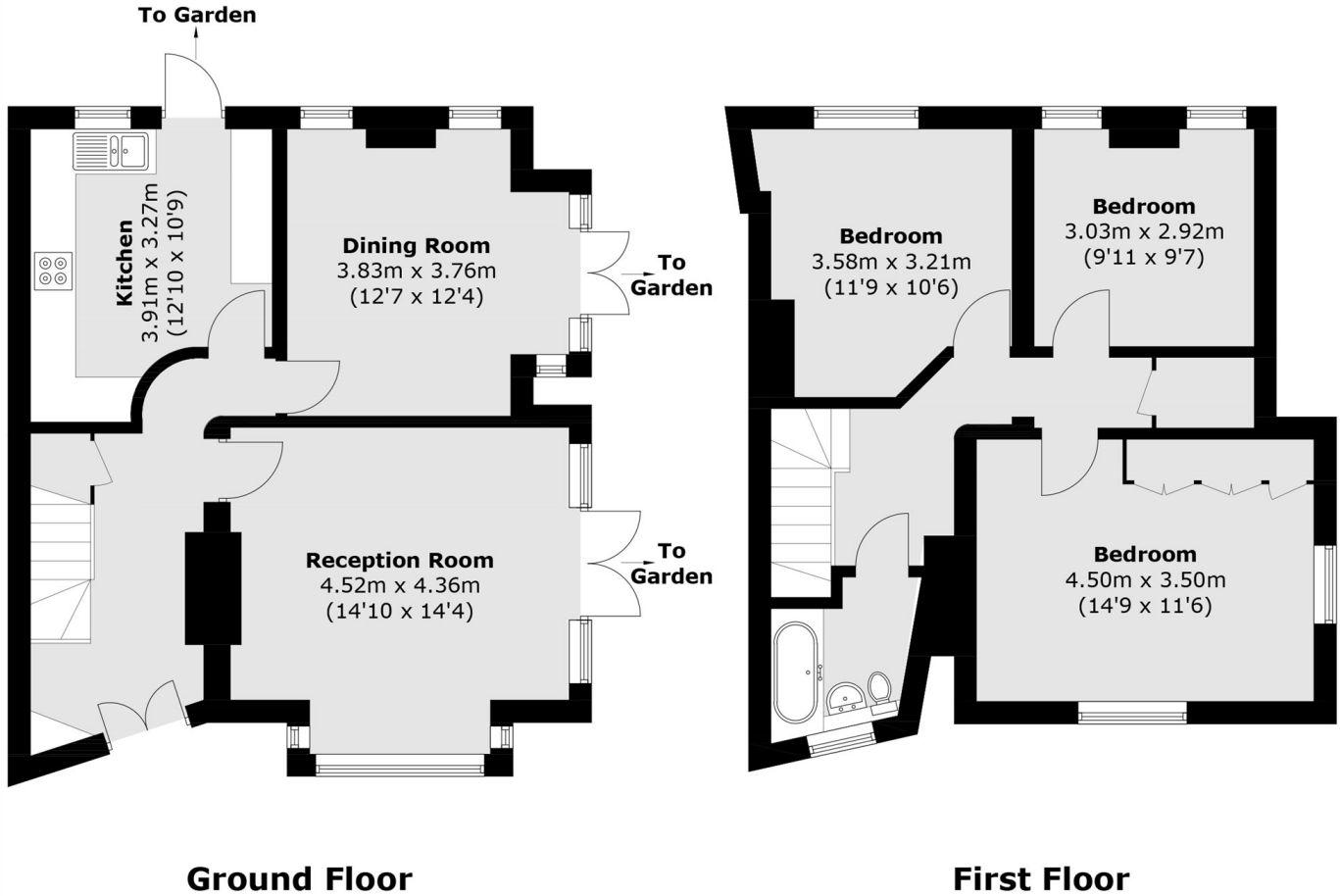

Total area (approx.): 107.5 sq. m (1,157.1 sq. ft)