



Wisbech Road, March PE15 8EB

welcome to

Wisbech Road, March

Get on the L-A-D-D-E-R ! ** NO ONWARD CHAIN ** Two Bedrooms - First Floor Bathroom
Generous Rear Garden - Fitted Kitchen - Viewing Recommended



Entrance Door

Living Room

Window to front. Door to front. Wooden flooring. TV point. Feature fireplace with marble effect hearth. Radiator.

Kitchen/Breakfast Room

Window to rear. Door to rear courtyard. Plumbing for washing machine. Gas central heating boiler (wall mounted). Single drainer sink with mixer taps. Radiator. Stairs leading off.

Bedroom One

Window to front. Radiator.

Bedroom Two

Window to rear. Radiator.

Bathroom

Window to rear. Pedestal wash hand basin. Heated towel rail. Panel bath with shower above. Low level w.c.

Outside

Front garden is fenced.

Workshop to rear with door to front and door to garden.

Rear garden is enclosed with small patio area and laid to grass.

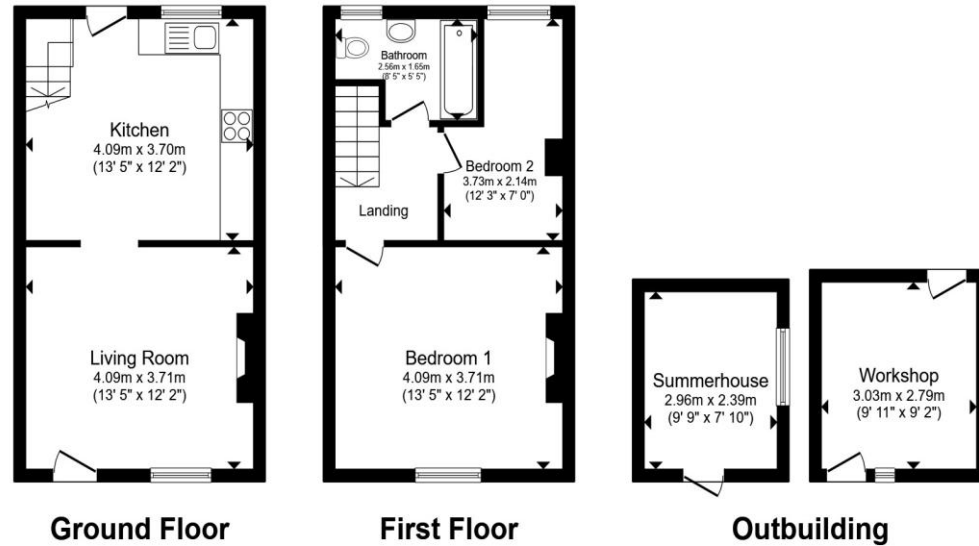

Total floor area 77.2 m² (831 sq.ft.) approx

This floor plan is for illustrative purposes only. It is not drawn to scale. Any measurements, floor areas (including any total floor area), openings and orientation are approximate. No details are guaranteed, they cannot be relied upon for any purpose and they do not form part of any agreement. No liability is taken for any error, omission or misstatement. A party must rely upon its own inspection(s). Powered by www.propertybox.io

william
h brown



view this property online williamhbrown.co.uk/Property/MCH114823



welcome to

Wisbech Road, March

- Mid Terraced House
- Two Bedrooms
- First Floor Bathroom
- Kitchen/Breakfast Room
- Convenient to Town Centre
- NO ONWARD CHAIN

Tenure: Freehold

EPC Rating: TBA

Council Tax Band: B

offers in excess of

£150,000



Please note the marker reflects the postcode not the actual property

view this property online [williamhbrown.co.uk/Property/MCH114823](https://www.williamhbrown.co.uk/Property/MCH114823)



Property Ref:
MCH114823 - 0002

1. MONEY LAUNDERING REGULATIONS Intending purchasers will be asked to produce identification documentation at a later stage and we would ask for your co-operation in order that there is no delay in agreeing the sale. 2. These particulars do not constitute part or all of an offer or contract. 3. The measurements indicated are supplied for guidance only and as such must be considered incorrect. Potential buyers are advised to recheck measurements before committing to any expense. 4. We have not tested any apparatus, equipment, fixtures or services and it is in the buyers interest to check the working condition of any appliances. 5. Where an EPC, or a Home Report (Scotland only) is held for this property, it is available for inspection at the branch by appointment. If you require a printed version of a Home Report, you will need to pay a reasonable production charge reflecting printing and other costs. 6. We are not able to offer an opinion either written or verbal on the content of these reports and this must be obtained from your legal representative. 7. Whilst we take care in preparing these reports, a buyer should ensure that his/her legal representative confirms as soon as possible all matters relating to title including the extent and boundaries of the property and other important matters before exchange of contracts.

William H Brown is a trading name of Sequence (UK) Limited which is registered in England and Wales under company number 4268443, Registered Office is Cumbria House, 16-20 Hockliffe Street, Leighton Buzzard, Bedfordshire, LU7 1GN. VAT Registration Number is 500 2481 05.



william h brown



01354 654545



march@williamhbrown.co.uk



34 High Street, MARCH, Cambridgeshire, PE15 9JR



[williamhbrown.co.uk](https://www.williamhbrown.co.uk)