

Floorplan

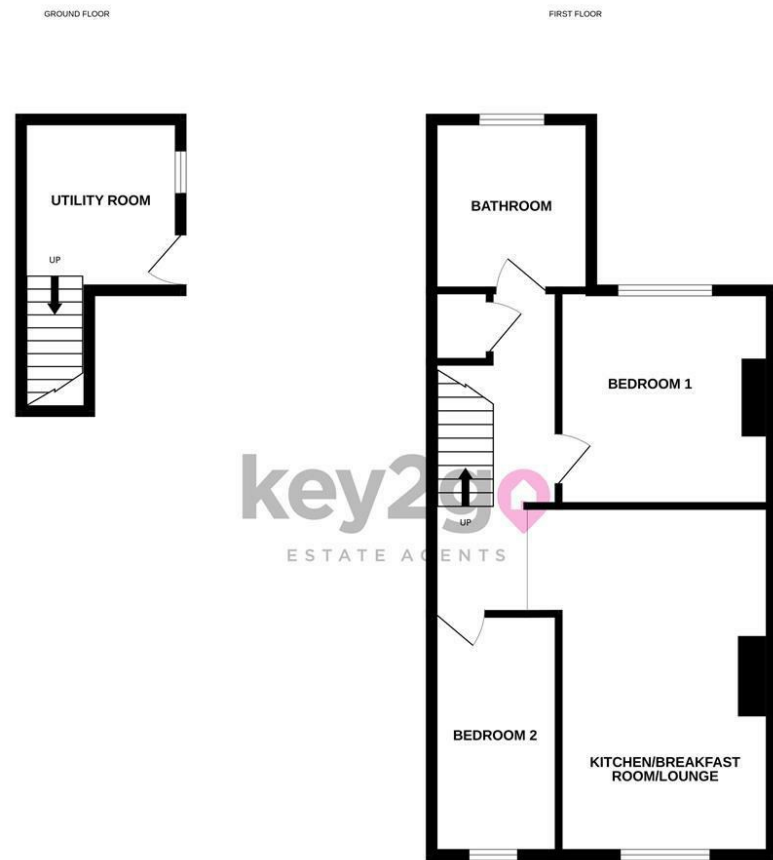

While every attempt has been made to ensure the accuracy of the floorplan contained here, measurements of doors, windows, rooms and any other items are approximate and no responsibility is taken for any error, omission or misstatement. This plan is for illustrative purposes only and should be used as such by any prospective purchaser. The services, systems and appliances shown have not been tested and no guarantee as to their operability or efficiency can be given. Made with Mapbox ©2025



Area Map

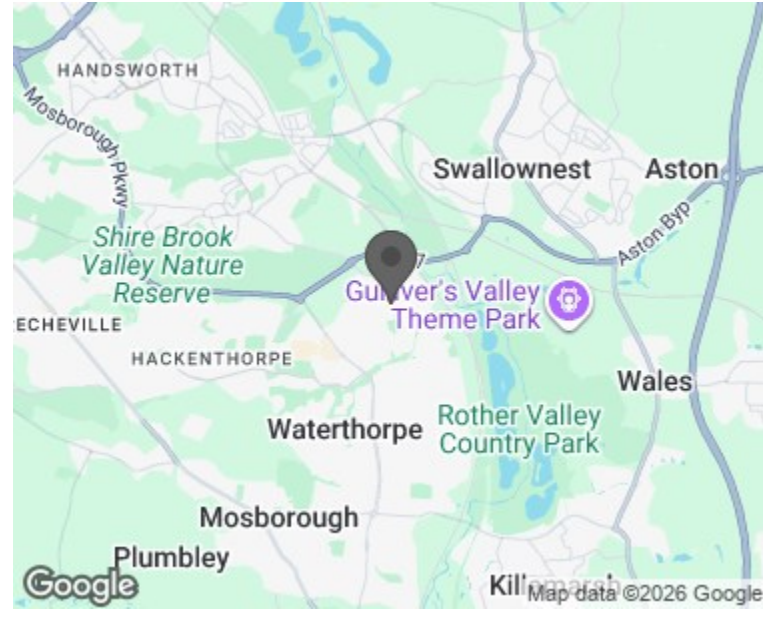

Energy Efficiency Graph

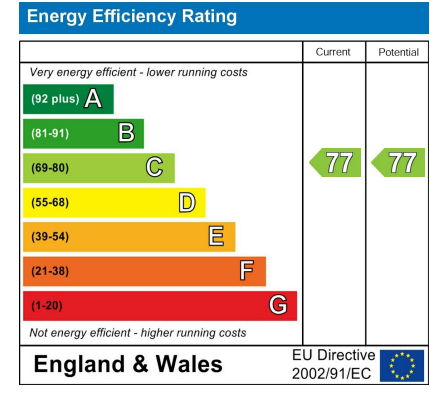

108B Manvers Road
Beighton, Sheffield, S20 1AY

£775 PCM



Viewing

Please contact our Lettings Team Office on 0114 2478819 if you wish to arrange a viewing appointment for this property or require further information.



These particulars, whilst believed to be accurate are set out as a general outline only for guidance and do not constitute any part of an offer or contract. Intending purchasers should not rely on them as statements of representation of fact, but must satisfy themselves by inspection or otherwise as to their accuracy. No person in this firm's employment has the authority to make or give any representation or warranty in respect of the property.

108B Manvers Road

Beighton, Sheffield, S20 1AY

£775 PCM



A fantastic and unique opportunity to rent this stunning and deceptively spacious, two bedroomed first floor apartment. Having an open plan living area with the added benefit of a stylish kitchen and bathroom. Parking for one small car to the rear and within walking distance to a choice of local amenities and public transport links. Ideal for a couple or single person!

