

Because life is

PettyTM
Real

77 Nora Street
Barrowford
Nelson
BB9 8NT



For Sale

£149,995

- Two-bedroom end terrace on Nora Street, Barrowford
- Within walking distance of shops, cafes, and bus routes
- Cosy lounge with feature fireplace and neutral décor
- Kitchen with fitted units and space for a small dining table
- Enclosed rear yard ideal for seating or container gardening
- Bedroom one with walk-in wardrobe (formerly an ensuite)

- Second double bedroom to the rear
- Three-piece bathroom with shower over bath
- Gas central heating and double glazing throughout
- Ideal for first-time buyers or downsizers in a sought-after location



Situated on Nora Street in the heart of Barrowford, this two-bedroom end terrace offers a fantastic opportunity for first-time buyers or those looking to downsize into a popular village location. The property is within walking distance of local shops, cafes, bus routes, and countryside walks, while also providing easy access to the M65 motorway network for commuting.

On entering the property, you are welcomed into a cosy lounge, providing a comfortable space to relax and unwind. The room benefits from a feature fireplace and a window to the front, allowing natural light to enhance the warm atmosphere. The neutral décor provides a blank canvas for a buyer to add their own style.

The kitchen is positioned to the rear of the property and is fitted with a range of matching wall and base units, offering ample storage and workspace. There is space for a small dining table, with a door leading out to the enclosed rear yard, providing a private outdoor area ideal for potted plants or seating.

To the first floor, there are two well-proportioned double bedrooms. Bedroom one benefits from a walk-in wardrobe, which was formerly an ensuite and could be reinstated subject to requirements. The second bedroom is positioned to the rear with pleasant rooftop views.

A three-piece bathroom suite completes the accommodation, featuring a panelled bath with shower over, low-level WC, and pedestal wash basin.

Externally the property benefits from a south facing yard and an abundance of on street parking to the front and side of the property.

With gas central heating, double glazing throughout and having had a full re-roof in 2022, this end terrace offers comfortable living in a desirable Barrowford location, making it a property well worth viewing.

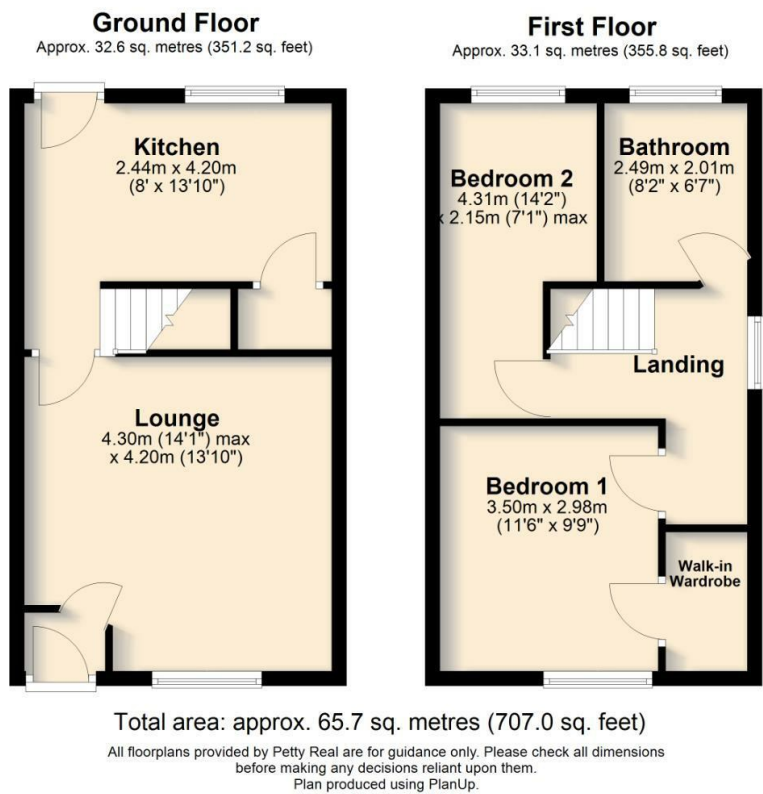

These particulars, whilst believed to be accurate are set out as a general outline only for guidance and do not constitute any part of an offer or contract. Intending purchasers should not rely on them as statements of representation of fact, but must satisfy themselves by inspection or otherwise as to their accuracy. No person in this firm's employment has the authority to make or give any representation or warranty in respect of the property.