

## One Crown Place

19 Sun Street, Shoreditch, EC2A 2FJ

£1,250 Per Week



## Floor Plan

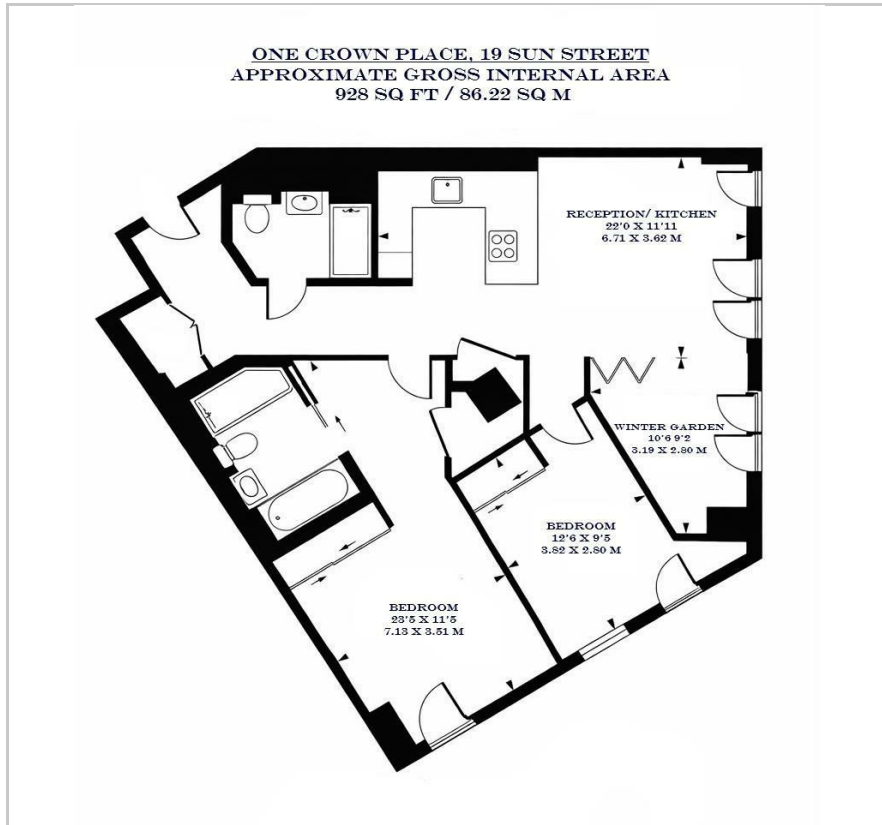

## Area Map



## Energy Efficiency Graph

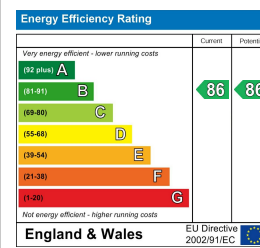

## Viewing

By appointment. Contact us on 0207 052 1075 if you wish to arrange a viewing appointment for this property, or require further information.

- Exceptional apartment
- Open plan reception area
- Residents' gym, cinema and terrace
- 928 sq ft (86 sqm)
- Winter garden
- 24 hour concierge

This exceptional two bedroom apartment, located in the highly sought after One Crown Place, is available for lease through Prime London.

Totalling 928 sq ft (86 sqm), the property boasts a generous open plan reception area and fully fitted kitchen with integrated appliances. A key feature of this apartment is the winter garden, which showcases floor to ceiling windows, allowing for excellent natural light throughout. Both bedrooms are large with built in wardrobe space and underfloor heating and cooling systems. The master bedrooms benefits from an ensuite and oak herringbone flooring.

One Crown Place offers its residents a private gym, cinema, terrace, and 24 hour concierge.

Positioned ideally between the City and Shoreditch, the apartment is located within easy reach of the financial district, as well as surrounded by some of London's best restaurants, cafes and boutiques.

For transport, One Crown Place, is just a short walk away from Liverpool Street Station, offering excellent transport links across the city and National Rail services.



These particulars, whilst believed to be accurate are set out as a general outline only for guidance and do not constitute any part of an offer or contract. Intending purchasers should not rely on them as statements of representation of fact, but must satisfy themselves by inspection or otherwise as to their accuracy. No person in this firm's employment has the authority to make or give any representation or warranty in respect of the property.