



St. Martin's Lane

London, WC2N

Asking Price £900,000

A beautifully presented two-bedroom apartment, quietly positioned within this well-maintained building in the heart of Covent Garden. Offered in excellent condition throughout, the property features a spacious reception room with large windows, a fully fitted separate kitchen, two generous double bedrooms with excellent built-in storage, including a principal bedroom with an en-suite shower room, together with a stylish family bathroom. Attractive solid beechwood flooring runs throughout, and the building benefits from lift access.

CHESTERTONS



St. Martin's Lane

London, WC2N

- Two double bedrooms
- Two bathrooms (one en-suite)
- Separate, fully fitted kitchen
- Excellent storage throughout
- Solid beechwood flooring
- Lift access
- No onward chain



Perfectly located to enjoy everything the West End has to offer, the apartment is just moments from Covent Garden Piazza, the Royal Opera House, Trafalgar Square and some of London's most celebrated museums, theatres, restaurants and shopping destinations. Despite its central location, the apartment enjoys a peaceful position within the building, providing a welcome retreat from the vibrant surroundings.

Excellent transport connections are available via several nearby Underground stations, offering convenient access across London and beyond. The Eurostar terminal and international airports are within easy reach. Offered to the market with no onward chain.

Tenure: Leasehold 970 years 6 months

Service Charge: £5,116

Ground Rent: £150

Local Authority: City Of Westminster

Council Tax Band: G

Chestertons Covent Garden Sales

196 Shaftesbury Avenue

London

WC2H 8JF

coventgarden@chestertons.co.uk

020 3040 8300

chestertons.co.uk

St. Martin's Lane

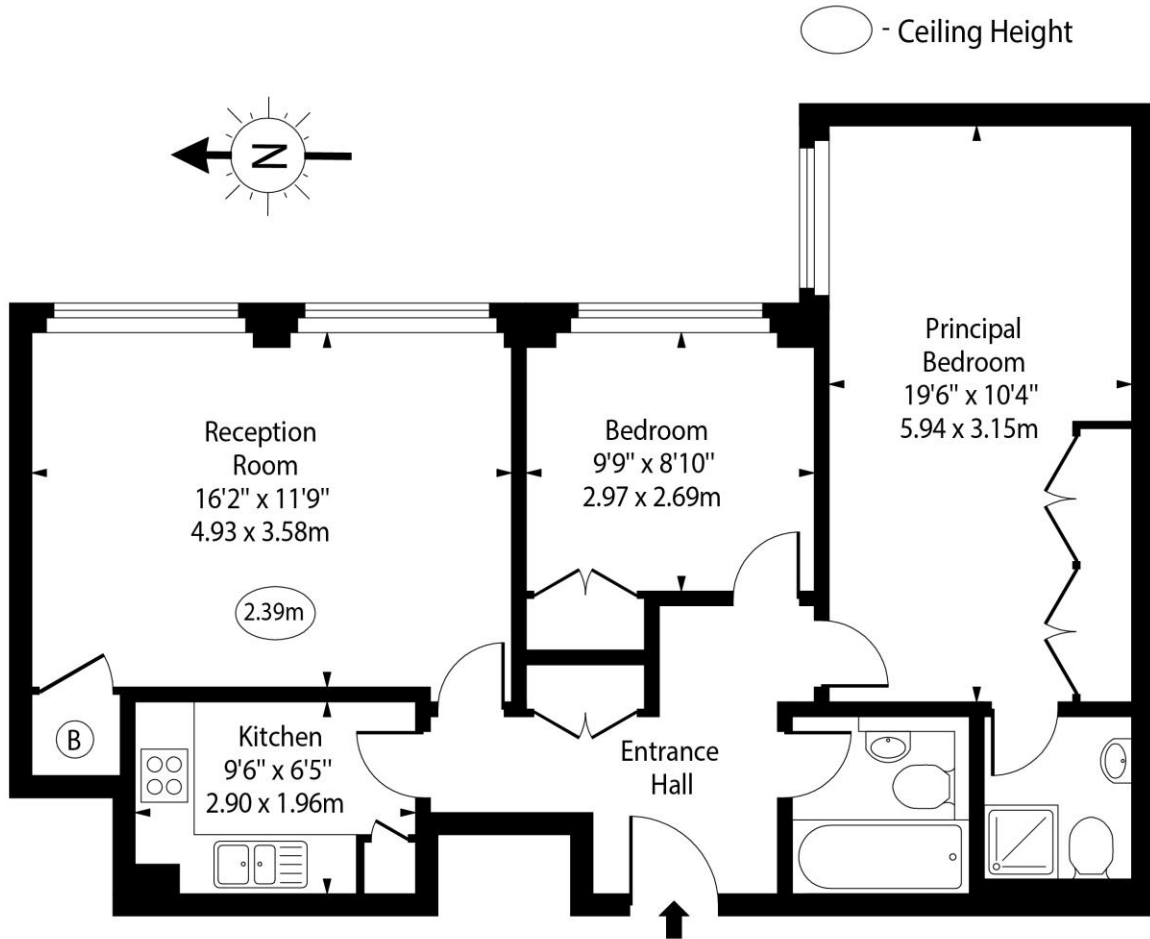

Second Floor

Approx Gross Internal Area 766 Sq Ft - 71.16 Sq M

For Illustration Purposes Only - Not To Scale