



KILBERRY CLOSE, TW7

£1,200 per month

This bright and spacious first floor studio has recently been refurbished throughout and is presented in immaculate condition.

Studio
Off-street parking
Modern

Unfurnished
Transport links
Energy rating: c

STEP INSIDE KILBERRY CLOSE

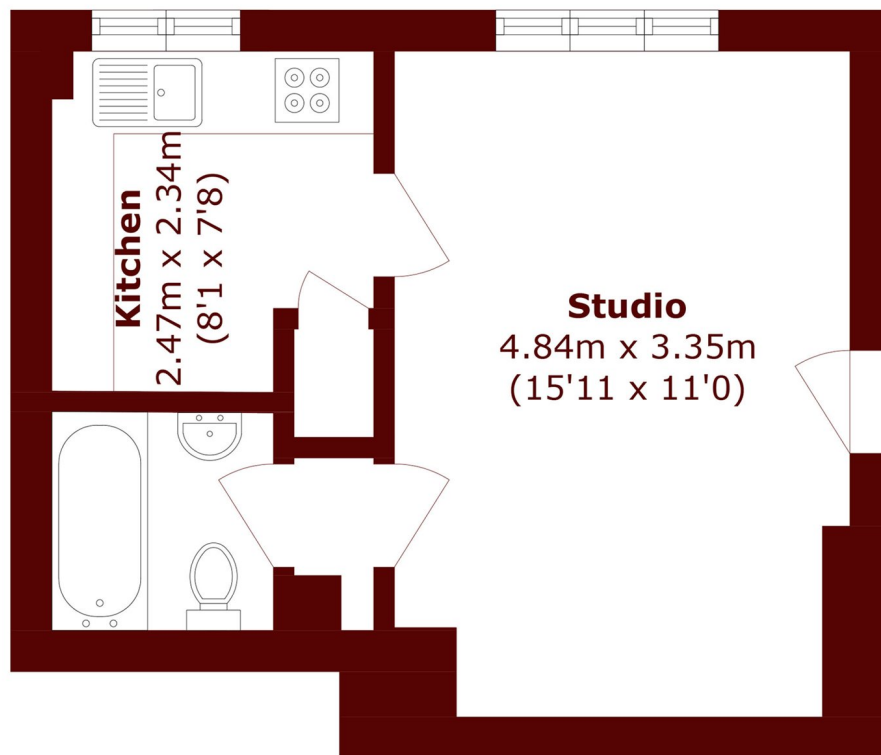

Total area (approx.): 26.5 sq. m (285.2 sq. ft)

Chiswick
020 8629 0900

Energy Rating: C We aim to make our particulars both accurate and reliable. However, they are not guaranteed; nor do they form part of an offer or contract. If you require clarification on any points then please contact us, especially if you're traveling some distance to view. Please note that appliances and heating systems have not been tested and therefore no warranties can be given as to their good working order

MARSH &
PARSONS