



5 Burford Close
Marlow

£625,000



Bedrooms: 3

Bathrooms: 1

Receptions: 2

A unique opportunity to put your finishing touches to this partially renovated detached home. Step inside to discover a spacious lounge and dining room, a perfect setting for both relaxation and entertaining, enhanced by the warmth of a wood burner and doors that open onto a charming, private garden. The newly fitted kitchen awaits its final flourish of flooring, with a pantry cupboard and a practical utility/laundry room adjacent. Downstairs also offers a double bedroom and a new, fully tiled family bathroom with a large walk-in shower. Upstairs, the master bedroom is ready for transformation, with plumbing already in place for an en-suite bathroom, offering an ideal blank canvas to finish to your own taste. Across the landing there is a further double bedroom. New carpeting will be required for all of upstairs.

Outside, the property benefits from a garage and off-street parking. The location is a true highlight, with Burford Primary School, a children's park/playing fields just a two-minute walk away. Enjoy the convenience of being close to village amenities and idyllic woodland walks, all whilst being within the catchment area for excellent schools. This home offers a superb blend of comfortable living and potential for customisation in a quiet cul de sac. Don't miss the chance to make this house your perfect home; arrange a viewing to fully appreciate the possibilities.



Approximate Gross Internal Area 1273 sq ft - 118 sq m

Ground Floor Area 948 sq ft – 88 sq m

First Floor Area 325 sq ft – 30 sq m

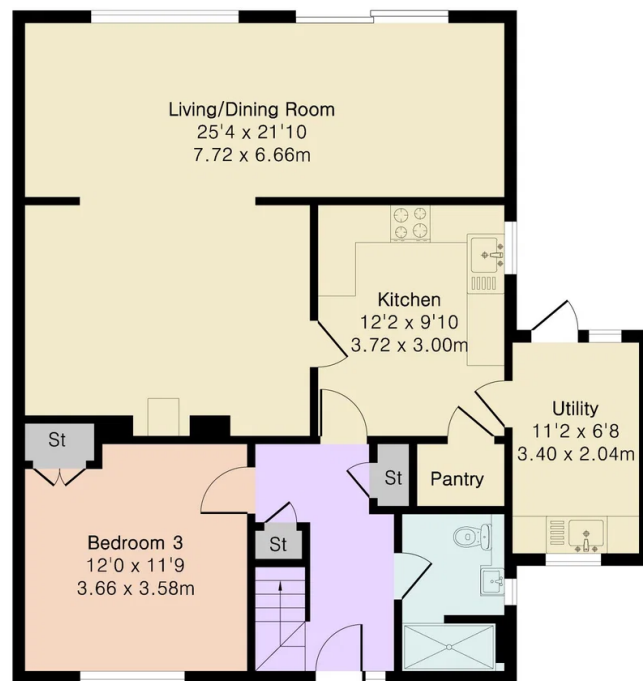

Ground Floor

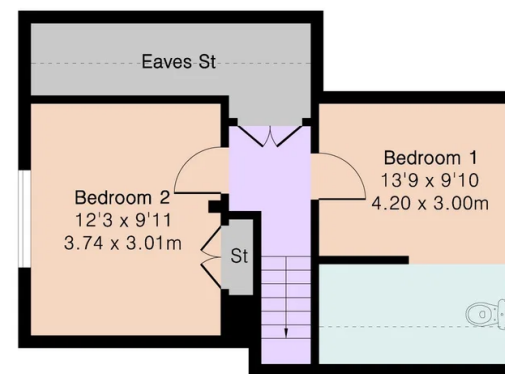

First Floor



Floor plan produced in accordance with RICS Property Measurement 2nd Edition. Although Pink Plan Ltd ensures the highest level of accuracy, measurements of doors, windows and rooms are approximate and no responsibility is taken for error, omission or misstatement. These plans are for representation purposes only and no guarantee is given on the total square footage of the property within this plan. The figure icon is for initial guidance only and should not be relied on as a basis of valuation.



Barrett Move

42 Marlow Bottom, Marlow, Bucks

01628 876333

reception@barrettmove.co.uk

<https://www.barrettmove.co.uk/>