



Development Site

Wesley Road, Cherry Willingham, Lincoln

BROWN & CO



Development Site, Wesley Road, Cherry Willingham

The site comprises level regular shaped parcel of land extending to 1.14 acres on the North Western edge of the popular village of Cherry Willingham. The site has Full Planning Permission for the erection of 20 affordable residential units, subject to completion of a S.106 Agreement, which is imminent.

The site has vehicular and pedestrian access into via Wesley Road which forms part of a residential scheme developed in recent years by a number of local builders. The main access into the site is off Hawthorn Road which offers easy access to the newly formed Lincoln Eastern bypass.

The surrounding area to the north of the site is predominantly residential in character, with the remainder of the land to the south, east and west forming open farmland.



Location

Cherry Willingham is a well-regarded village situated close to Lincoln City Centre, offering a good range of local amenities, including junior and senior schools, a Co-op convenience store, pharmacy and post office, together with pubs and other shopping facilities, all of which are within easy walking distance of the subject site. The village has a population of circa 4,000 and nearby villages include Reepham and Fiskerton to the east, both of which share local amenities with Cherry Willingham.

Town & Country Planning

The site has been granted Full Planning Permission for the erection of 20 affordable units under Planning reference number 145735 by West Lindsey District Council. The issuing of the Decision Notice is pending, subject to completion of a S.106 Agreement, which we understand from the vendor is imminent. Full details of the Planning Application, supporting documentation and reports can be accessed via West Lindsey District Council planning portal.

Legal Costs

Each party is to be responsible for their own legal costs incurred in documenting the transaction.

VAT

VAT may be charged in addition to the price at the prevailing rate.

Services

We understand that all mains supplies of water, drainage, electricity and gas are available within the immediate vicinity of the site, with the connection points into the main supplies for water, electricity and gas found in the roadway immediately to the north of the site, ready for a purchaser to connect into following completion.

There is a pumping station that was constructed by the vendors located immediately to the north east of the site, which a purchaser will be entitled to connect into in order to deal with site drainage. These various services have not been tested and interested parties are therefore advised to make their own investigations to the relevant utility service providers. We further understand that all of the roadways running through the estate have been constructed to an adoptable standard by the developers, ready for adoption by the Local Authority on completion of the final phases of the scheme, of which the subject land forms the last part.

Tenure & Possession

Freehold and for sale by private treaty.

Buyer Identity Check

Please note that prior to acceptance of any offer, Brown&Co are required to verify the identity of the buyer to comply with the requirements of the Money Laundering, Terrorist Financing and Transfer of Funds (Information on the Payer) Regulations 2017. Further, when a property is for sale by tender, an ID check must be carried out before a tender can be submitted. We are most grateful for your assistance with this.

Viewing Procedure

The land may be viewed during daylight hours with a copy of particulars to hand

Broadband & Mobile

We understand from the Ofcom website that standard and superfast broadband are available in the area with a max download speed of 80mbps and max upload speed of 20 mbps. Mobile coverage varies from each provider so interested parties are advised to make their own enquires via their providers website.





NOTES

- 1. No dimensions are to be scaled from this drawing.
- 2. Dimensions are to be measured from the plan.



Rev	Date	Description	By
A01	20/12/22	Updated to suit highways comments	AS
A00	17/08/22	Issued For Planning	NB

Drawn: [Name] Checked: [Name]

PLANNING

LK2

Studio One, Chesapeake Enterprise Park,
Baltimore, MD
410.551.1234
www.lk2.com

1. 11/12/2022
2. 11/12/2022
3. 11/12/2022

Client Logo

Client: Cherry Tree Homes

Project: 20 Affordable Homes,
Wesley Road,
Cherry Willingham

Proposed Block Plan 1-500

Scale	Drawn By	Checked By
1:500	24/08/22 RK	NB

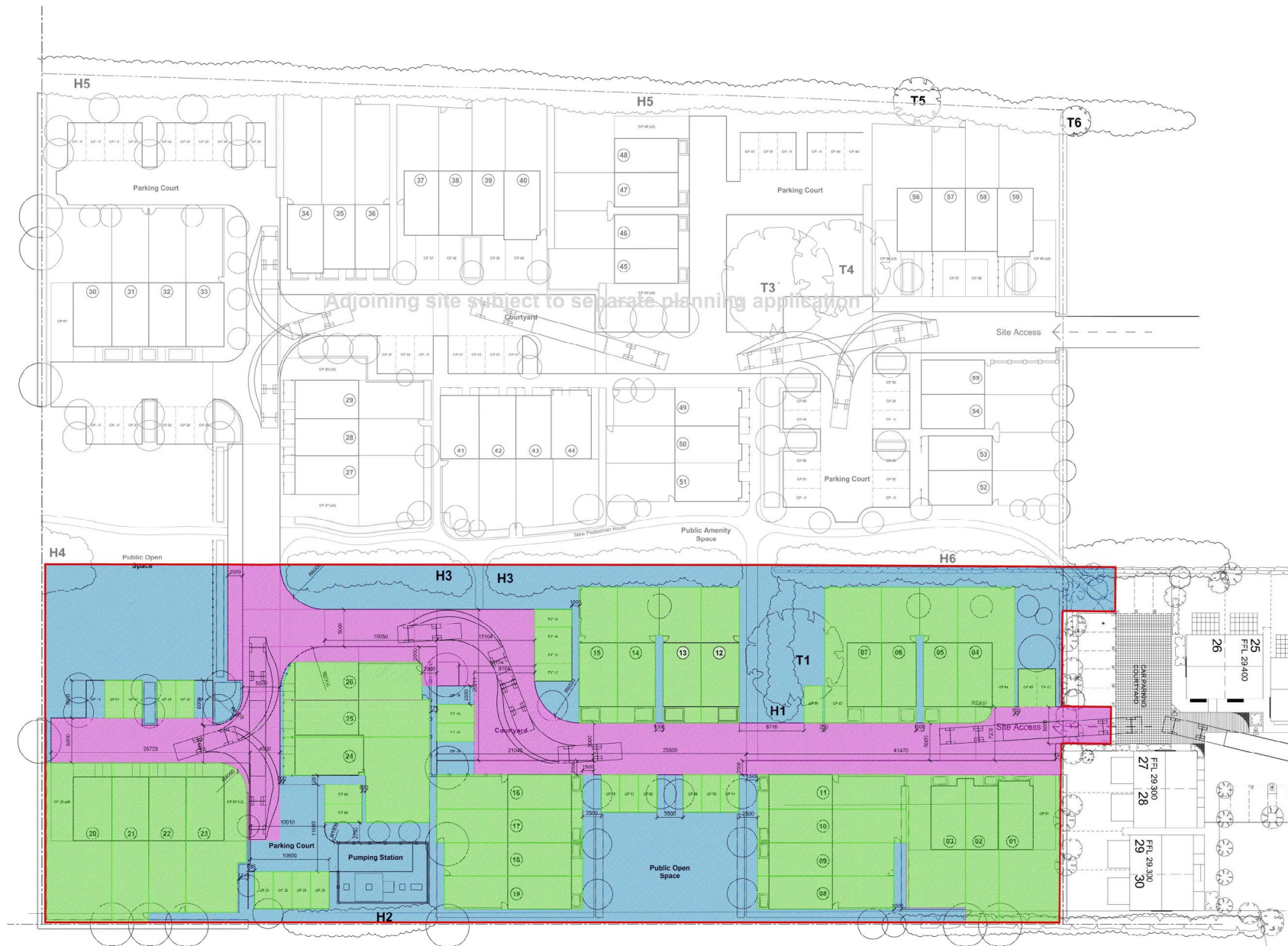

NOTES

1. No dimensions are to be scaled from this drawing.
2. All dimensions are to be checked on site prior to construction.

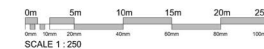

KEY

- Adoptive Highway Boundary
- Private Areas
- Shared private areas, amenity areas, bin stores subject to a management agreement
- Swept Paths for Fire Engine
- Application Boundary

NOTE - Footpaths to be at same level as roads

A03	18.05.2016	Phase 1 indicated on drawing
A02	28.02.2015	red line, road layout to south east corner
A01	18.02.2015	Swept paths, dimensions, red line
Revision	Date Issued	Details

PLANNING

LK2
Studio 2, Deepdale Enterprise Park,
Deepdale Lane,
Nottingham, Lincoln
LN2 2LL
Tel: 01522 750777
Fax: 01522 754061
E-mail: info@lk2.co.uk
Web: www.lk2.co.uk

Approved by Planning Department: May 2016. Drawn by: Studio 2, Deepdale Enterprise Park, Deepdale Lane, Nottingham, Lincoln, LN2 2LL.

Client Logo

Client
Cherry Tree Homes

Project
Phase 2 Residential Development
Hawthorne Road
Cherry Willingham
Title
Proposed Site Layout Plan
Adoptable Roads, Private Areas and Shared Private Areas

Scale 1:250 at A1	Date February 2015	Drawn by AJS
Project No. LK662	Drawing No. (08) 018	Revision A03



Directions - LN3 4GT
 From the Lincoln Eastern Bypass follow Hawthorn Road
 towards Cherry Willingham. As you reach the village turn right
 onto Cherry Paddocks. Follow the road to the end and turn left.
 Finally turn right and you will reach the entrance to the site.

<https://what3words.com/gent.lists.dollar>

Agent
 James Mulhall
 01522 504304
lincolnresidential@brown-co.com

IMPORTANT NOTICES
 Brown&Co for themselves and for the Vendors or Lessors of this Property give notice that: 1. These particulars are intended to give a fair and accurate general outline only for the guidance of intending Purchasers or Lessees and they do not constitute an offer or contract or any part of an offer or contract. 2. All descriptions, dimensions, references to condition and other items in these Particulars are given as a guide only and no responsibility is assumed by Brown&Co for the accuracy of individual items. Intending Purchasers or Lessees should not rely on them as statements or representations of fact and should satisfy themselves as to the correctness of each item by inspection or by making independent enquiries. In particular, dimensions of land, rooms or buildings should be checked. Metric/imperial conversions are approximate only. 3. Intending Purchasers or Lessees should make their own independent enquiries regarding use or past use of the property, necessary permissions for use and occupation, potential uses and any others matters affecting the property prior to purchase. 4. Brown&Co, and any person in its employ, does not have the authority, whether in these Particulars, during negotiations or otherwise, to make or give any representation or warranty in relation to this property. No responsibility is taken by Brown&Co for any error, omission of mis-statement in these particulars. 5. No responsibility can be accepted for any costs or expenses incurred by intending Purchasers or Lessees in inspecting the property, making further enquiries or submitting offers for the Property. 6. All prices are quoted subject to contract and exclusive of VAT, except where otherwise stated. 7. In the case of agricultural property, intending purchasers should make their own independent enquiries with the RPA as to Basic Payment Scheme eligibility of any land being sold or leased. 8. Brown&Co is the trading name of Brown&Co - Property and Business Consultants LLP. Registered Office: The Atrium, St Georges St, Norwich NR3 1AB. Registered in England and Wales. Registration Number OC302092.

BROWN & CO
 Property and Business Consultants