



Woodberry Grove, N4

£725,000

An exceptional three bedroom apartment available on the 80th floor of Residence Tower, located within the sought after Woodberry Down development. This premier property features a private balcony and panoramic views.

Close to excellent transport links with Manor House Station (Picadilly line) 0.2m away. The local area provides a nature reserve and parks, along with an array of local shops, cafes and restaurants to enjoy.

Features

- Private Balcony
- Amazing Views
- Three Double Bedrooms
- Bike Storage
- Two Bathrooms
- 24hr Concierge

Woodberry Grove, London, N4

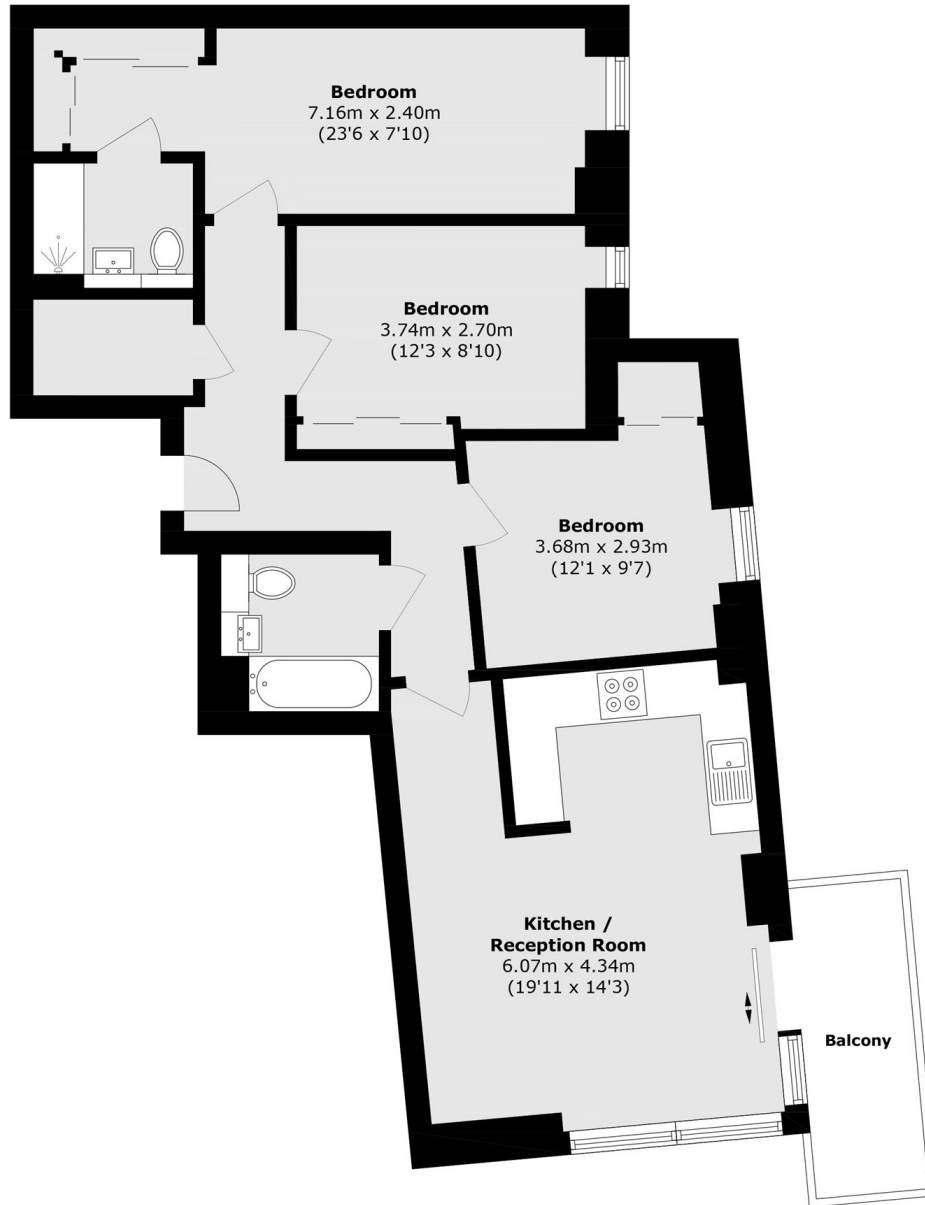

Total area (approx.): 86.7 sq. m (933.2 sq. ft)
Balcony area (approx.): 5.8 sq. m (62.4 sq. ft)