



Salisbury House, 5 Palmer Road

, London SW11 4FX

- One-bedroom, one-bathroom apartment
 - 24-hour concierge
 - Landscaped gardens and courtyards
- Battersea Power Station Underground Station
 - CTB-D
- Bright open-plan living and dining area
 - Fully equipped gym
- Nine Elms Station (Northern Line)
 - EPC-B

£3,250 Per Month



Local Authority **Wandsworth**
Council Tax Band **D**
EPC Rating **B**

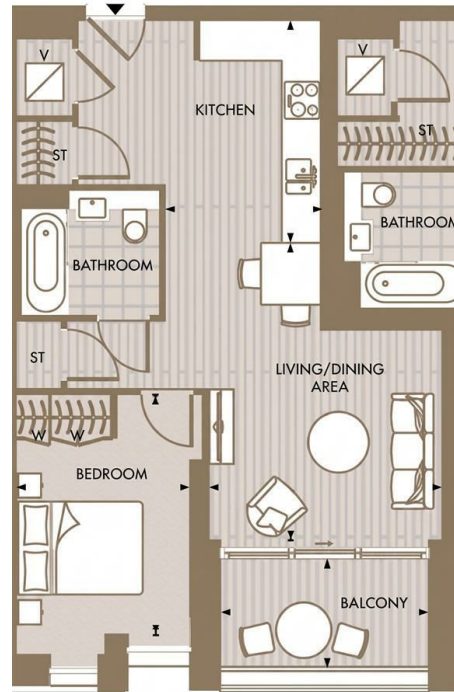

TYPE
C1D

Salisbury House 1 Bed Apartment



London Office Office
Spaces Victoria, 25 Wilton Road, Pimlico,
London, SW1V 1LW

Contact
020 3084 3094
XL@londonvictoriagroups.co.uk
www.londonvictoriagroups.co.uk

Agents Note: Whilst every care has been taken to prepare these particulars, they are for guidance purposes only. All measurements are approximate and for general guidance purposes only and whilst every care has been taken to ensure accuracy, they should not be relied upon and potential buyers/tenants are advised to recheck the measurements.