



**HIGH STREET BANBURY OX16**  
**£1,200 PER MONTH** AVAILABLE 29/05/2026

**Hamptons**  
THE HOME EXPERTS

# { THE PARTICULARS

High Street Banbury OX16

£1,200 Per Month  
Unfurnished

-  1 Bedroom
-  1 Bathroom
-  1 Reception

## Features

- Brand new development in Banbury, -
- Open plan kitchen/ reception, - Bedroom, -
- Bathroom, - Sash windows, - Storage
- space, - Video entry system, - Long let

## Council Tax

Council Tax Band A

Hamptons  
44 Market Place  
Banbury, OX16 5NW  
01295 277882  
banburylettings@hamptons.co.uk  
www.hamptons.co.uk

# { A TOP FLOOR ONE BEDROOM APARTMENT AVAILABLE TO LET IN BANBURY

## The Property

Thoughtfully restored and retaining many period features, this one bedroom property is available for long term let. This apartment is situated on the top floor, and boasts a tastefully designed open plan kitchen reception room with fully integrated appliances. There is a spacious bedroom with built in storage, alongside a well presented bathroom. The building has a video entry system, and each apartment has a storage space designated to the property which will be shown upon viewing. Council Tax: Cherwell, Band A

## Location

The Old Bank is a Grade II listed building, located on the High Street in Banbury. The building has very recently undergone a full renovation, and has been lovingly restored to provide four brand new apartments, all of which are available to let. Conveniently located, the Old Bank is situated within an approx. 10 minute walk to Banbury train station which provides main line services in to London Marleybone and Birmingham New Street, and also connects local stations, as well as services to Bicester Village, Oxford and beyond.



# High Street, Banbury, OX16

Approximate Area = 571 sq ft / 53 sq m

For identification only - Not to scale

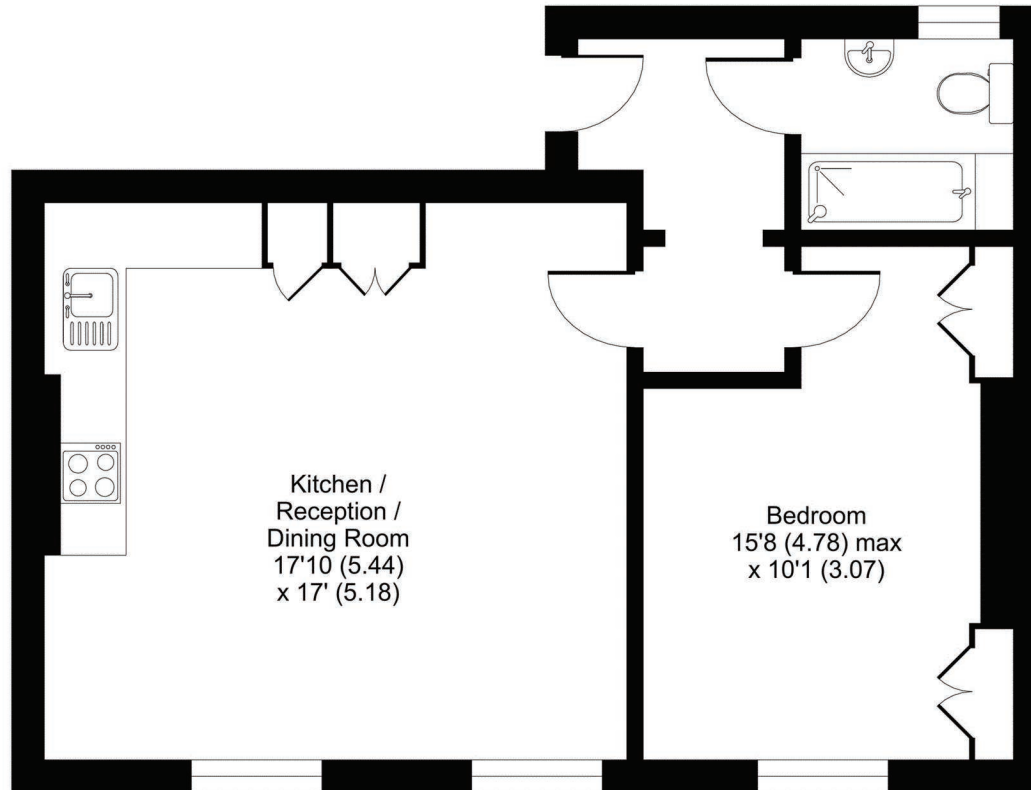

**SECOND FLOOR**



Floor plan produced in accordance with RICS Property Measurement Standards incorporating International Property Measurement Standards (IPMS2 Residential). © nichecom 2022. Produced for Hamptons. REF: 923408

## For Clarification

We wish to inform prospective tenants that we have prepared these particulars as a general guide and they have been confirmed as accurate by the landlord. We have not verified permissions, nor carried out a survey, tested the services, appliances and specific fittings. Room sizes are approximate and measurement figures rounded: they are taken between internal wall surfaces and therefore include cupboards/shelves, etc. Accordingly, they should not be relied upon for

carpets and furnishings. It should also be noted that all fixtures and fittings, carpeted, curtains/blinds, kitchen equipment and garden statuary, whether fitted or not, are deemed removable by the landlord unless specifically itemised with these particulars. Please enquire in office or on our website for details on holding deposit and tenancy deposit figures.

