



## Methuen Park, N10

£450,000

Situated on the raised ground floor of this converted Edwardian house is this delightful one bedroom flat. This property benefits from an immaculate finish throughout with a large open plan kitchen/living space providing direct access out to a private rear garden. This home also comprises a large double bedroom with built in storage and a modern bathroom.

Located within a short walk from Muswell Hill Broadway with its vast array of shops and restaurants and bus services to Highgate tube (Northern line), also close at hand is Alexandra Park, Palace and its Great Northern station along with some of North London's best public schools.

### Features

- One Bedroom
- Ground Floor
- Private Garden
- Edwardian Conversion
- Leasehold
- Period Features

# Methuen Park, LONDON, N10

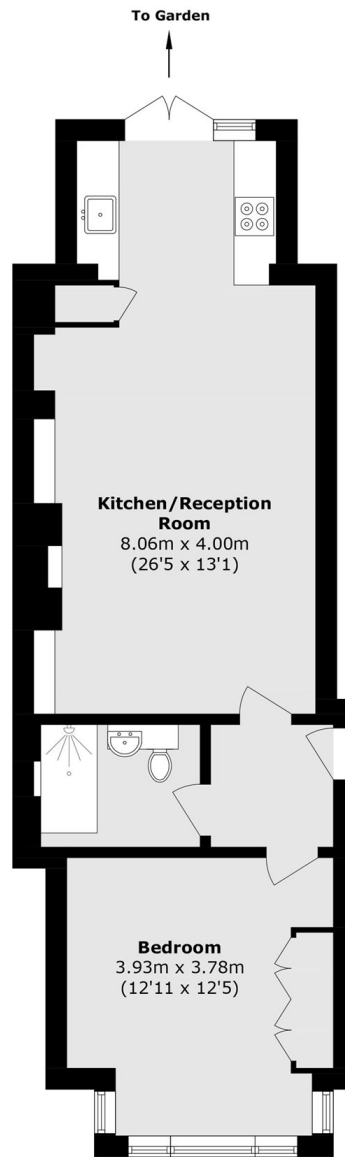

Total area (approx.): 52.7 sq. m (567.2 sq. ft)