



Connells

Hawbush Road
Brierley Hill



Property Description

AN IMPRESSIVE, GOOD SIZE SEMI DETACHED PROPERTY. DRIVEWAY TO SIDE. LARGE PLOT WITH LARGE REAR GARDEN. MUCH IMPROVED BY ITS CURRENT OWNER & READY TO MOVE INTO. Briefly comprises; hall, lounge, dining kitchen to the ground floor and two bedrooms and bathroom on the first floor. Benefiting from double glazing, gas central heating, driveway and rear garden.

To The Front

Fenced courtyard area with pathway leading to front door. Driveway to side. Gate to rear garden.

Entrance Hallway

Double glazed door to the front elevation, double glazed window to the side elevation, radiator and doors to;

Lounge

13' 7" x 12' (4.14m x 3.66m)
Double glazed bow window to the front elevation, electric fireplace and radiator.

Kitchen

17' x 7' 5" (5.18m x 2.26m)
Double glazed windows to the rear and side elevations, wall and base units, worktops with inset sink/drain, electric oven/gas hob, washing machine tumble dryer, double glazed french doors to the rear elevation and radiator.

Landing

Double glazed window to the side elevation, access to insulated loft space and doors to bedrooms and bathroom.

Bedroom One

13' 9" max narrowing to 12' 6" min x 10' (4.19m max narrowing to 3.81m min x 3.05m)
Two double glazed windows to the front elevation, overstairs storage and radiator.

Bedroom Two

10' 10" x 9' 6" (3.30m x 2.90m)
Double glazed window to the rear elevation and radiator.

Bathroom

Double glazed window to the rear elevation and suite comprising; bath, power shower, wash hand basin, wc, extractor fan and radiator rail.

Rear Garden

Good size, fully enclosed rear garden. Patio area leading to lawn.



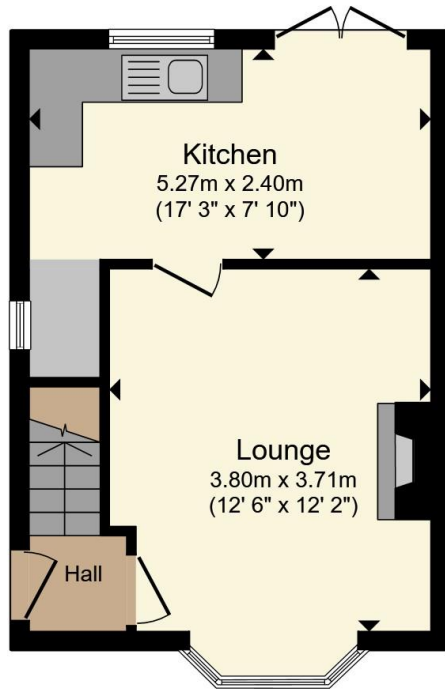

Ground Floor

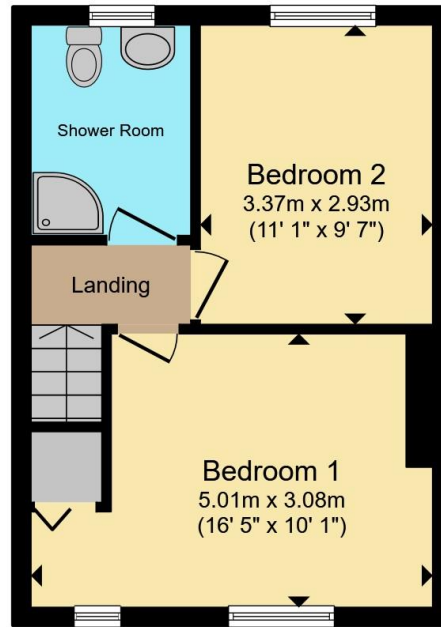

First Floor

Total floor area 60.0 m² (646 sq.ft.) approx

This floor plan is for illustrative purposes only. It is not drawn to scale. Any measurements, floor areas (including any total floor area), openings and orientation are approximate. No details are guaranteed, they cannot be relied upon for any purpose and they do not form part of any agreement. No liability is taken for any error, omission or misstatement. A party must rely upon its own inspection(s). Powered by www.propertybox.io



To view this property please contact Connells on

T 01384 374 545
E stourbridge@connells.co.uk

11B St. Johns Road
STOURBRIDGE DY8 1EJ

EPC Rating: D Council Tax
Band: A

view this property online connells.co.uk/Property/SBR313288

Tenure: Freehold



1. MONEY LAUNDERING REGULATIONS Intending purchasers will be asked to produce identification documentation at a later stage and we would ask for your co-operation in order that there will be no delay in agreeing the sale. 2. These particulars do not constitute part or all of an offer or contract. 3. The measurements indicated are supplied for guidance only and as such must be considered incorrect. Potential buyers are advised to recheck measurements before committing to any expense. 4. We have not tested any apparatus, equipment, fixtures, fittings or services and it is in the buyers interest to check the working condition of any appliances.

Connells Residential is registered in England and Wales under company number 1489613, Registered Office is Cumbria House, 16-20 Hockliffe Street, Leighton Buzzard, Bedfordshire, LU7 1GN. VAT Registration Number is 500 2481 05.

See all our properties at www.connells.co.uk | www.rightmove.co.uk | www.zoopla.co.uk

Property Ref: SBR313288 - 0003