

Symonds  
& Sampson

# 1 Sherrings Green Close

Puddletown, Dorchester, Dorset

# 1 Sherrings Green Close

Puddletown, Dorchester  
Dorset, DT2 8GZ

This spacious five-bedroom attached home has been thoughtfully extended and features a stylish, modern interior, complemented by a detached double garage and private driveway.



- Quiet village location
- Spacious five-bedroom family home
- Three bathrooms including en-suite
  - Two generous reception rooms
    - Refitted kitchen with island
- Private garden with seating areas
- Detached double garage parking
  - Excellent order throughout

Guide Price **£625,000**

Freehold

Dorchester Sales  
01305 261008  
dorchester@symondsandsampson.co.uk



## THE PROPERTY

This traditionally-built modern home is conveniently situated in a small quiet close in the centre of the sought-after village of Puddletown.

Unusually spacious, this attached property is ideal for family living offering two reception rooms, a generous kitchen/dining room, five bedrooms and three bathrooms. The accommodation is well-presented and benefits from significant recent expenditure on new kitchen/dining room and bathrooms, replacement gas heating boiler.

The versatile ground floor features an impressive light and bright sitting room with vaulted ceiling, exposed beams and two pairs of French doors opening onto the patio and garden. A second, equally spacious reception room is adaptable to meet a range of family needs.

The kitchen/dining room has recently been renovated with extensive bespoke cabinetry and quartz worktops, Karndean flooring. It incorporates a useful island/breakfast bar. Appliances include built-in dishwasher and microwave, large freestanding fridge-freezer and electric range cooker.

There is a separate utility room providing further storage and space for a washing machine, with a separate ground floor WC.

On the first floor are three light, well-presented double bedrooms, all of which have fitted wardrobes. One bedroom on this level

benefits from an en-suite shower room; the other two from the recently remodelled family bathroom.

The family bathroom has a contemporary white suite with vanity basin, WC and free-standing bath with wall mounted taps, separate shower enclosure, tastefully tiled, with heated towel rail and linen cupboard.

On the second floor are two further bedrooms and a recently refitted en-suite bathroom. This floor offers further scope for a range of uses.

## OUTSIDE

The manageable garden's mature shrubs and trees offer privacy and seclusion. Mostly laid to lawn, a gravelled path leads to a terrace and seating area. A further secluded patio, edged with raised well-stocked beds, abuts the house.

There is a gated driveway with off-road parking and a detached double garage.

## SITUATION

Puddletown is well served with an array of local amenities, including village shop/post office, doctor's surgery, veterinary practice, village hall, community library and The Blue Vinny pub. The village is home to a pre, primary and middle school and has a recreational ground with cricket pitch, sports pavilion and children's play area.

The village is located in the heart of Dorset and benefits from charming views of the surrounding countryside, with easy access to a network of footpaths/bridleways and Puddletown Forest to the west. The Jurassic Coastline is a few miles to the south with some sandy beaches, outstanding walks and the opportunity to enjoy a variety of water sports.

The historic county town of Dorchester is less than 5 miles away and has a variety of restaurants, shops and leisure facilities, meeting everyone's needs, including mainline railway stations with services to London Waterloo and Bristol Temple Meads. The A35 gives access to Dorchester/Weymouth and Poole/Bournemouth areas and there are cross channel ferries at Poole.

## DIRECTIONS

[what3words///publish.worldwide.finely](https://www.what3words.com/publish.worldwide.finely)

## SERVICES

Mains water, drainage, gas and electricity are connected. Gas fired central heating

Broadband - Superfast speed available

Mobile - There is mobile coverage in the area, please refer to Ofcom's website for more details. (<https://www.ofcom.org.uk>)

Council Tax Band: F (Dorset Council - 01305 251010)

## MATERIAL INFORMATION

Photos were taken in May 2026.



# Puddletown, Dorchester

Approximate Area = 2066 sq ft / 191.9 sq m

Garage = 360 sq ft / 33.4 sq m

Total = 2426 sq ft / 225.3 sq m

For identification only - Not to scale

Energy Efficiency Rating		Current	Potential
Very energy efficient - lower running costs			
(92 plus) A			
(81-91) B			
(69-80) C		77	80
(55-68) D			
(39-54) E			
(21-38) F			
(1-20) G			
Not energy efficient - higher running costs			
England & Wales		EU Directive 2002/91/EC	

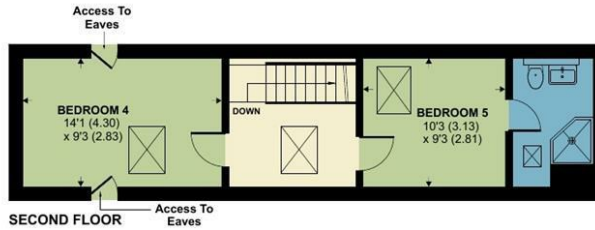
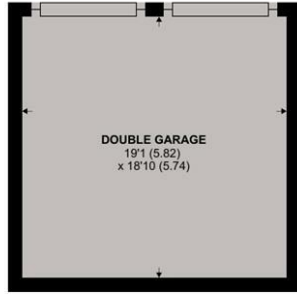

Floor plan produced in accordance with RICS Property Measurement 2nd Edition, Incorporating International Property Measurement Standards (IPMS2 Residential). © nichecom 2026. Produced for Symonds & Sampson. REF: 1465681



Dorchester/SXP/09.06.2026



01305 261008

dorchester@symondsandsampson.co.uk  
Symonds & Sampson LLP  
9 Weymouth Avenue, Brewery Square,  
Dorchester, Dorset DT1 1QR



**Important Notice:** Symonds & Sampson LLP and their clients give notice that they have no authority to make or give any representations or warranties regarding the property. These particulars do not form part of any offer or contract and must not be relied upon as statements of fact. Some descriptions and images may have been AI-assisted; while reviewed for accuracy, interested parties should verify key details through inspection or by contacting our agents. All measurements and distances are approximate. Text, photographs, and plans are for guidance only and may not be comprehensive. It should not be assumed that the property has all necessary planning or regulatory consents, and no services, equipment, or facilities have been tested. No investigations have been made into pollution or contamination; purchasers must make their own enquiries. The property is sold subject to all existing wayleaves, easements, and rights of way (public or private), whether mentioned or not. Vendors are not required to define such rights.