



Connells

Arden Way
MARKET HARBOURGH



Property Description

Connells is pleased to offer this three bedroom semi detached house with off road parking and garage.

Conveniently located within walking distance to Ridgeway Primary Academy with Robert Smyth Academy also within very close walking distance, making the property an ideal family home prospect. With open views over parkland to the rear, this is a unique property that must be viewed to be appreciated.

With Market Harborough town centre within walking distance, transports links to London, excellent shopping, bars and restaurants are within easy reach.

Entrance Hall

A highly practical good-sized entrance hall. Connecting the front and rear of the property, this room offer access to the home plus is an ideal location for freezer, bikes, wellies etc.

Cloakroom

Separate to the bathroom with wc and wall-mounted sink.

Lounge

Beautifully light room with twin windows overlooking the front of the property. Living flame feature fireplace with slate surround,

wooden flooring and understairs cupboard.

Kitchen

Contemporary base and wall units with stylish complementary tiled backsplash and contrasting granite-effect worksurface, wooden laminate flooring, extractor hood, space for oven/hob, washing machine and under counter freezer. Space for cafe-style dining area.

Bathroom

Bath with shower above, sink with vanity.

First Floor Landing

Access hatch to loft (?), storage cupboard housing boiler.

Bedroom 1

Overlooking the front of the proeprty, bright and airy double bedroom.

Bedroom 2

Double bedroom with views overlooking the open park area to the rear.

Bedroom 3

Additional bedroom to the rear.

Outside

The property is situated in a highly desirable town centre location but is surrounded by open spaces to the front and rear that gives this property a unique and peaceful feel. The good-sized front garden is laid mainly to lawn while the rear garden has a patio area, large lawn, space for two sheds and provides access to the garage that can be accessed from an off-street lane that also provides additional parking space.









Ground Floor

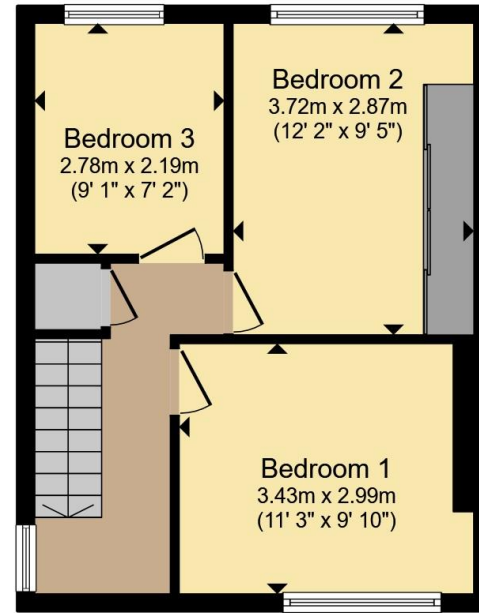

First Floor

Total floor area 85.1 m² (916 sq.ft.) approx

This floor plan is for illustrative purposes only. It is not drawn to scale. Any measurements, floor areas (including any total floor area), openings and orientation are approximate. No details are guaranteed, they cannot be relied upon for any purpose and they do not form part of any agreement. No liability is taken for any error, omission or misstatement. A party must rely upon its own inspection(s). Powered by www.propertybox.io



To view this property please contact Connells on

T 01858 465 921

E marketharborough@connells.co.uk

11 St. Marys Road
MARKET HARBOROUGH LE16 7DS

EPC Rating: D Council Tax
Band: C

Tenure: Freehold

view this property online connells.co.uk/Property/MKH308288



1. MONEY LAUNDERING REGULATIONS Intending purchasers will be asked to produce identification documentation at a later stage and we would ask for your co-operation in order that there will be no delay in agreeing the sale. 2. These particulars do not constitute part or all of an offer or contract. 3. The measurements indicated are supplied for guidance only and as such must be considered incorrect. Potential buyers are advised to recheck measurements before committing to any expense. 4. We have not tested any apparatus, equipment, fixtures, fittings or services and it is in the buyers interest to check the working condition of any appliances.

Connells Residential is registered in England and Wales under company number 1489613, Registered Office is Cumbria House, 16-20 Hockliffe Street, Leighton Buzzard, Bedfordshire, LU7 1GN. VAT Registration Number is 500 2481 05.

See all our properties at www.connells.co.uk | www.rightmove.co.uk | www.zoopla.co.uk

Property Ref: MKH308288 - 0008