



Banister Road, W10

£450,000

A modern and spacious one bedroom flat benefiting from a private balcony and access to a communal roof garden. The property features wooden flooring, good storage throughout, lift access, a secure bike store, and convenient access to the Moberly Sports Centre.

Prime House is ideally located close to the shops, cafés and restaurants of Chamberlayne Road and Salusbury Road, with Portobello Road and Notting Hill also within easy reach. Transport links include Kensal Rise (Overground), Kensal Green and Queen's Park (Bakerloo line and Overground), providing excellent access into Central London.

Features

- One Bedroom
- Modern Build
- Excellent Condition
- Lift Access
- Private Balcony
- Chain Free

Banister Road, London, W10

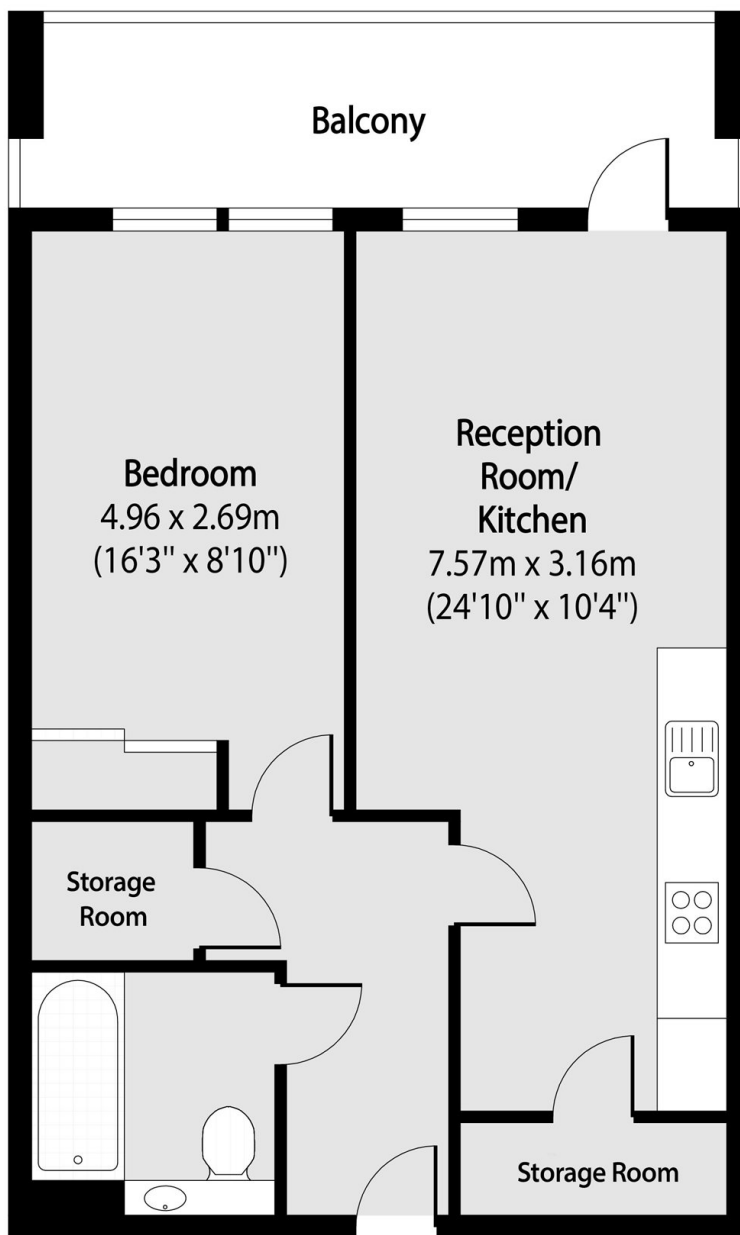

Total area (approx): 50.76 sq m (546 sq. ft)

Balcony total area (approx): 9.52 sq m (102 sq. ft)