



Chestnut Court Yardley Wood Road, Birmingham B14 4BL

welcome to

Chestnut Court Yardley Wood Road, Birmingham

A well-presented two-bedroom first floor apartment located in the popular Chestnut Court development on Yardley Wood Road, Birmingham. The property has been modernised throughout and offers a spacious open-plan kitchen and living area, two bedrooms, and a modern bathroom.

Agent Note

This property is council tax band B.

Lounge

20' 11" x 14' 5" (6.38m x 4.39m)

Juliet Balcony to car park, laminate flooring.

Kitchen

Integrated fridge freezer & washer dryer, breakfast bar, sink, electric hob & oven.

Bedroom 1

17' 1" x 9' 6" (5.21m x 2.90m)

Window to carpark, built in wardrobes, carpet, electric heater.

Bedroom 2

11' x 8' (3.35m x 2.44m)

Window to carpark, carpet, electric heater.

Bathroom

Bath with shower over, wash hand basin, low level flush w/c, towel rail.





view this property online shipways.co.uk/Property/SLY112328



welcome to

Chestnut Court Yardley Wood Road, Birmingham

- FIRST FLOOR
- TWO BEDROOMS
- OPEN KITCHEN/LOUNGE
- MODERN BATHROOM
- SECURE PARKING

Tenure: Leasehold EPC Rating: C

Council Tax Band: B Service Charge: 2600.00

Ground Rent: 160.00

This is a Leasehold property with details as follows; Term of Lease 999 years from 01 Jan 2002. Should you require further information please contact the branch. Please Note additional fees could be incurred for items such as Leasehold packs.

offers in the region of

£160,000

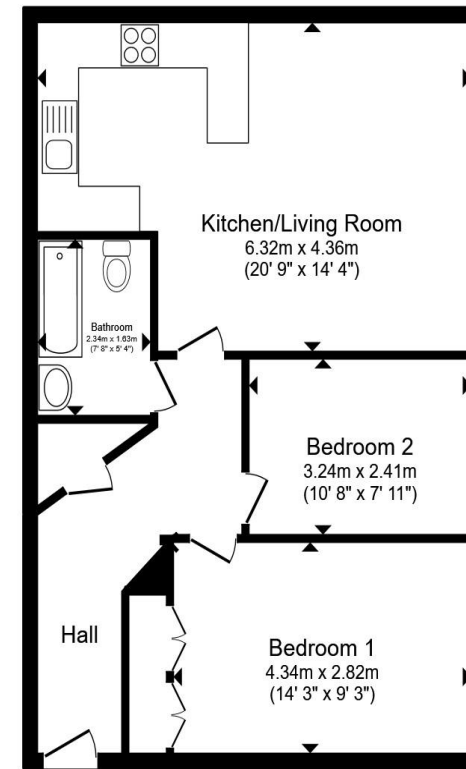

Total floor area 61.2 m² (659 sq.ft.) approx

This floor plan is for illustrative purposes only. It is not drawn to scale. Any measurements, floor areas (including any total floor area), openings and orientation are approximate. No details are guaranteed, they cannot be relied upon for any purpose and they do not form part of any agreement. No liability is taken for any error, omission or misstatement. A party must rely upon its own inspection(s). Powered by www.propertybox.io



view this property online shipways.co.uk/Property/SLY112328



Property Ref:
SLY112328 - 0006

1. MONEY LAUNDERING REGULATIONS Intending purchasers will be asked to produce identification documentation at a later stage and we would ask for your co-operation in order that there is no delay in agreeing the sale. 2. These particulars do not constitute part or all of an offer or contract. 3. The measurements indicated are supplied for guidance only and as such must be considered incorrect. Potential buyers are advised to recheck measurements before committing to any expense. 4. We have not tested any apparatus, equipment, fixtures or services and it is in the buyers interest to check the working condition of any appliances. 5. Where an EPC, or a Home Report (Scotland only) is held for this property, it is available for inspection at the branch by appointment. If you require a printed version of a Home Report, you will need to pay a reasonable production charge reflecting printing and other costs. 6. We are not able to offer an opinion either written or verbal on the content of these reports and this must be obtained from your legal representative. 7. Whilst we take care in preparing these reports, a buyer should ensure that his/her legal representative confirms as soon as possible all matters relating to title including the extent and boundaries of the property and other important matters before exchange of contracts.



0121 744 4595



shirley@shipways.co.uk



208 Stratford Road, Shirley, SOLIHULL, West Midlands, B90 3AG



shipways.co.uk

