



8 Suffolk Court, Vicarage Road, Maidenhead SL6 7DT

welcome to

8 Suffolk Court, Vicarage Road, Maidenhead

An excellent opportunity to acquire a two-bedroom ground floor maisonette with fantastic potential, ideal for buyers looking to modernise and add value. The property offers a well-proportioned layout, including a spacious living area with plenty of natural light, a separate kitchen, and two comfortable bedrooms. While in need of updating throughout, the home provides a solid foundation for refurbishment, allowing purchasers to create a space tailored to their own style and requirements. A standout feature is the private garden, offering a rare and highly desirable outdoor space-perfect for relaxing, entertaining, or further landscaping potential. The property further benefits from a garage to the rear of the property. Situated in a convenient residential location in Maidenhead, the property is within easy reach of local amenities, transport links, and the town centre, making it an attractive prospect for first-time buyers, investors, or those seeking a project. Offered with no onward chain, this is a superb opportunity to secure a property with scope for improvement in a popular area. Early viewing is strongly recommended. **Property is offered for sale through Modern Auction which is operated by iamsold Limited.**





Vicarage Road, Maidenhead, SL6

Approximate Area = 731 sq ft / 67.9 sq m

For identification only - Not to scale

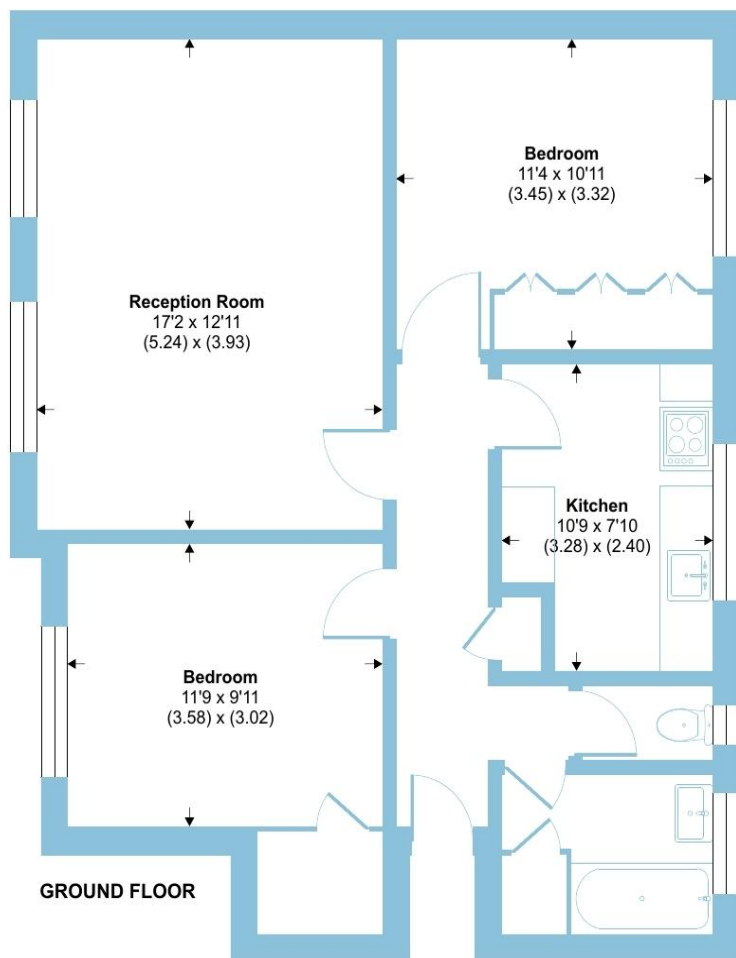

Auctioneer's Comments

This property is offered through Modern Method of Auction. Should you view, offer or bid your data will be shared with the Auctioneer, iamsold Limited. This method requires both parties to complete the transaction within 56 days, allowing buyers to proceed with mortgage finance (subject to lending criteria, affordability and survey). The buyer is required to sign a reservation agreement and make payment of a non-refundable Reservation Fee of 4.5% of the purchase price including VAT, subject to a minimum of £6600.00 including VAT. This fee is paid in addition to purchase price and will be considered as part of the chargeable consideration for the property in the calculation for stamp duty liability. Buyers will be required to complete an identification process with iamsold and provide proof of how the purchase would be funded. The property has a Buyer Information Pack containing documents about the property. The documents may not tell you everything you need to know, so you must complete your own due diligence before bidding. A sample of the Reservation Agreement and terms and conditions are contained within this pack. The buyer will also make payment of no more than £349 inc. VAT towards the preparation cost of the pack. Please confirm exact costs with the auctioneer. The estate agent and auctioneer may recommend the services of other providers to you, in which they will be paid for the referral. These services are optional, and you will be advised of any payment, in writing before any services are accepted. Listing is subject to a start price and undisclosed reserve price that can change.

welcome to

8 Suffolk Court, Vicarage Road

- Sale by Modern Auction (T&Cs apply)
- Subject to an undisclosed Reserve Price
- Buyers fees apply
- NO ONWARD CHAIN
- WELL-PROPORTIONED LAYOUT
- SEPARATE GARAGE
- TWO BEDROOMS
- SEPARATE KITCHEN
- PRIVATE GARDEN

Tenure: Leasehold EPC Rating: E

Council Tax Band: C Service Charge: Ask Agent

Ground Rent: Ask Agent

This is a Leasehold property. We are awaiting further details about the Term of the lease. For further information please contact the branch. Please note additional fees could be incurred for items such as Leasehold packs.

guide price

£135,000



Please note the marker reflects the postcode not the actual property

check out more properties at rogerplatt.co.uk



Property Ref:
MHD123624 - 0002

1. MONEY LAUNDERING REGULATIONS Intending purchasers will be asked to produce identification documentation at a later stage and we would ask for your co-operation in order that there is no delay in agreeing the sale. 2. These particulars do not constitute part or all of an offer or contract. 3. The measurements indicated are supplied for guidance only and as such must be considered incorrect. Potential buyers are advised to recheck measurements before committing to any expense. 4. We have not tested any apparatus, equipment, fixtures or services and it is in the buyers interest to check the working condition of any appliances. 5. Where an EPC, or a Home Report (Scotland only) is held for this property, it is available for inspection at the branch by appointment. If you require a printed version of a Home Report, you will need to pay a reasonable production charge reflecting printing and other costs. 6. We are not able to offer an opinion either written or verbal on the content of these reports and this must be obtained from your legal representative. 7. Whilst we take care in preparing these reports, a buyer should ensure that his/her legal representative confirms as soon as possible all matters relating to title including the extent and boundaries of the property and other important matters before exchange of contracts.

Roger Platt is a trading name of Sequence (UK) Limited which is registered in England and Wales under company number 4268443, Registered Office is Cumbria House, 16-20 Hockliffe Street, Leighton Buzzard, Bedfordshire, LU7 1GN. VAT Registration Number is 500 2481 05.

roger platt



01628 773333



Maidenhead@rogerplatt.co.uk



25-29 Queen Street, MAIDENHEAD, Berkshire,
SL6 1NB



rogerplatt.co.uk