



**For Sale**

**34 Chandley Way, Warwick**

**£180,000**

 **2**

 **1**

 **2**

**\*\*\* TOP FLOOR APARTMENT IN POPULAR LOCATION & OFFERED FOR SALE WITH NO ONWARD CHAIN \*\*\***

... TOP FLOOR APARTMENT IN POPULAR LOCATION & OFFERED FOR SALE WITH NO ONWARD CHAIN ...

This spacious and modern top floor apartment is well presented and ready to move straight into.

It is ideal for first time buyers, buy to let investors or somebody looking to stay in Warwick and downsize.

The property is positioned close to the M40, Warwick and Leamington Spa Town centres and just over 1 mile to Warwick Parkway train station.

The property comprises in brief of; secure communal entrance hall, hallway, lounge / dining area and kitchen just off it. There are two double bedrooms, the master benefiting from en suite shower facilities and there is also a white modern bathroom along with large storage cupboard off the hallway.

The apartment also benefits from double glazing and an allocated parking space. The property

**Nathaniel Cleaver**

07793 363210

nathaniel@thepropertyexperts.co.uk



**The Property Experts UK**

01926436105



- Top Floor Apartment
- Two Double Bedrooms
- Bathroom & En Suite To Master
- Allocated Parking Space
- Close To Local amenities & Transport Links
- Open Plan Lounge / Kitchen / Dining Area
- Ideal First Time Or Investment Buy
- No Onward Chain
- EPC rating - C



Total Living Area 62.10 square metres / 668 square feet

### Third Floor

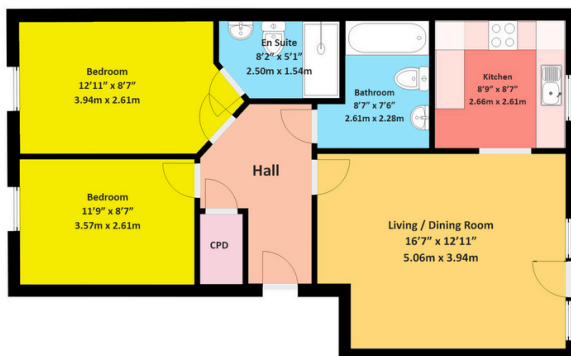

THIS FLOORPLAN IS PROVIDED WITHOUT WARRANTY OF ANY KIND. THE PUBLISHER DISCLAIMS ANY WARRANTY INCLUDING, WITHOUT LIMITATION, SATISFACTORY QUALITY OR ACCURACY OF DIMENSIONS

