



2b Farm Field Devereux Drive

Watford, WD17 3DD

£1,850,000

Welcome to Farm Field, a unique property that draws inspiration from the nearby Sugden House, a masterpiece designed by the renowned architect duo Alison & Peter Smithson. This influence is evident in Farm Fields' contemporary modernist architecture, setting it apart as a truly exceptional home.

- Brand New Build
- Detached Family Home
- Stylish And Desirable
- Four Double Bedrooms
- Master Suite inc Dressing Room & Bathroom
- Spacious Contemporary Kitchen
- Luxurious Finish Throughout
- Over 3000 Sq ft
- Three Bathrooms
- Only Private Road In Cassiobury

Viewing

Please contact our Abbots Langley Office on 01923262666 if you wish to arrange a viewing appointment for this property or require further information.



4



3



3



B

Floor Plan

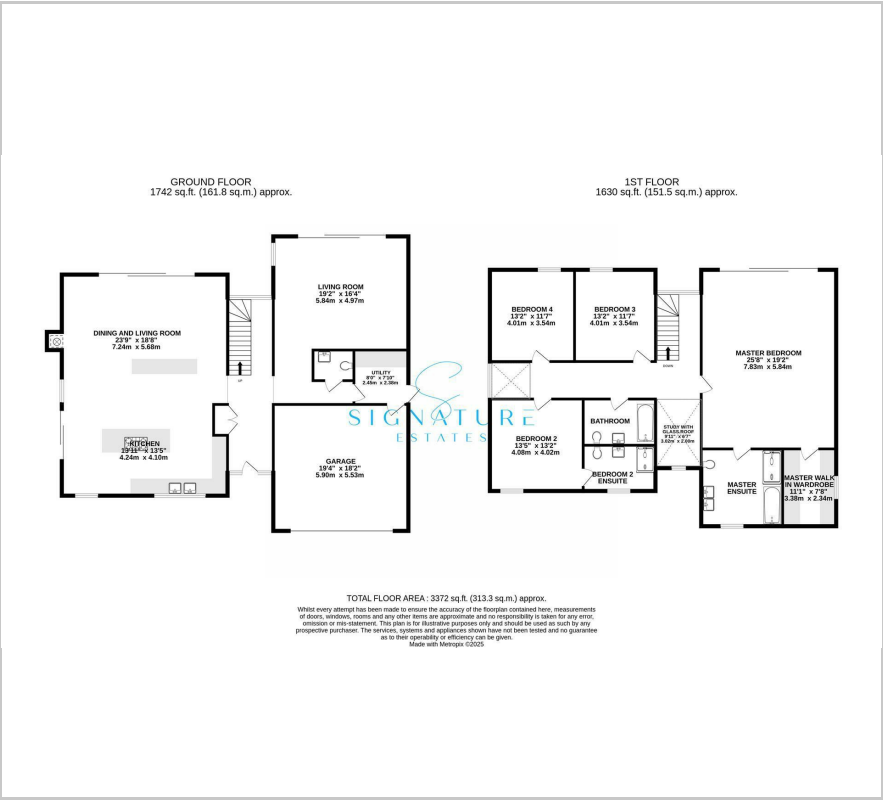

Area Map



Energy Efficiency Graph

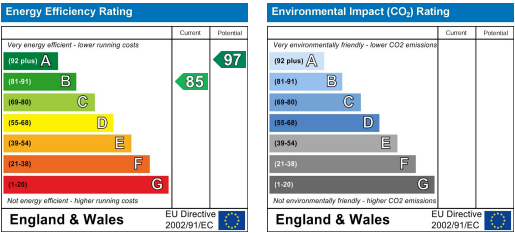

These particulars, whilst believed to be accurate are set out as a general outline only for guidance and do not constitute any part of an offer or contract. Intending purchasers should not rely on them as statements of representation of fact, but must satisfy themselves by inspection or otherwise as to their accuracy. No person in this firms employment has the authority to make or give any representation or warranty in respect of the property.