



12 Brookwell Close, Chippenham, SN15 1PJ

£475,000

Located on the North Western outskirts of Chippenham, situated in a sought after cul de sac, a three / four bedroom chalet style detached bungalow. The property is within easy reach of the Town Centre with main line railway serving London Paddington, also access to the M4 motorway Jct. 17. To the rear there is an enclosed garden laid mainly to lawn, to the front there is a further area of garden and driveway providing off road parking and access to the single garage. NO ONWARD CHAIN.

Entrance Hallway

Front door leads into hallway, built in cupboard, radiator, door to inner lobby with gas boiler, further door into garage.

Living Room 14'01" x 11'10" (4.29m x 3.61m)



Double glazed window, radiator.

Dining Room 11'10" x 8'09" (3.61m x 2.67m)



Double glazed window, radiator.

Study Area 9'08" x 8'07" (2.95m x 2.62m)



Double glazed window, radiator, stair case.

Fitted Kitchen / Breakfast 15'06" x 10'10" (4.72m x 3.30m)



Modern Fitted kitchen with dual aspect double glazed windows to rear and side, work tops with a range of cupboards and drawers, inset sink unit, space for cooker, cooker hood, plumbing and space for washing machine, space for fridge/freezer, two radiators, side door to garden.



Bedroom Four / Reception Room 12'11" x 11'11" (3.94m x 3.63m)



Double glazed window, radiator.

Bedroom One 13'0" x 10'09" (3.96m x 3.28m)



Double glazed window, radiator, built in cupboards.

Bathroom



Double glazed window, panelled bath with mixer / spray shower, hand basin, W.C. radiator.

Bedroom Two 10'06" x 10'09" (3.20m x 3.28m)



Double glazed window, radiator, built in cupboards.

Landing

Doors to bedrooms and W.C.

Bedroom Three



Double glazed window, radiator.

W.C.

W.C, hand basin.

Outside

Rear



Enclosed garden laid mainly to lawn with flower beds and borders, side access to the front, personal door into garage, outside power point.

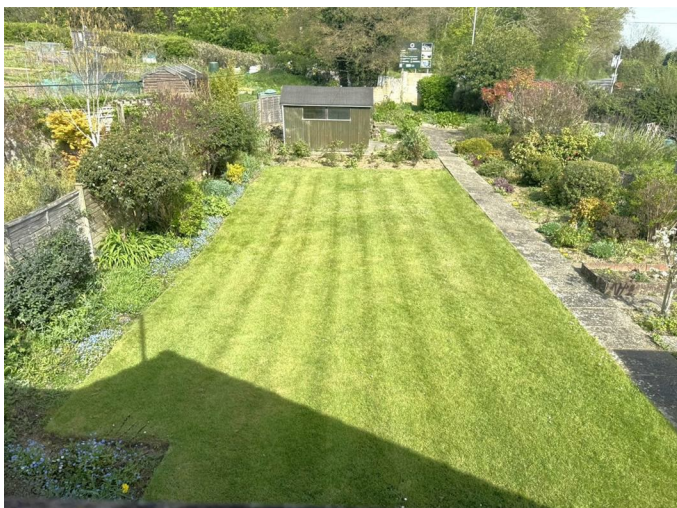

Front



Lawn and driveway flower borders.

**Garage & Driveway 22'02" x 10.0 max
(6.76m x 3.05m.0.00m max)**



Garage with electric up and over door, double glazed window, door to side. Driveway providing off road parking.

Tenure

GOV.UK advise Freehold.

Council Tax band

GOV.UK advise Band E.

Floor Plan

GROUND FLOOR

1ST FLOOR

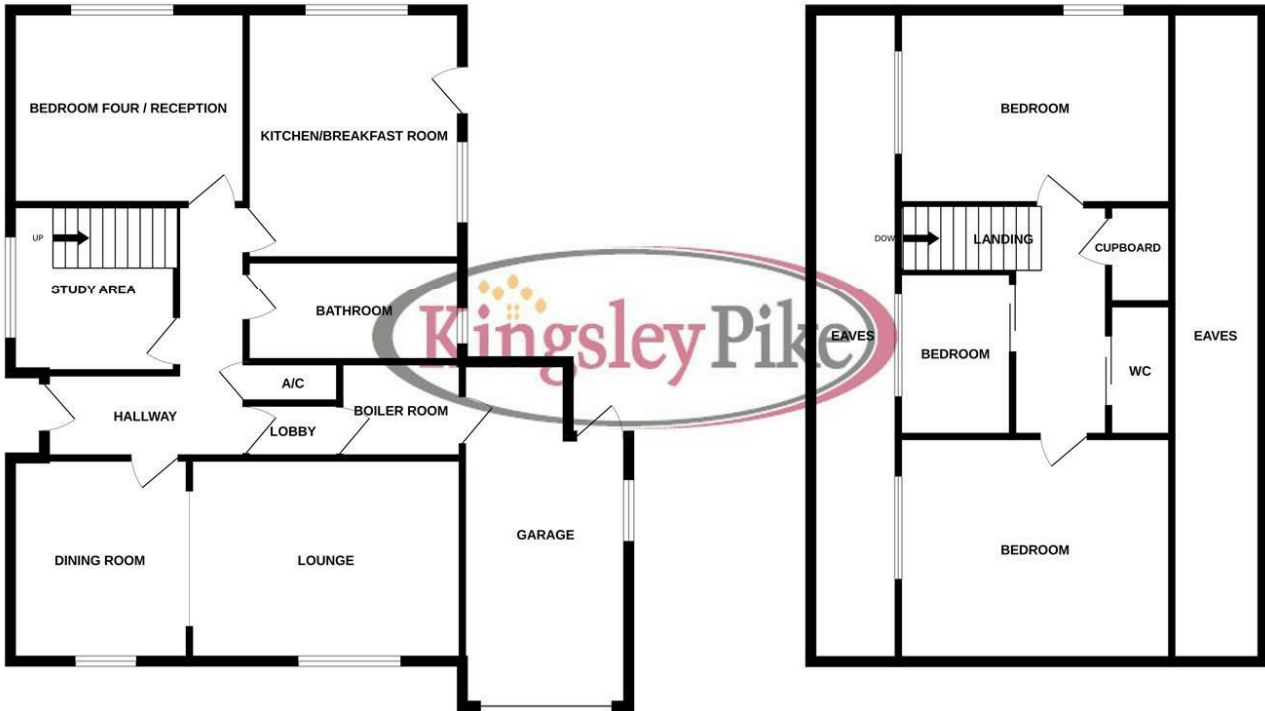

Whilst every attempt has been made to ensure the accuracy of the floorplan contained here, measurements of doors, windows, rooms and any other items are approximate and no responsibility is taken for any error, omission or mis-statement. This plan is for illustrative purposes only and should be used as such by any prospective purchaser. The services, systems and appliances shown have not been tested and no guarantee as to their operability or efficiency can be given. Made with Metropix ©2025

Area Map

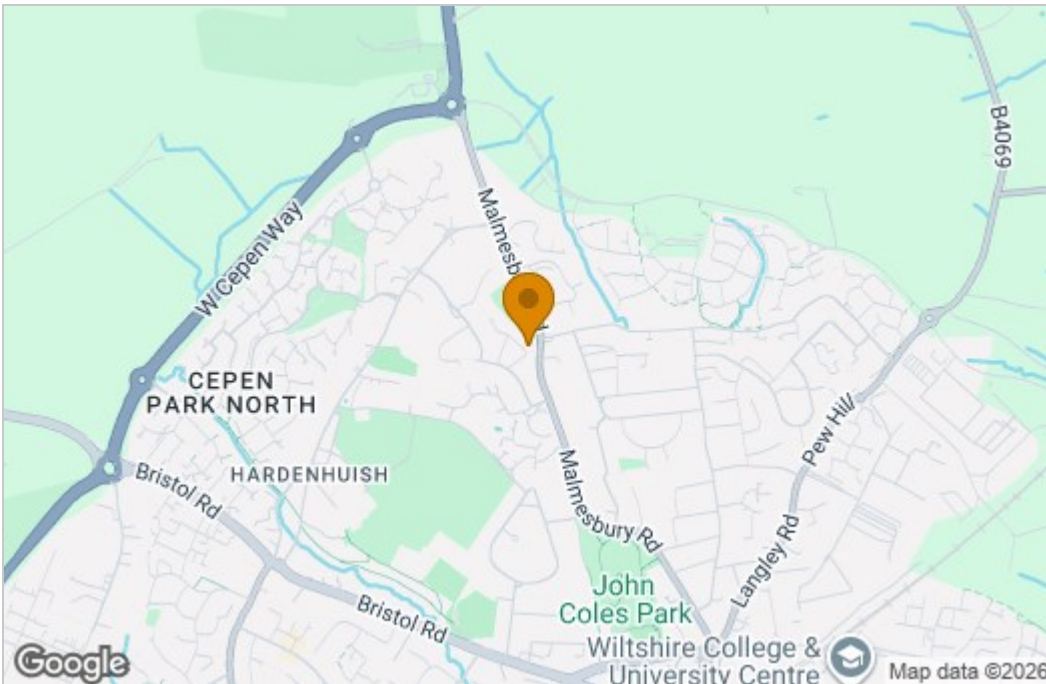

Energy Efficiency Graph

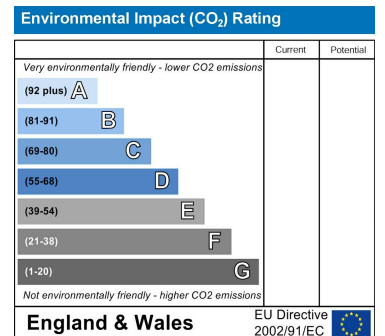
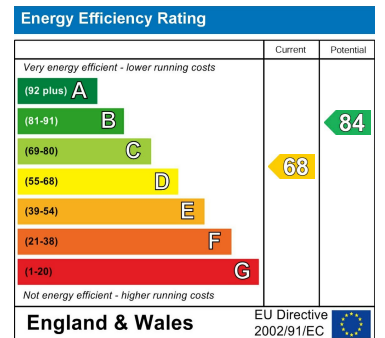

These particulars, whilst believed to be accurate are set out as a general outline only for guidance and do not constitute any part of an offer or contract. Intending purchasers should not rely on them as statements of representation of fact, but must satisfy themselves by inspection or otherwise as to their accuracy. No person in this firm's employment has the authority to make or give any representation or warranty in respect of the property.