

## Little Somerset Street, E1

**£1,900** Per calendar month

A well presented one bedroom apartment located in the heart of Aldgate. This purpose built property has a spacious open plan reception, double bedroom, wood floors and a modern feel throughout.

Located across the road from Aldgate Station and within easy reach of Brick Lane, Shoreditch, Bank and Liverpool street making this the perfect central location for access to the City.

### Features

- One Double Bedroom
- Great Location
- Open Plan Reception
- Wood Floors
- Modern Finish Throughout
- Unfurnished

# Little Somerset Street, London, E1

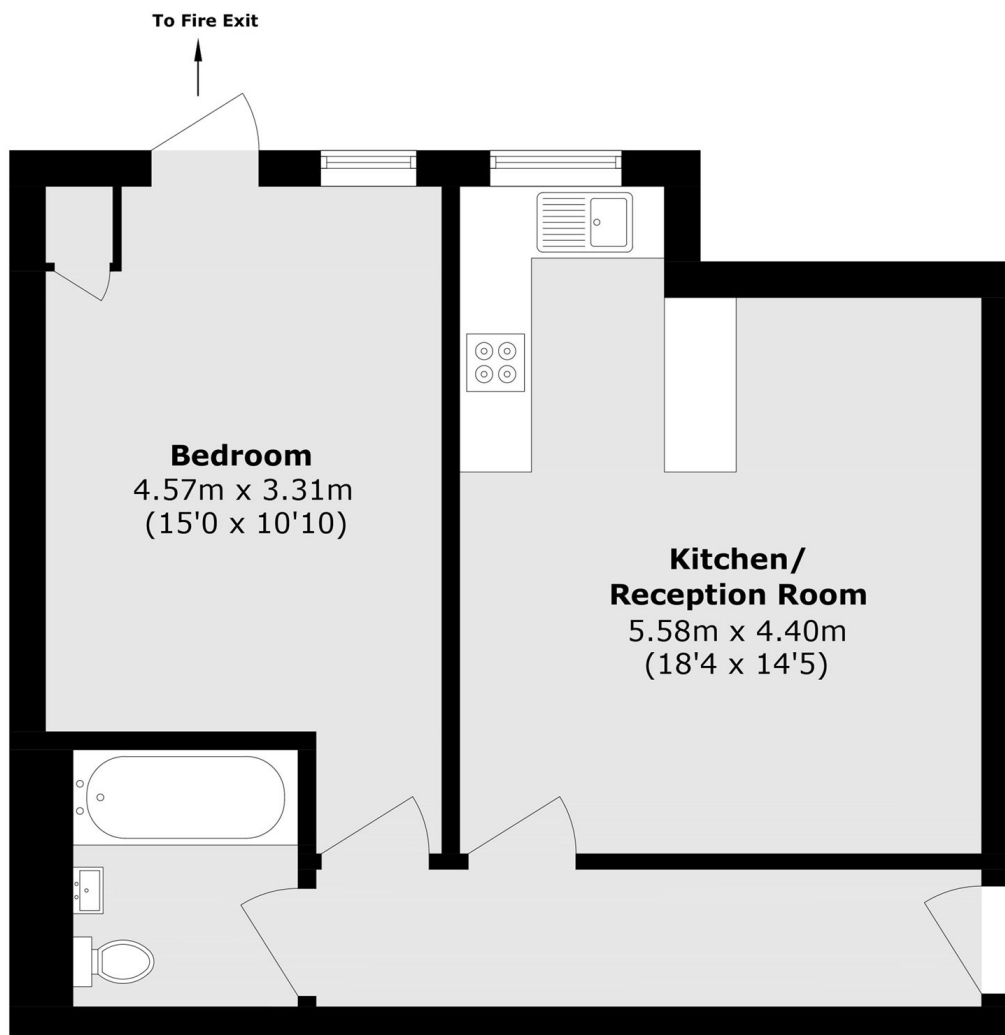

Total area (approx.): 51.1 sq. m (550.0 sq. ft)