



Woodland Way, CR4

£600,000

A charming mid terrace freehold home with superb character throughout furnished with a double reception room and spacious kitchen over the ground floor. The property benefits from three bedrooms and a family bathroom over the first floor with a generous rear garden with great scope for extending (STPP).

Woodland Way is a quiet residential road conveniently located for the many shops, bars and restaurants of central Tooting with the excellent transport links of Tooting Railway within walking distance and Tooting Broadway Underground stations also nearby.

Features

- Three Bedrooms
- Generous Garden
- Double Reception Room
- Period Features
- Potential to Extend (STPP)
- Quiet Location

Woodland Way, Mitcham, CR4

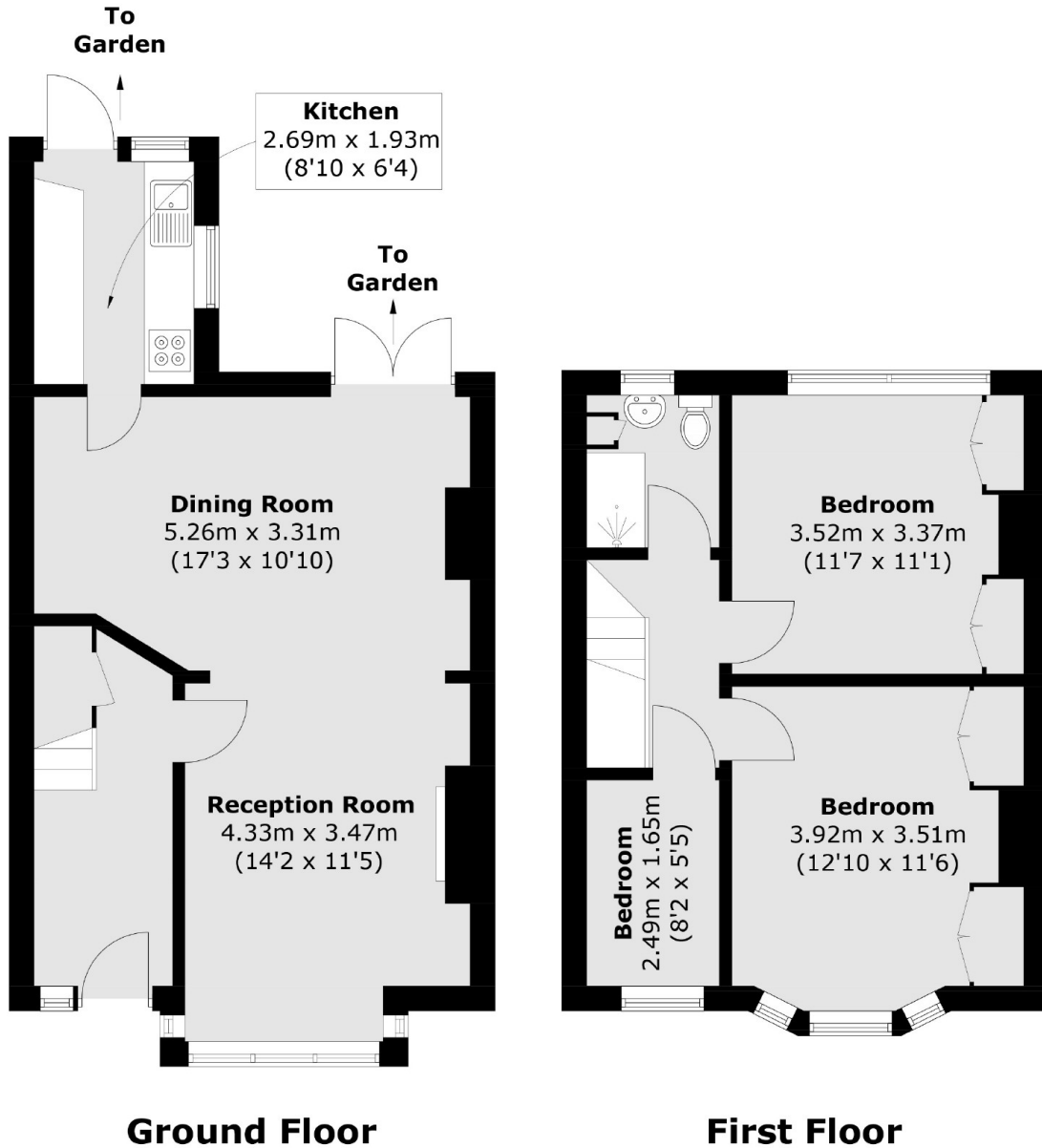

Total area (approx.): 83.2 sq. m (895.5 sq. ft)