

Western Terrace

The Park
Nottingham
NG7 1AF

Asking Price Of £349,000



Click for further information:-



Location



Gallery



Video



Contact



0115 841 1155



- Exceptional duplex apartment arranged over two spacious floors
- Located on the edge of the prestigious private estate, The Park
- Open-plan living area with striking exposed beams, combining character and modern design
- Contemporary kitchen fitted with integrated appliances
- Additional enclosed balcony accessible from the main living space
- Two generously sized bedrooms on the lower level, both with stylish en-suites and ample natural light
- Spacious master bedroom on the upper floor with en-suite and access to an enclosed balcony
- Stylish family bathroom completing the upper floor layout
- EPC Rating C / Council Tax Band F
- Internal Area Approx.1685 sq ft/Viewing Highly Recommended



0115 841 1155



Location



Gallery



Video



Contact

Western Terrace, [The Park, Nottingham, NG7 1AF](#)

Key Features

FHP Living is delighted to present this exceptional duplex apartment, arranged over two thoughtfully designed floors and located on the edge of the highly sought-after private estate, The Park. This impressive residence offers a unique blend of character, comfort, and contemporary living—an experience that must be seen in person to be fully appreciated.

Accessed via a communal entrance hall, the property's private entrance leads to the first level, where you'll find two generously sized bedrooms. Both feature sleek en-suite bathrooms and benefit from ample natural light through large windows, creating bright and inviting spaces.

The upper floor hosts a beautifully proportioned master bedroom with an adjacent en-suite and access to a private enclosed balcony—perfect for quiet relaxation. The open-plan living area is a standout feature, showcasing striking exposed beams, a modern kitchen fitted with integrated appliances, and access to a second enclosed balcony. This stylish and functional layout offers an ideal setting for both entertaining guests and enjoying day-to-day living. A contemporary family bathroom is also located on this level, completing the apartment's well-considered interior.





0115 841 1155



Location



Gallery



Video



Contact

Western Terrace, [The Park, Nottingham, NG7 1AF](#)

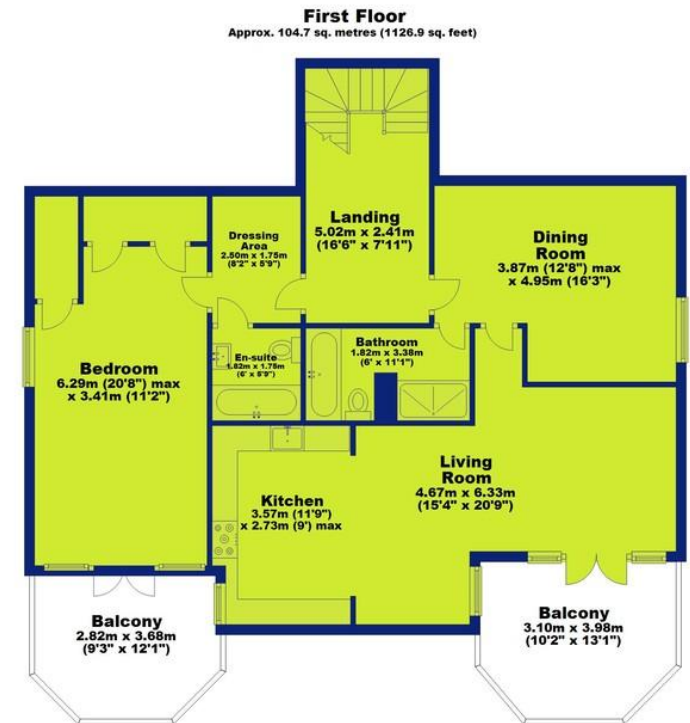
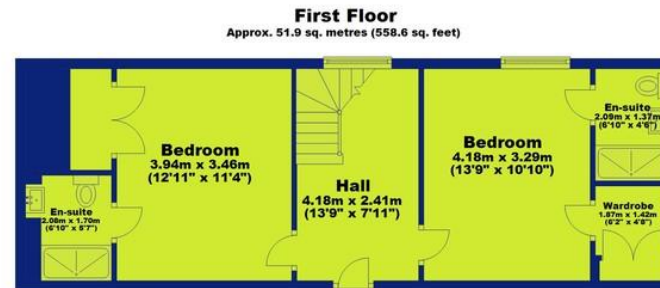

Total area: approx. 156.6 sq. metres (1685.5 sq. feet)



0115 841 1155



Location



Gallery



Video



Contact

Western Terrace, [The Park, Nottingham, NG7 1AF](#)



Interested in this home?

Contact the FHP Living Team on 0115 841 1155

23 Bridgford Road
West Bridgford
Nottingham
NG2 6AU

1 Weekday Cross
The Lace Market
Nottingham
NG1 2GB

Score	Energy rating	Current	Potential
92+	A		
81-91	B		81 B
69-80	C	69 C	
55-68	D		
39-54	E		
21-38	F		
1-20	G		

These sales particulars have been prepared by FHP Living on the instruction of the vendor. Services, equipment and fittings mentioned in these particulars have NOT been tested, and as such, no warranties can be given. Prospective purchasers are advised to make their own enquiries regarding such matters. These sales particulars are produced in good faith and are not intended to form part of a contract. Whilst FHP Living have taken care in obtaining internal measurements, they should only be regarded as approximate.

Purchaser information - Under the Protecting Against Money Laundering and the Proceeds of Crime Act 2002, FHP Living require any successful purchasers proceeding with a purchase to provide two forms of identification i.e. passport or photocard driving license and a recent utility bill. This evidence will be required prior to FHP Living instructing solicitors in the purchase or the sale of a property.