



Apt 2 New Mill Salts Mill Road, Shipley

In Excess of £100,000

Apartment 2 New Mill Salts Mill Road

Shipley, Shipley

Charming 1 bed flat in historic mill conversion. Industrial charm meets modern comfort. Open plan living with exposed brickwork. Modern kitchen, ideal for investors or first-time buyers. On-site tennis court. Shipley location near train station. Includes car parking. Peaceful retreat in thriving community. Ideal mix of old-world charm and contemporary living. Explore this unique property today!
Council Tax band: B

Tenure: Leasehold

EPC Energy Efficiency Rating: C

EPC Environmental Impact Rating: C

- Open plan living area
- Modern kitchen
- Exposed brickwork
- Large windows with natural light
- Historic Mill Conversion
- Tennis court on site
- Ideal Investment or First Time Buyer
- Car Parking Space included (on separate time)
- Private Entrance



Approx Gross Internal Area
48 sq m / 515 sq ft

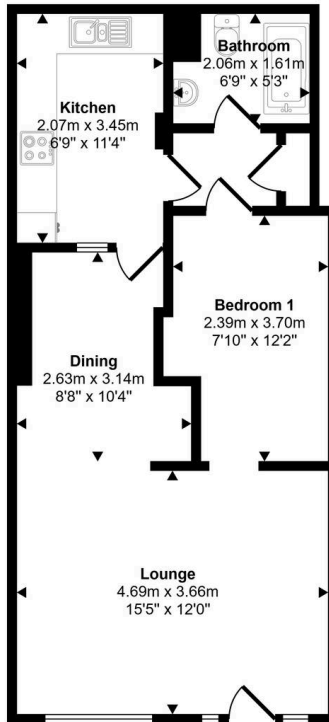

Floorplan

Whilst every attempt has been made to ensure the accuracy of the floor plan contained here, measurements of doors, windows, rooms and any other items are approximate and no responsibility is taken for any error, omission, or mis-statement. The measurements should not be relied upon for valuation, transaction and/or funding purposes. This plan is for illustrative purposes only and should be used as such by any prospective purchaser or tenant.



Aspire Estates

Aspire Properties, Wira Business Park Ring Road - LS16 6EB

0113 8875079

estatesales@aspirepropertygroup.co.uk

www.aspirepropertygroup.co.uk/