



## 12 North Pends

Kennington Ashford, TN24 9EE

Price £280,000

A very well appointed end of terrace house in a popular cul de sac position. Tastefully decorated, this charming home offers a modern kitchen and shower room, sitting room, utility and two double bedrooms. Gas central heating and double glazing are installed with the property also enjoying a very generous rear garden.

Several schools of good standing are in easy reach with Ashford town centre only 1.5 miles distance with its excellent commuter links.

**NO ONWARD CHAIN**

### Viewing

Please contact our Ashford Office on 01233 646411 if you wish to arrange a viewing appointment for this property or require further information.

- SPACIOUS END OF TERRACE HOME
- TWO DOUBLE BEDROOMS
- MODERN FITTED KITCHEN
- UTILITY ROOM
- GENEROUS REAR GARDEN
- CUL DE SAC POSITION
- GAS CENTRAL HEATING & DOUBLE GLAZING
- VERY WELL PRESENTED
- NO ONWARD CHAIN





Floor Plan

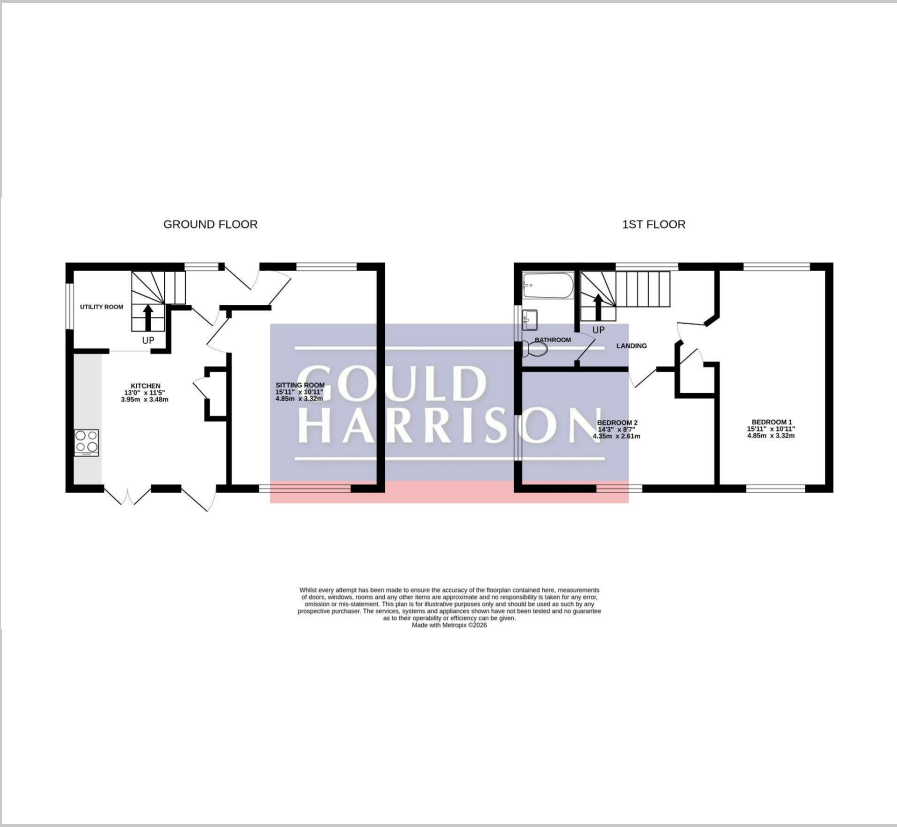

Area Map



Energy Efficiency Graph

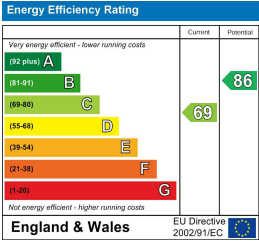

These particulars, whilst believed to be accurate are set out as a general outline only for guidance and do not constitute any part of an offer or contract. Intending purchasers should not rely on them as statements of representation of fact, but must satisfy themselves by inspection or otherwise as to their accuracy. No person in this firms employment has the authority to make or give any representation or warranty in respect of the property.