

Shepherds Hill, N6

£625,000

In a small purpose built block, this exceptional second floor apartment has an abundance of natural light, a delightful balcony overlooking the communal gardens and a share of the freehold.

In this highly sought after location, the property has views over Queens Wood towards Muswell Hill and is just a short walk to the excellent transport connections at Highgate underground station.

Features

- Two Bedrooms
- Modern Kitchen
- Reception Room
- Balcony With Views
- Garage
- Close to Transport

Shepherds Hill, London, N6

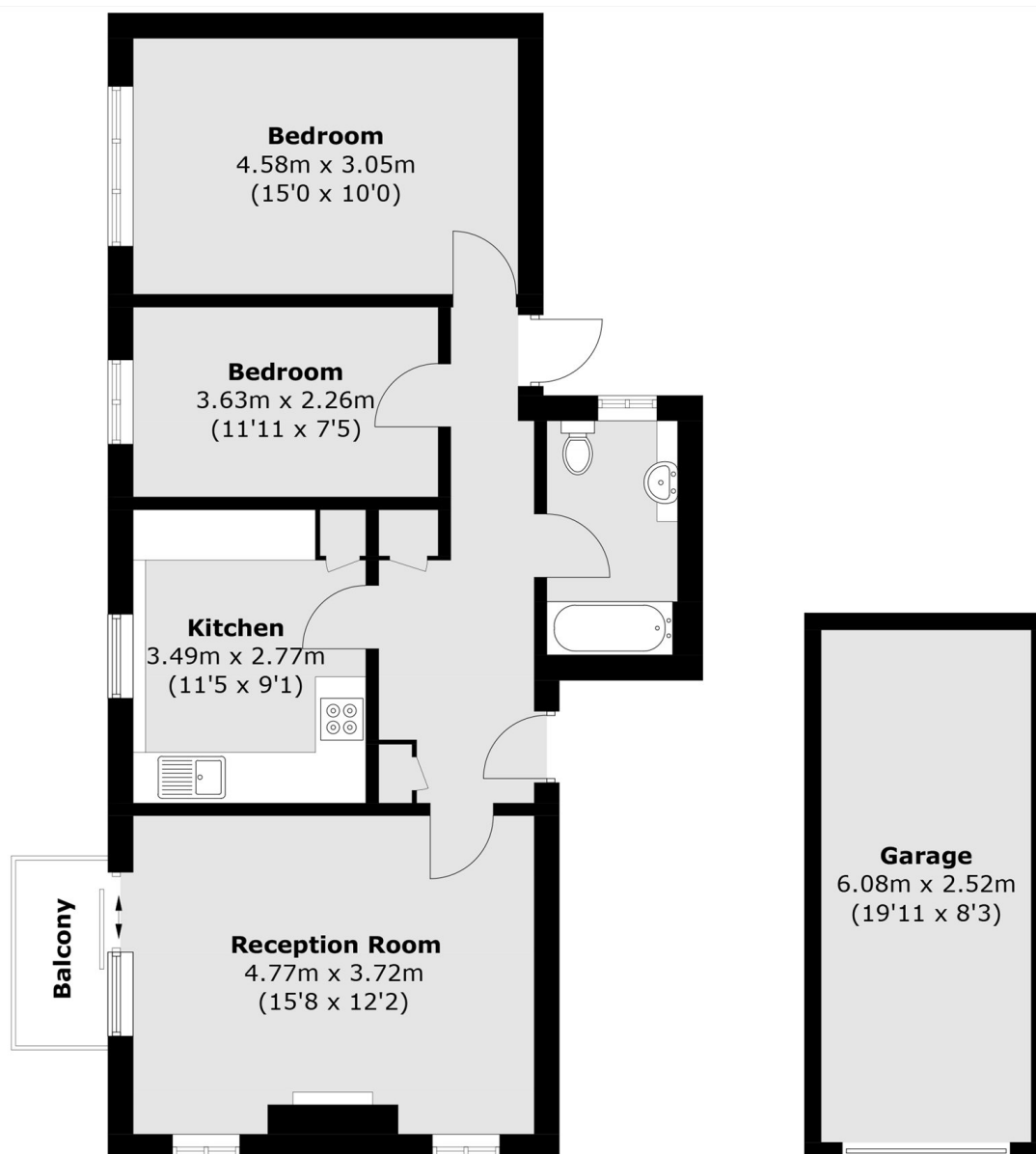

**(Not Shown In Actual
Location / Orientation)**

Total area (approx.): 66.5 sq. m (715.8 sq. ft)

Garage: 15.2 sq. m (163.6 sq. ft)

Balcony area: 2.4 sq. m (25.8 sq. ft)