



Price

£3,000 PCM

Fees Apply



Available 06/03/26

**Joy Lane Whitstable
CT5**

Wards
Helping you move forwards



Main Features

Spectacular 180 Degree Coastal Views

1 Bedroom self-contained apartment with the property

Wide 'In-Out' Driveway Secured With Gates

152' x 85' (46.14m x 26m) Rear Garden With Pool

Garage included

Just Over 1/3 Acre Plot, maintained by a gardener



Deposit required is £3,461.54

Canterbury District - Council Tax Band Tax Band F

Renting a property is a big commitment and we recommend that you visit the local authority website and these websites which offer helpful information and advice about letting

www.gov.uk/government/publications/how-to-rent

www.gov.uk/private-renting

www.wardsofkent.co.uk/renting/tenancy-fees-individuals/

www.gov.uk/green-deal-energy-saving-measures

Call Whitstable 01227 200691 ■ wardsofkent.co.uk

IMPORTANT INFORMATION: Please contact our Lettings Team who will confirm the total costs involved in renting this property. For clarification, we wish to inform the prospective tenant that we have prepared these details as a general guide. The agent has not carried out a detailed survey nor tested the services, appliances, or specific fittings (unless otherwise stated), and no warranty can be given as to their condition. All room measurements are taken at floor level. We strongly recommend that all the information which we provide about the property is verified by yourself and your advisers. The contents of this publication are © Wards, 2015. Wards is a trading name of Arun Estates Limited Registered in England No. 2597969

Accommodation

Enclosed Porch

Entrance Hall

Dining Room 3.54 x 3.28

Lounge 8.39 x 4.53

Family Room 6.71 x 2.44

Conservatory 4.91 x 2.88

Kitchen/Breakfast Room 4.68 x 3.28

Utility Room 1.53 x 1.22

Shower Room 2.16 x 1.83

Master Bedroom 5.03 x 3.64

En-Suite 2.6 x 1.33

Bedroom Two 4.07 x 2.72

Bedroom Three 3.28 x 3.21

Bathroom 2.37 x 2.06

Flat Lounge 3.66 x 6.18

Flat Kitchen 3.21 x 2.88

Bedroom 4.09 x 3.15

Flat Bathroom 1.81 x 2.88



Ground Floor
Approx. 202.8 sq. metres (2182.6 sq. feet)

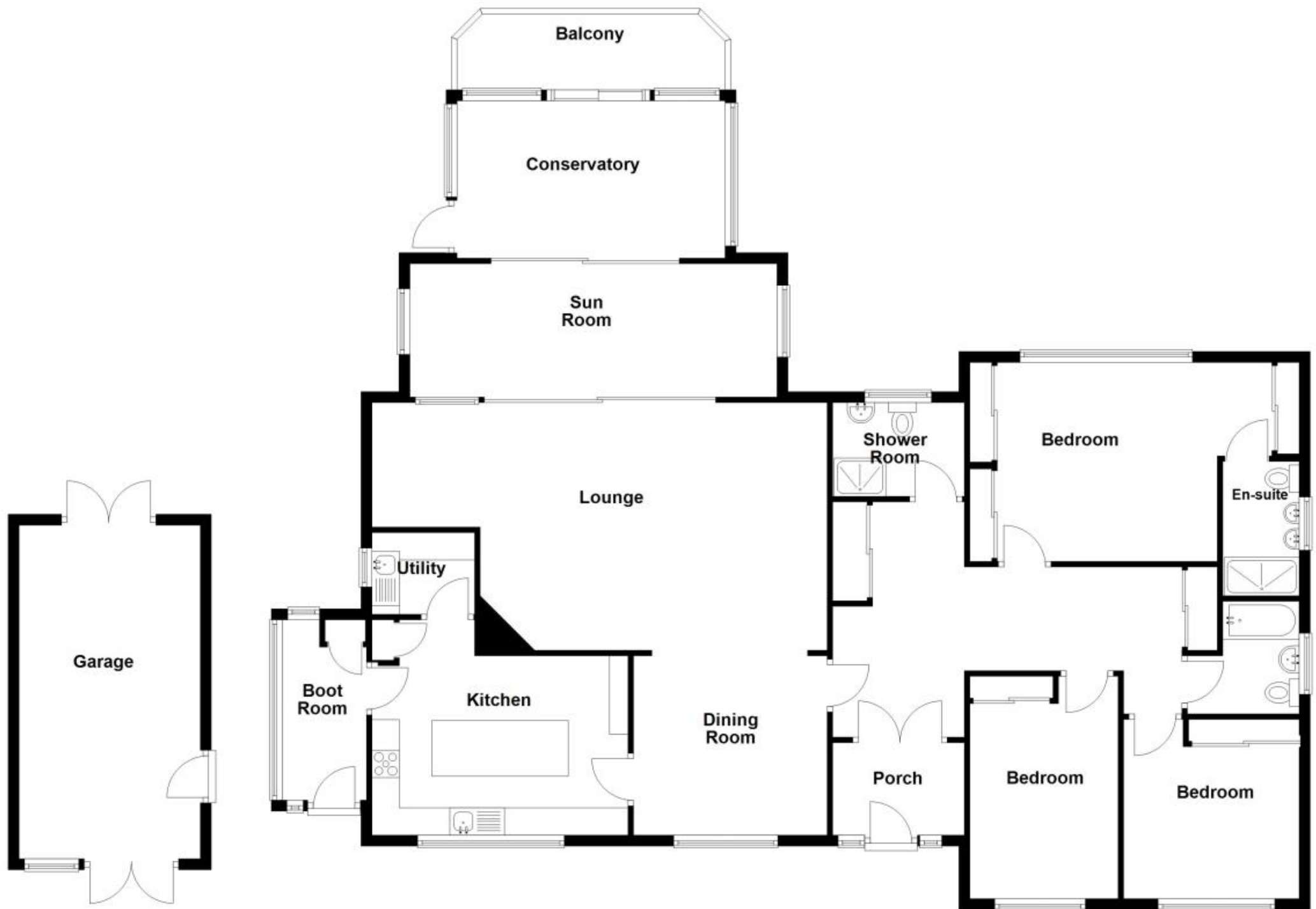

Total area: approx. 202.8 sq. metres (2182.6 sq. feet)